

LTD ED WHITEGUARD STRATOCASTER® (0176062707)

PARTS LAYOUT

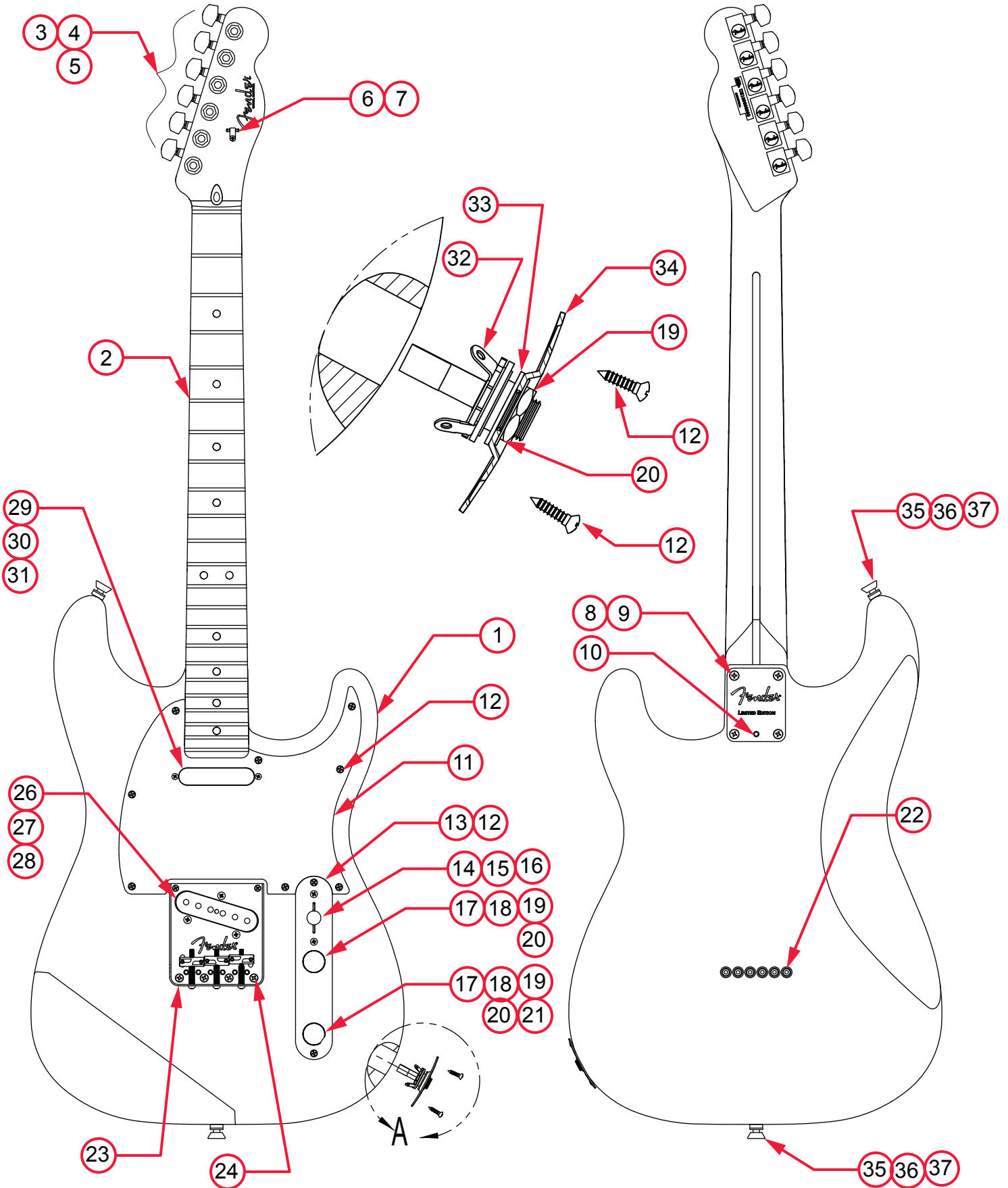

LTD ED WHITEGUARD STRATOCASTER® (0176062707)

PARTS LIST

REF#	DESCRIPTION	PART NUMBER
1	BODY LTD ED WHITEGUARD STRAT	7712116507
2	NECK ASSY LTD ED WHITEGUARD STRAT MPL	7712117000
3	KEYS GUITAR 2-PIN MTG SET 2-LONG 4-SHORT W/HARDWARE	0990820100
4	WASHER KEY	0053106049
5	BUSHING KEY	0058820049
6	STRING TREE W/HARDWARE	0994911000
7	SCREW SMAB 3 X 3/8 RHP STL NI	0011357049
8	NECK PLATE ALUM LTD ED W/TILT	7711588000
9	SCREW SMA 8 X 1-3/4 OHP NI	0015636049
10	SET SCREW 1/4-20 X 3/8 OP NI HEX	0031571000
11	PICKGUARD LTD ED WHITE GUARD STRAT W/B/W	7712188000
12	SCREW SMAB 4 X 1/2 OHP NI	0015578049
13	CONTROL PLATE TELE ALUM CHROME	0093823000
14	SWITCH 3 WAY LEVER W/MTL	0992041000
15	KNOB SWITCH VINT TELE	0994936000
16	SCREW MA 6-32 X 5/8 RHP NI	0021417049
17	KNOBS CONTROL VINTAGE TELE DOME W/SET SCREWS	0992056000
18	CONTROLS 250K 10%	0990831000
19	HEX NUT 3/8-32 X 3/32 TK NI	0016352049
20	WASHER LOCK INTL 3/8 X .687	0016436049
21	CAP MPF RDL .022µF 250V 10%	0024832049
22	FERRULES STRING RETAINER NI SET	0994918000
23	BRIDGE ASSY AM PRO TELE CHROME 51 NOCASTER	7712189000
23A	BRIDGE PLATE AM PRO TELE CHROME	7709964000
23B	BRIDGE SECTION AM PRO TELE STANDARD	7709970000
23C	BRIDGE SECTION AM PRO TELE REVERSE	7710421000
23D	SCREW ST 6-32X5/16 NI HEX/SC OV	7710422049
23E	SCRW ST 6-32X3/8 NI HEX/SC OV	7710028049
23F	SPRING INTONATION 1.060 #144	0018689049
23G	SCREW M 6-32 X 1-1/4 RHP STL NI	0015834049
24	SCREW SMA 6 X 1 OHP NI	0037952049
25	SCREW SMA 3 X 1/2 OHP NI	0027956049
26	PICKUP ASSY 51 NOCASTER BRIDGE C/S	0056014000
27	SCREW 6-32 X 5/8 RHP STL NI	0015800049
28	TUBING LATEX CUT .250OD X .125ID X .425L	0039409000

*= NOT PICTURED IN DIAGRAM



LTD ED WHITEGUARD STRATOCASTER® (0176062707)

PARTS LIST

REF#	DESCRIPTION	PART NUMBER
29	PICKUP ASSY 51 NOCASTER NECK	0058053000
30	SCREW MACHINE 4-40 X 7/8 RHP STL NI	7700222000
31	TUBING SIL RUB CUT RED .625	0068156000
32	JACK PHONE OPEN CIRCUIT 11	0021956049
33	WASHER FLAT 3/8 X .614 NI	0031153049
34	FERRULE JACK RECESS FOOTBALL CHROME	0050100049
35	STRAP BUTTON CHROME	0063267049
36	SCREW WOOD 6 X 1 OHP NI	0016188049
37	WASHER FELT BLACK	0994929000
37	WASHERS FELT WHITE	0994930000
38	FERRULES STRING RETAINER NI SET	0994918000
*	CASE MOLDED AM ELITE GUITAR	7708545000
*	WRENCH 1/8 X 1-1/4 X 2-3/4 HEX (TRUSS ROD ADJUSTMENT / TILT NECK ADJUST)	0023811049
*	WRENCH HEX KEY 1/16 SHORT ARM (SADDLE HEIGHT ADJUSTMENT)	0021109049

*= NOT PICTURED IN DIAGRAM



LTD ED WHITEGUARD STRATOCASTER® (0176062707)

WIRING ASSEMBLY

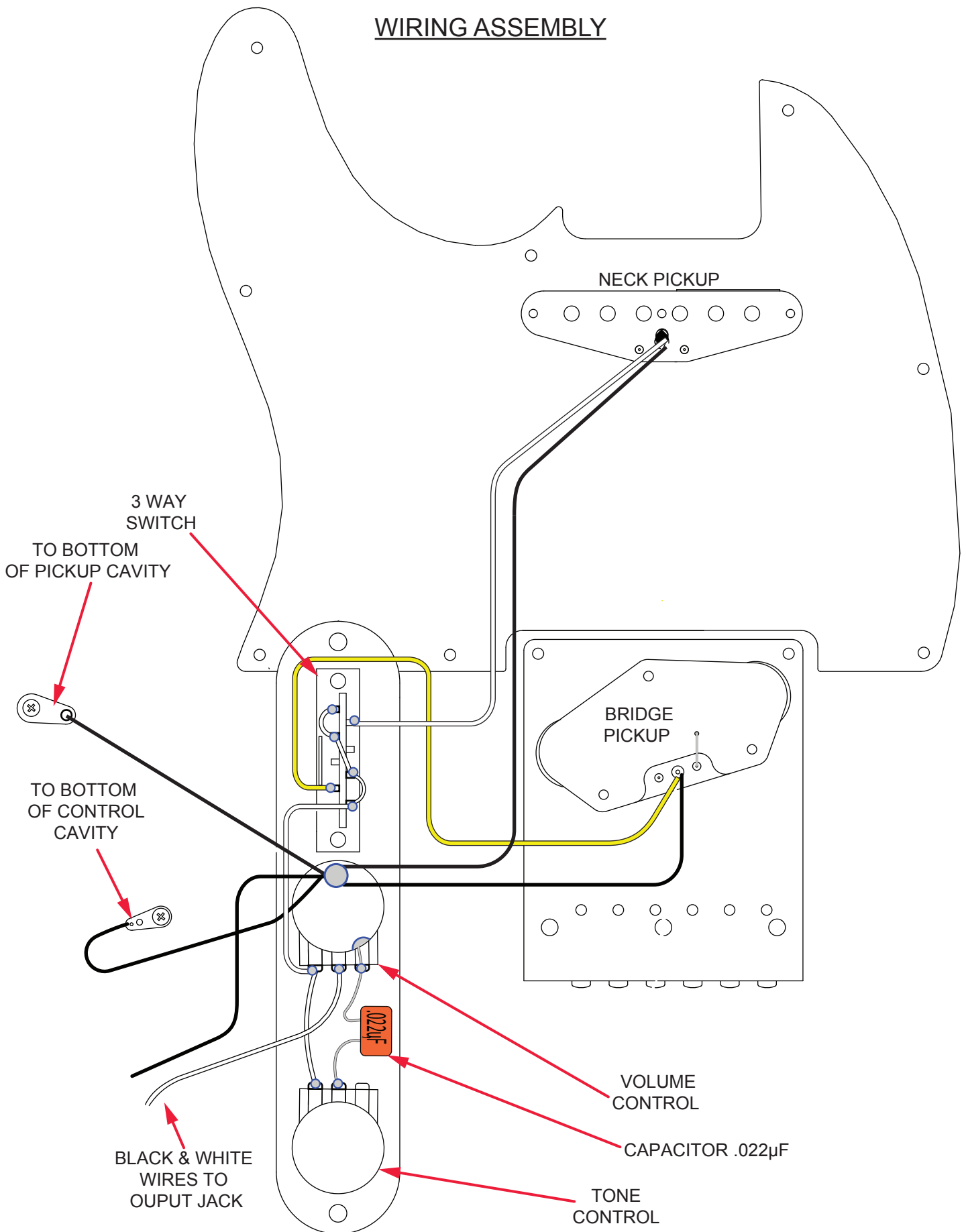

LTD ED WHITEGUARD STRATOCASTER® (0176062707)

SWITCH AND CONTROL FUNCTION

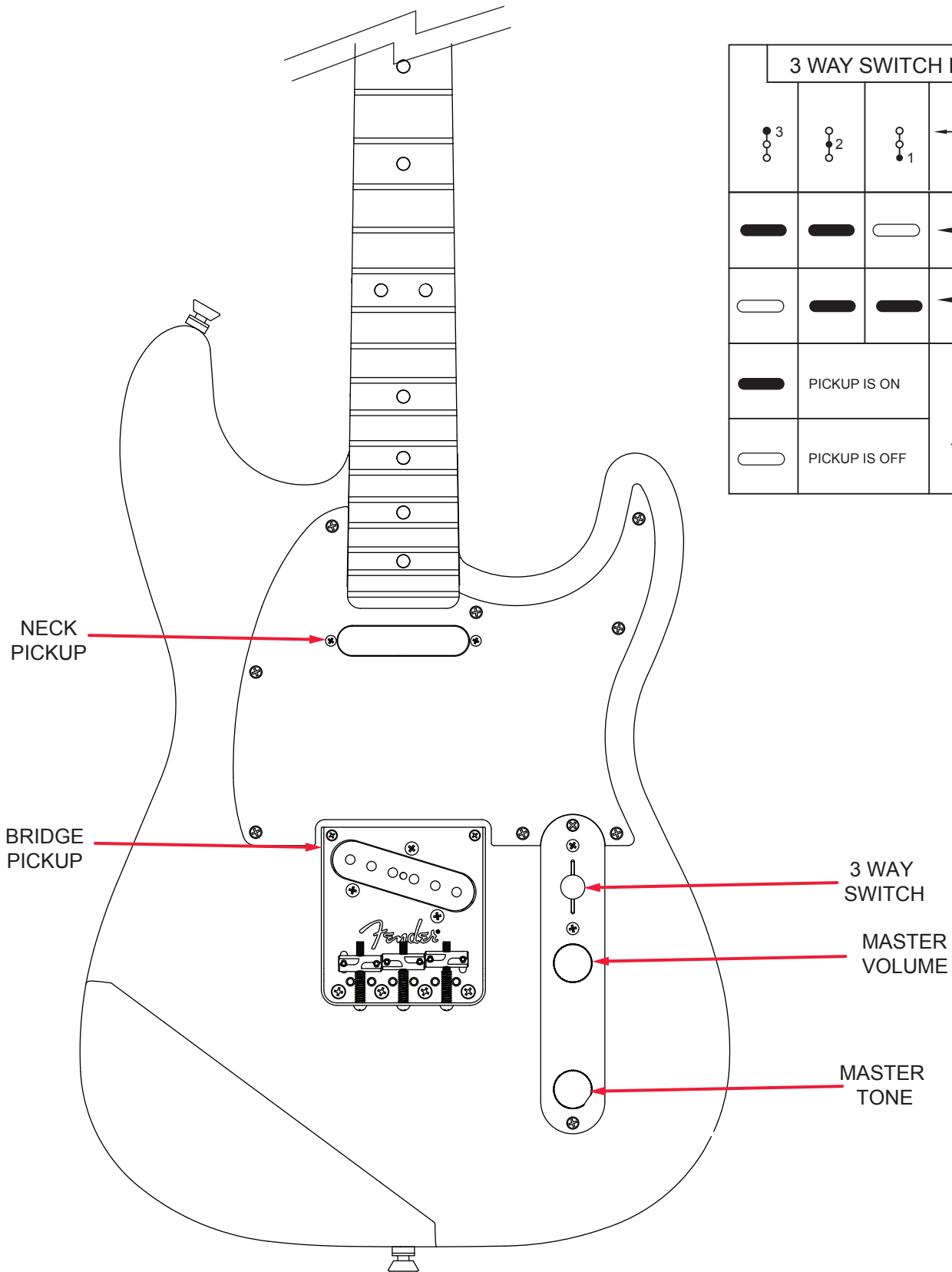

3 WAY SWITCH POSITION			
			← 3 WAY SWITCH POSITION
			← NECK PICKUP
			← BRIDGE PICKUP
	PICKUP IS ON	INDICATES POSITION OF 3 WAY SWITCH 	
	PICKUP IS OFF		

LTD ED WHITEGUARD STRATOCASTER® (0176062707)

ADDITIONAL SPECIFICATION DETAIL

FRET SIZE: JUMBO NARROW
(FRET DIMENSIONS ARE BEFORE INSTALLATION)

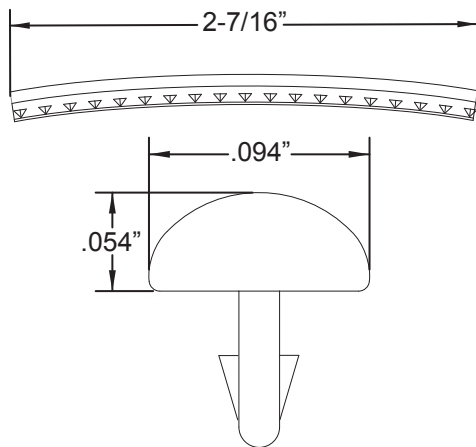

PLEASE NOTE: AS EACH NECK IS SANDED & FINISHED BY HAND, THICKNESS DIMENSIONS MAY VARY SLIGHTLY FROM THOSE SHOWN.

NECK PROFILE: MODERN DEEP "C"

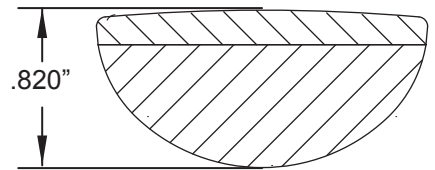

1ST FRET PROFILE

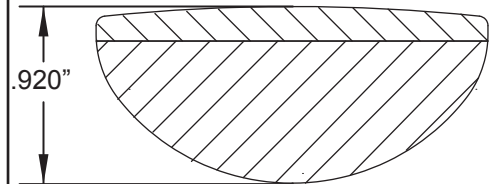

12TH FRET PROFILE

STAGGERED TUNING MACHINE SET W/HDWR P/N 0990820100

OUTER SHAFT DIAMETER .394"

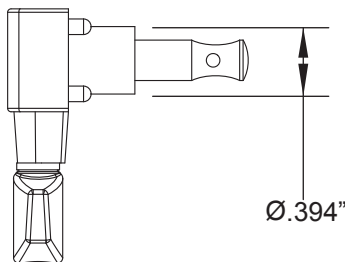

TUNING MACHINE THRU-HOLE

INNER DIAMETER .404"

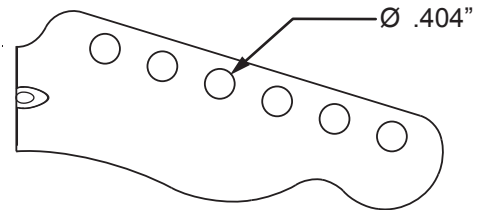

SADDLE HEIGHT ADJUSTMENT WRENCH:

1/16" HEX KEY P/N 0021109049

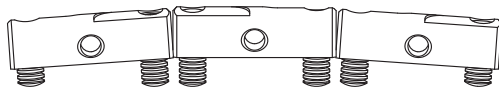
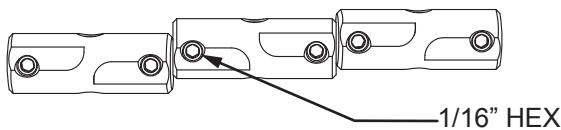

SADDLE HEIGHT SET SCREWS

TALL: P/N 7710428049

SHORT: P/N 7710422049

TRUSS ROD NUT P/N 0994943000

TRUSS ROD ADJUSTMENT WRENCH:

1/8" HEX KEY P/N 0023811049

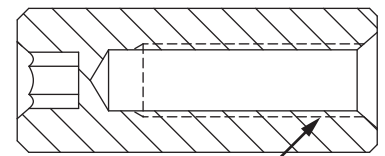
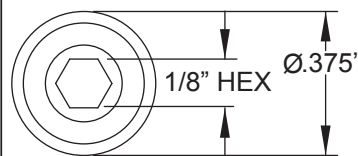

10-32
THREAD

LOGO: AMERICAN PRO OFFSET TELE
APPLIED UNDER THE FINISH



PICKUP SPECIFICATIONS

POSITION	MAGNETS	DC RESISTANCE	POLARITY
NECK	ALNICO 3 UNBEVELED	6.9 - 7.5KΩ	NORTH
BRIDGE	ALNICO 3 UNBEVELED	6.9 - 7.5KΩ	SOUTH