

AMERICAN PRO PRECISION BASS® LH (0194620XXX)

PARTS LAYOUT

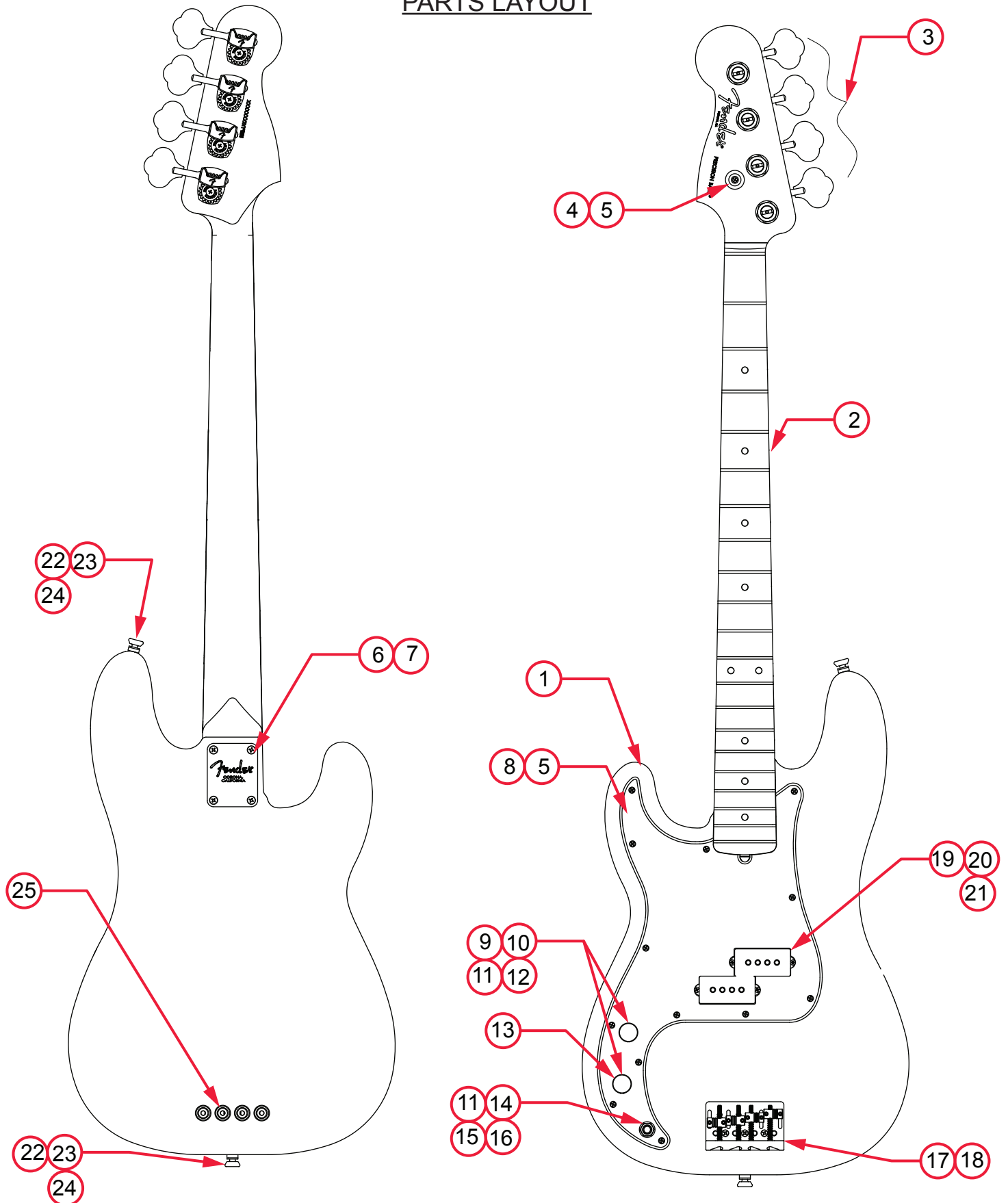

AMERICAN PRO PRECISION BASS® LH (0194620XXX)

PARTS LIST

| REF# | DESCRIPTION | PART NUMBER |
|------|--|-------------|
| 1 | BODY AM STD P-BASS LH 3TS | 0068071500 |
| 1 | BODY AM STD P-BASS LH OWT | 0075566505 |
| 1 | BODY AM STD P-BASS LH BLK | 0075566506 |
| 2 | NECK ASSY AM PRO P-BASS LH RW | 7710504000 |
| 3 | KEY BASS DLX NEW MOD TAPER LONG LH | 7710694000 |
| 4 | STRING GUIDE BASS CHROME W/SCREW | 0994913000 |
| 5 | SCREW SMAB 4 X 1/2 OHP NI | 0015578049 |
| 6 | NECK PLATE CORONA CA W/HARDWARE | 0991446100 |
| 7 | SCREW SMA 8 X 1-3/4 OHP NI | 0015636049 |
| 8 | PICKGUARD AM STD P-BASS LH MG/BLK/MG | 7702223000 |
| 9 | KNOBS CONTROL ALUM CHROME W/SET SCREW | 0095799049 |
| 10 | CONTROL 250K 10% R-AUDIO METAL | 0063991000 |
| 11 | HEX NUT 3/8-32 X 3/32 TK NI | 0016352049 |
| 12 | WASHER LOCK INTL 3/8 X .687 | 0016436049 |
| 13 | CAPACITOR CD .05µF 100V 20% | 0015552049 |
| 14 | JACK PHONE OPEN CIRCUIT | 0021956049 |
| 15 | WASHER FLAT 3/8 X .614 NI | 0031153049 |
| 16 | WASHER LOCKING INTL 3/8 X .500 X .020 NI | 0022384049 |
| 17 | BRIDGE ASSY HIGH MASS VINTAGE LH | 0075134000 |
| 17A | BASE PLATE BASS HIGH MASS VINTAGE | 0075125000 |
| 17B | BRIDGE BACKSTOP BASS HIGH MASS VINTAGE | 0075126000 |
| 17C | BRIDGE SADDLE BASS HMV 1-2 | 0075127000 |
| 17D | BRIDGE SADDLE BASS HMV 3-4 | 0075135000 |
| 17E | SCREW 6-32 X 5/16 FHP ZI | 0076154000 |
| 17F | SCREW CAP 6-32 X 1-1/2 HEX SKT BLX | 0075394000 |
| 17G | SPRING TELE BRIDGE BLACK | 0018872049 |
| 17H | SCREW SET 6-32 X 7/16 HEX SKT BLX NYLOK | 0075354000 |
| 18 | SCREW SMAB 5 X 1 OHP NI | 0015610049 |
| 19 | PICKUP ASSY AM PRO P-BASS LH | 7710559000 |
| 20 | PICKUP COVERS PRECISION BASS BLACK | 0992037000 |
| 21 | SCREW 4 X 1-1/4 WOOD RHP NI | 0027035049 |
| | | |
| | | |
| | | |
| | | |
| | | |

*= NOT PICTURED IN DIAGRAM



AMERICAN PRO PRECISION BASS® LH (0194620XXX)

WIRING ASSEMBLY

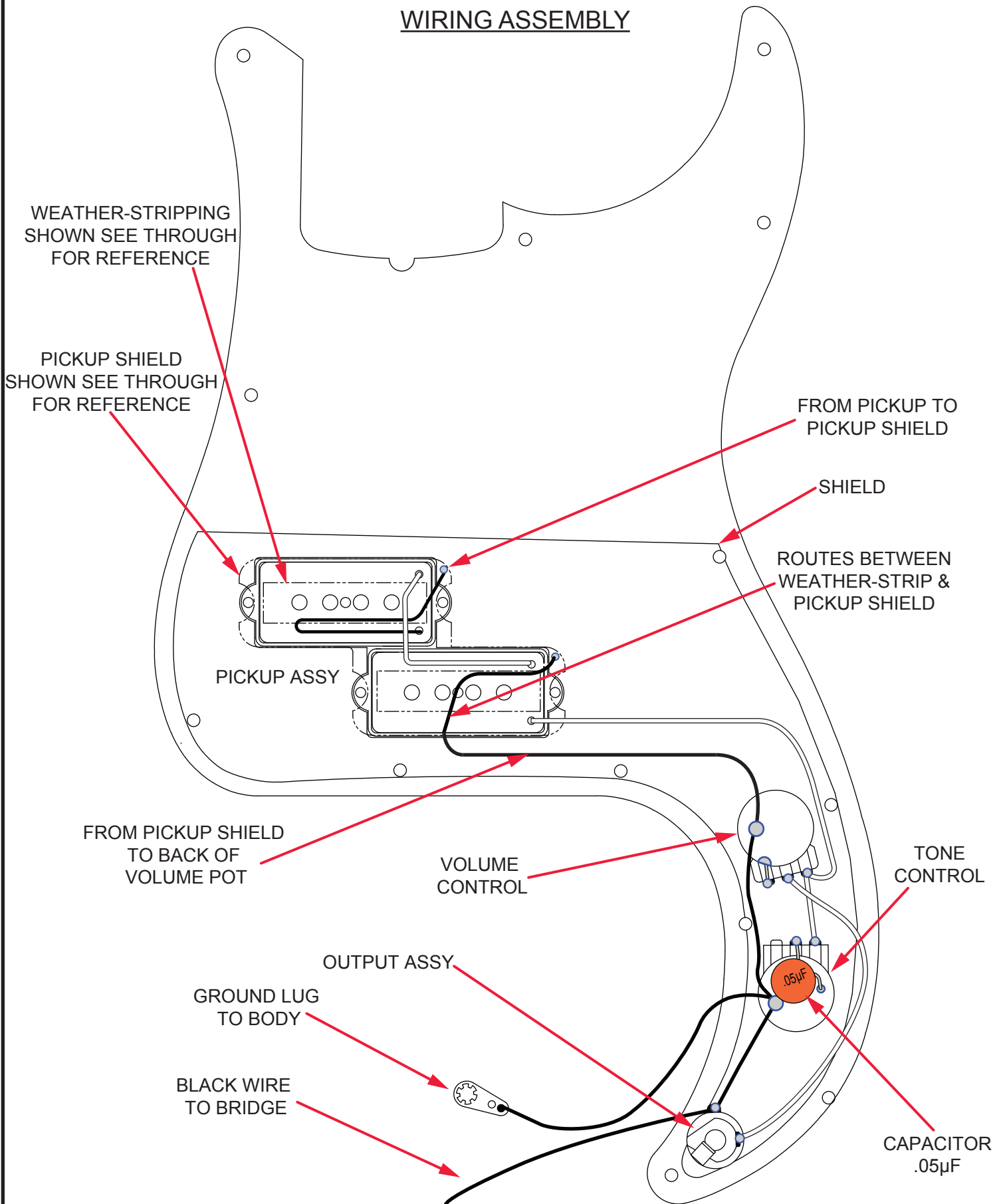

AMERICAN PRO PRECISION BASS® LH (0194620XXX)

SWITCH AND CONTROL FUNCTION

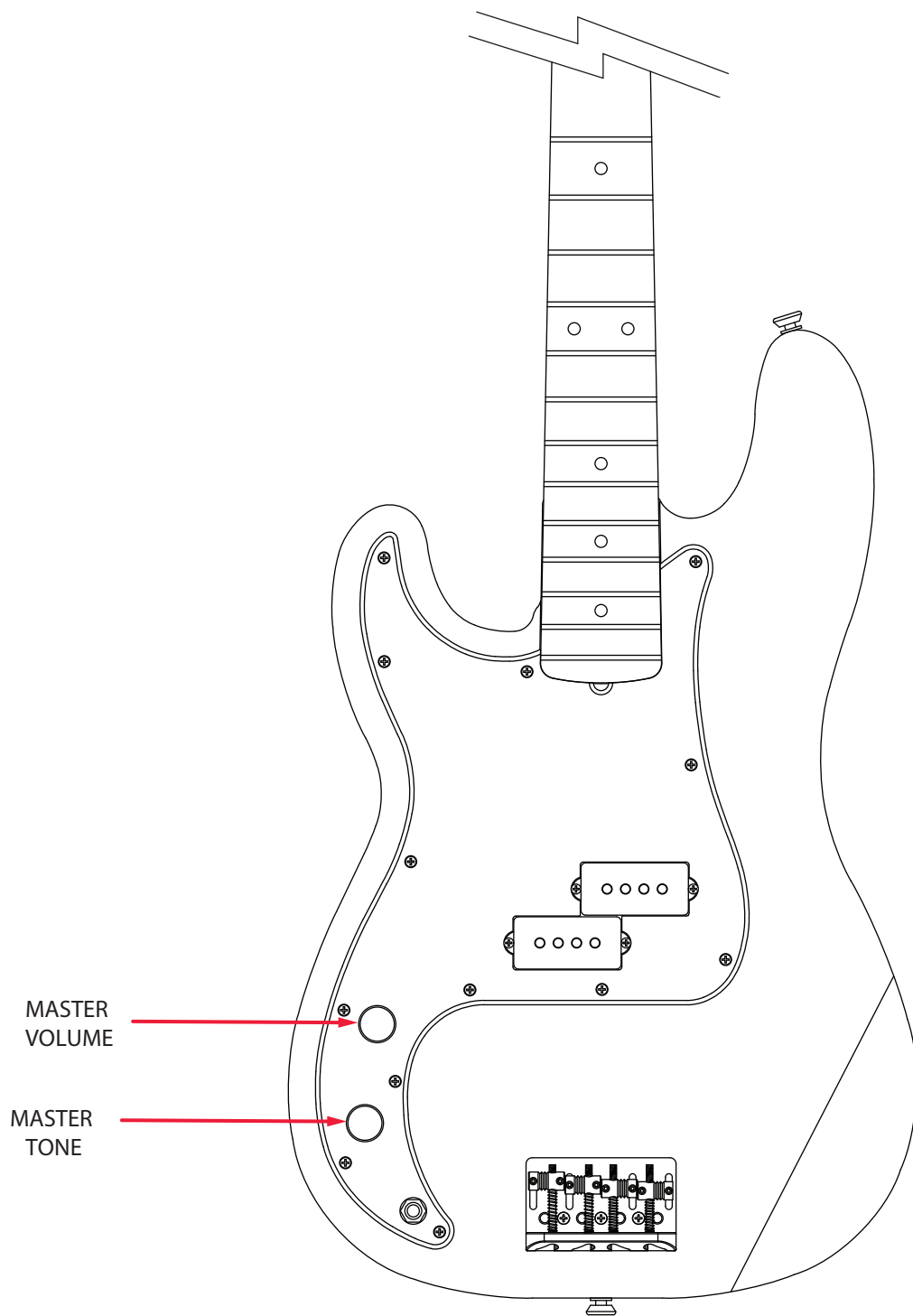

AMERICAN PRO PRECISION BASS® LH (0194620XXX)

ADDITIONAL SPECIFICATION DETAIL

FRET SIZE: JUMBO NARROW
(FRET DIMENSIONS ARE BEFORE INSTALLATION)

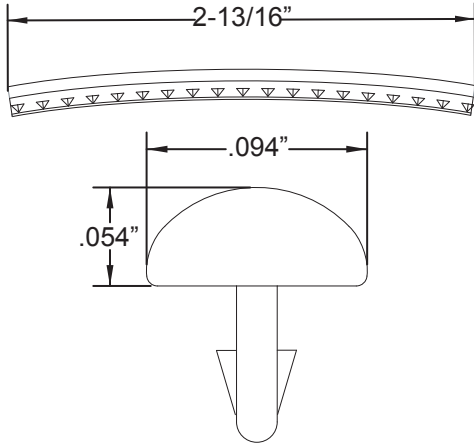

PLEASE NOTE: AS EACH NECK IS SANDED & FINISHED BY HAND, THICKNESS DIMENSIONS MAY VARY SLIGHTLY FROM THOSE SHOWN.

NECK PROFILE: VINTAGE "C"

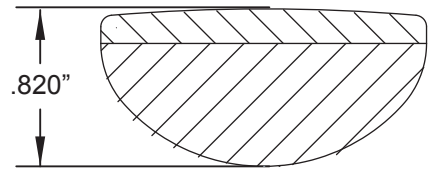

1ST FRET PROFILE

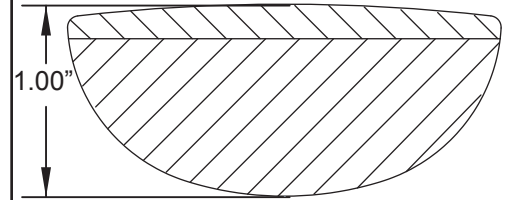

12TH FRET PROFILE

STAGGERED TUNING MACHINES SET: P/N 0097335049
OUTER SHAFT DIAMETER .533"

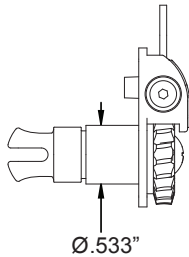

TUNING MACHINE THRU-HOLE
INNER DIAMETER .687"

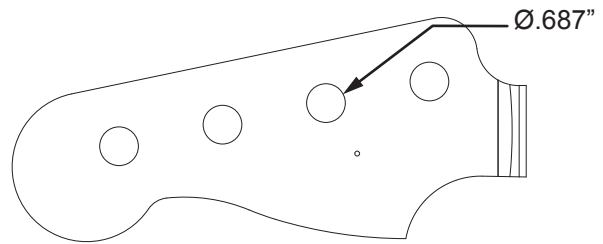

SADDLE HEIGHT ADJUSTMENT WRENCH:
1/16" HEX KEY P/N 0021109049

SADDLE HEIGHT ADJUSTMENT SCREWS: P/N 0075354000

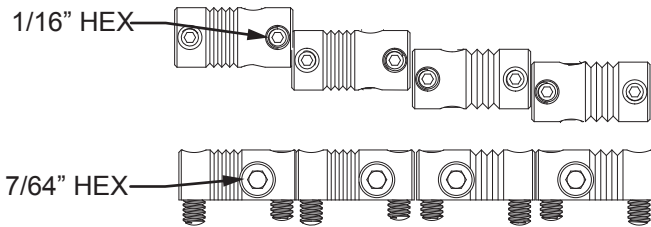

INTONATION ADJUSTMENT WRENCH:
7/64 HEX KEY P/N 0995504002

TRUSS ROD ADJUSTMENT NUT:
P/N 0048688049

TRUSS ROD ADJUSTMENT WRENCH:
3/16" HEX KEY P/N 7710885000

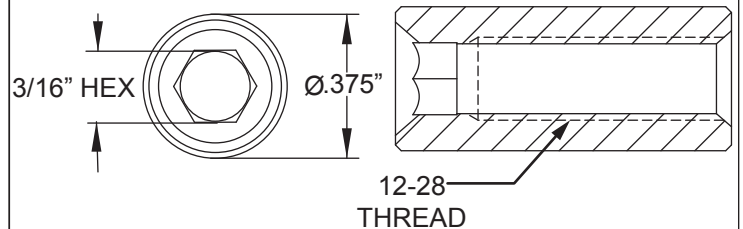

LOGO: AM PRO P-BASS LH DECAL
APPLIED UNDER THE FINISH

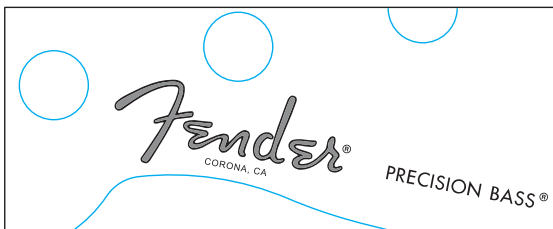

PICKUP SPECIFICATIONS

| POSITION | MAGNETS | DC RESISTANCE | POLARITY |
|----------|------------------|---------------|----------|
| NECK | ALNICO 2 BEVELED | 5.5 - 6.1KΩ | NORTH |
| BRIDGE | ALNICO 5 BEVELED | 5.6 - 6.2KΩ | SOUTH |