

AMERICAN PRO TELECASTER® (011306XXX)

PARTS LAYOUT

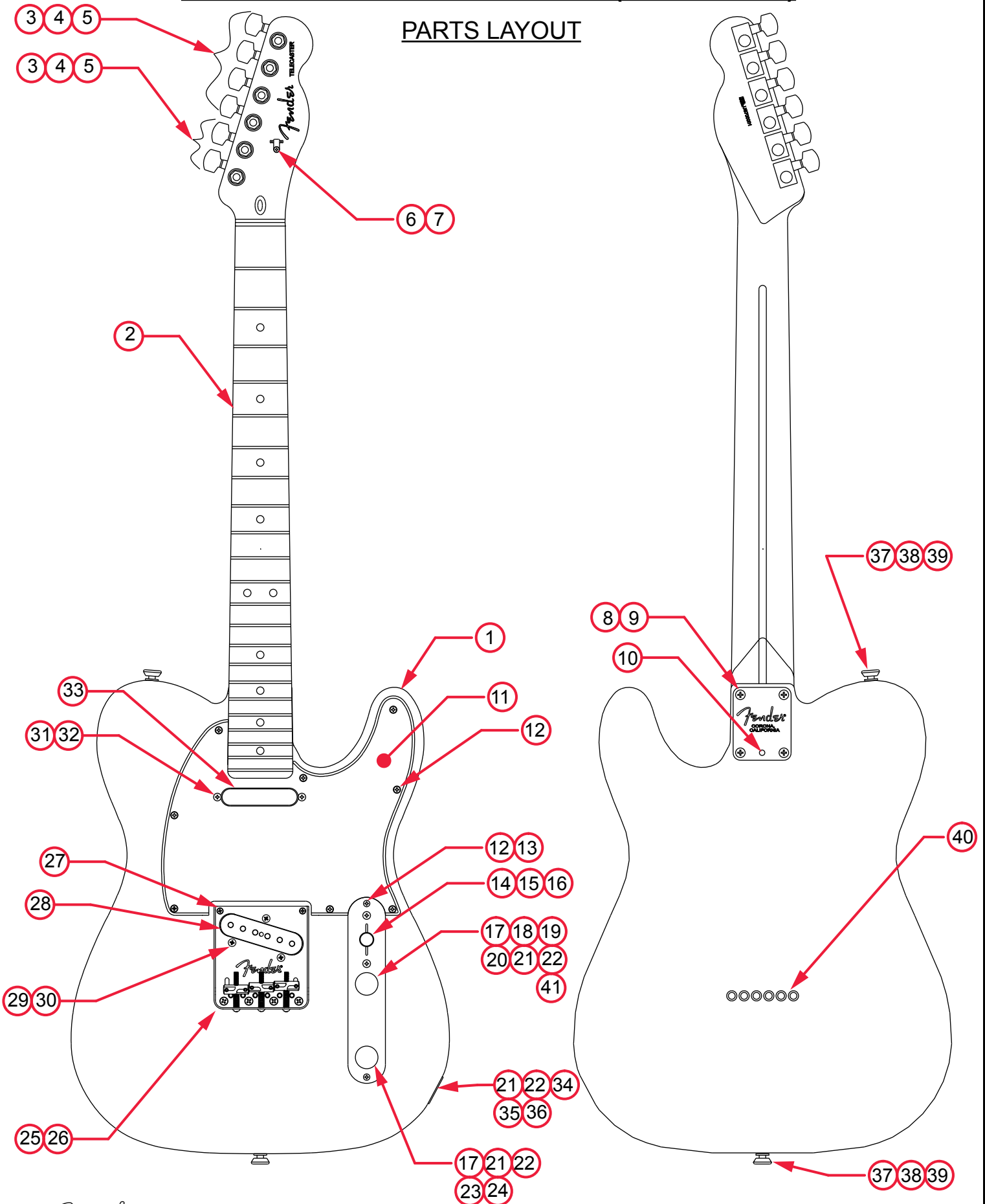

AMERICAN PRO TELECASTER® (011306XXX)

PARTS LIST

REF#	DESCRIPTION	PART NUMBER
1	BODY AM PRO TELE 3TS	7709903500
1	BODY AM PRO TELE 2TS	7709905503
1	BODY AM PRO TELE BLK	7709904506
1	BODY AM PRO TELE NAT	7709905521
1	BODY AM PRO TELE CRT	7709905538
1	BODY AM PRO TELE OWT	7709904505
1	BODY AM PRO TELE SNG	7709904548
1	BODY AM PRO TELE BTB	7709905550
1	BODY AM PRO TELE CAR	7709904509
2	NECK ASSY AM PRO TELE RW	7709882000
2	NECK ASSY AM PRO TELE MPL	7709883000
3	KEYS GUITAR 2-PIN MTG SET 2-LONG 4-SHORT W/HARDWARE	0990820100
4	WASHER KEY	0053106049
5	BUSHING KEY	0058820049
6	STRING TREE W/HARDWARE	0994911000
7	SCREW SMAB 3 X 3/8 RHP STL NI	0011357049
8	NECK PLATE CORONA CA TILT W/HARDWARE	0991445100
9	SCREW SMA 8 X 1-3/4 OHP NI	0015636049
10	SET SCREW 1/4-20 X 3/8 OP NI HEX	0031571000
11	PICKGUARD TELE AM STD RH P/B/P	0991375000
11	PICKGUARD TELE AM STD RH 1-PLY BLK	0053191000
11	PICKGUARD TELE AM STD RH MG/BLK/MG	0056083000
11	PICKGUARD TELE AM STD RH B/W/B	0073054000
12	SCREW SMAB 4 X 1/2 OHP NI	0015578049
13	CONTROL PLATE TELE ALUM CHROME	0093823000
14	SWITCH 3 WAY LEVER W/MTL	0992041000
15	KNOB SWITCH VINT TELE	0994936000
16	SCREW MA 6-32 X 5/8 RHP NI	0021417049
17	KNOBS DIAMOND KNURLED ALUM CHROME W/SET SCREW	0095799049
18	CAPACITOR CD 1200pF 1000V 10%	0065862000
19	RESISTOR CF 1/4W 20K 5%	0029006001
20	RESISTOR CF 1/4W 150K 5%	0024999001
21	HEX NUT 3/8-32 X 3/32 TK NI	0016352049
22	WASHER LOCK INTL 3/8 X .687	0016436049
23	CONTROLS 250K 10%	0990831000
24	CAP MPF RDL .022µF 250V 10%	0024832049

*= NOT PICTURED IN DIAGRAM



AMERICAN PRO TELECASTER® (011306XXX)

PARTS LIST

REF#	DESCRIPTION	PART NUMBER
25	BRIDGE ASSY AM PRO TELE CHROME	7710418000
25A	BRIDGE PLATE AM PRO TELE CHROME	7709964000
25B	BRIDGE SECTION AM PRO TELE STANDARD	7709970000
25C	BRIDGE SECTION AM PRO TELE REVERSE	7710421000
25D	SCREW ST 6-32X5/16 NI HEX/SC OV	7710422049
25E	SCRW ST 6-32X3/8 NI HEX/SC OV	7710028049
25F	SPRING INTONATION 1.060 #144	0018689049
25G	SCREW M 6-32 X 1-1/4 RHP STL NI	0015834049
26	SCREW SMA 6 X 1 OHP NI	0037952049
27	SCREW SMA 3 X 1/2 OHP NI	0027956049
28	PICKUP ASSY AM PRO SHAW BRIDGE	7710409000
29	SCREW 6-32 X 5/8 RHP STL NI	0015800049
30	TUBING LATEX CUT .250OD X .125ID X .425L	0039409000
31	PICKUP ASSY AM PRO SHAW TELE NECK	7710411000
32	SCREW MACHINE 4-40 X 7/8 RHP STL NI	7700222000
33	TUBING SIL RUB CUT RED .625	0068156000
34	JACK PHONE OPEN CIRCT 11	0021956049
35	FERRULE JACK STD TELE CHROME	0021452000
36	RETAINER JACK NI PLT TELE	0010355069
37	STRAP BUTTON CHROME	0063267049
38	SCREW WOOD 6 X 1 OHP NI	0016188049
39	WASHER FELT BLACK	0994929000
39	WASHERS FELT WHITE	0994930000
40	FERRULES STRING RETAINER NI SET	0994918000
41	PCB ASSY TREBLE BLEED AM PRO STRAT/TELE	7711092000
*	CASE MOLDED AM ELITE GUITAR	7708545000
*	WRENCH 1/8 X 1-1/4 X 2-3/4 HEX (TRUSS ROD ADJUSTMENT / TILT NECK ADJUST)	0023811049
*	WRENCH HEX KEY 1/16 SHORT ARM (SADDLE HEIGHT ADJUSTMENT)	0021109049

*= NOT PICTURED IN DIAGRAM



AMERICAN PRO TELECASTER® (011306XXX)

WIRING ASSEMBLY RESISTOR & CAPACITOR TREBLE BLEED CIRCUIT

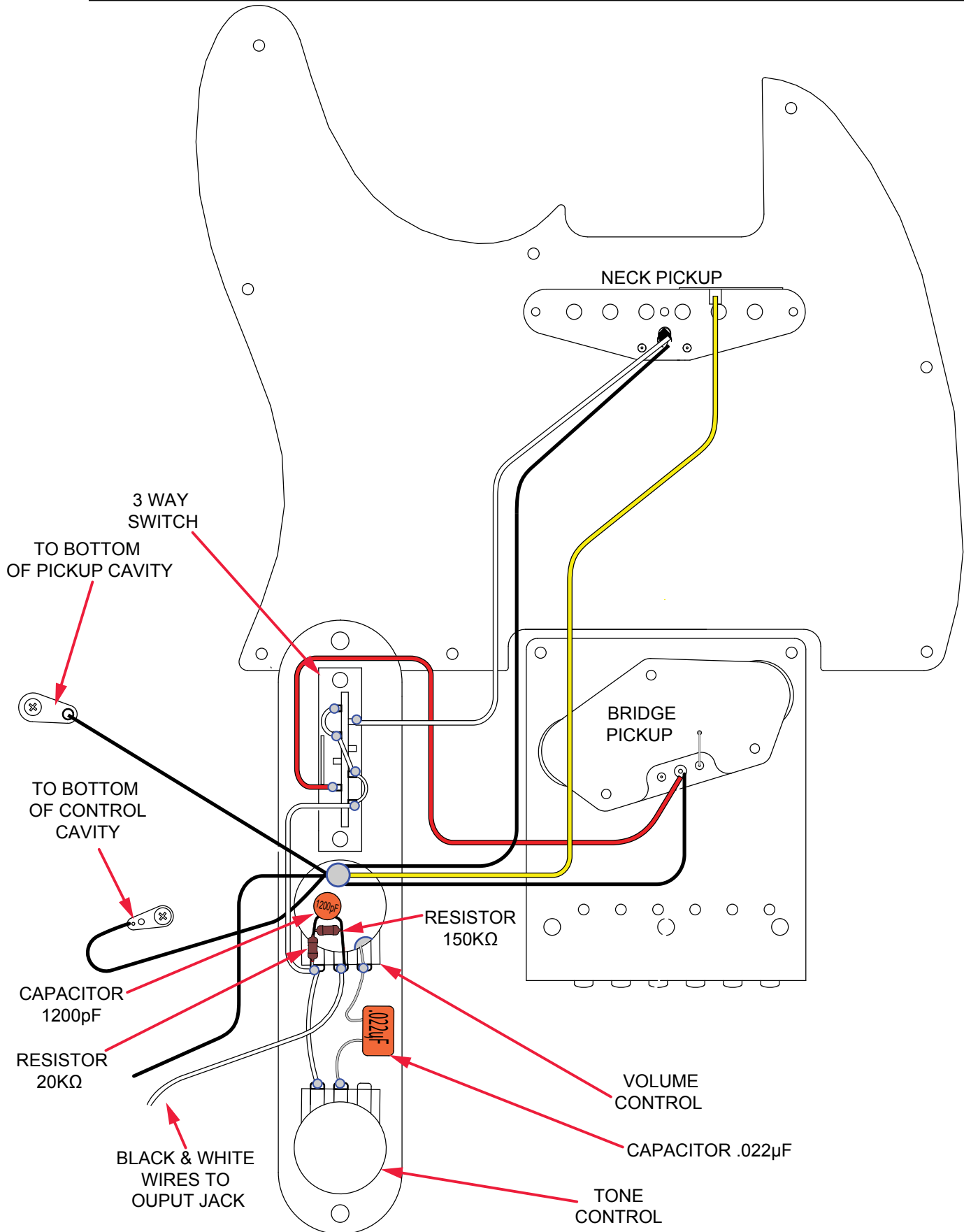

AMERICAN PRO TELECASTER® (011306XXX)

WIRING ASSEMBLY PCB TREBLE BLEED CIRCUIT

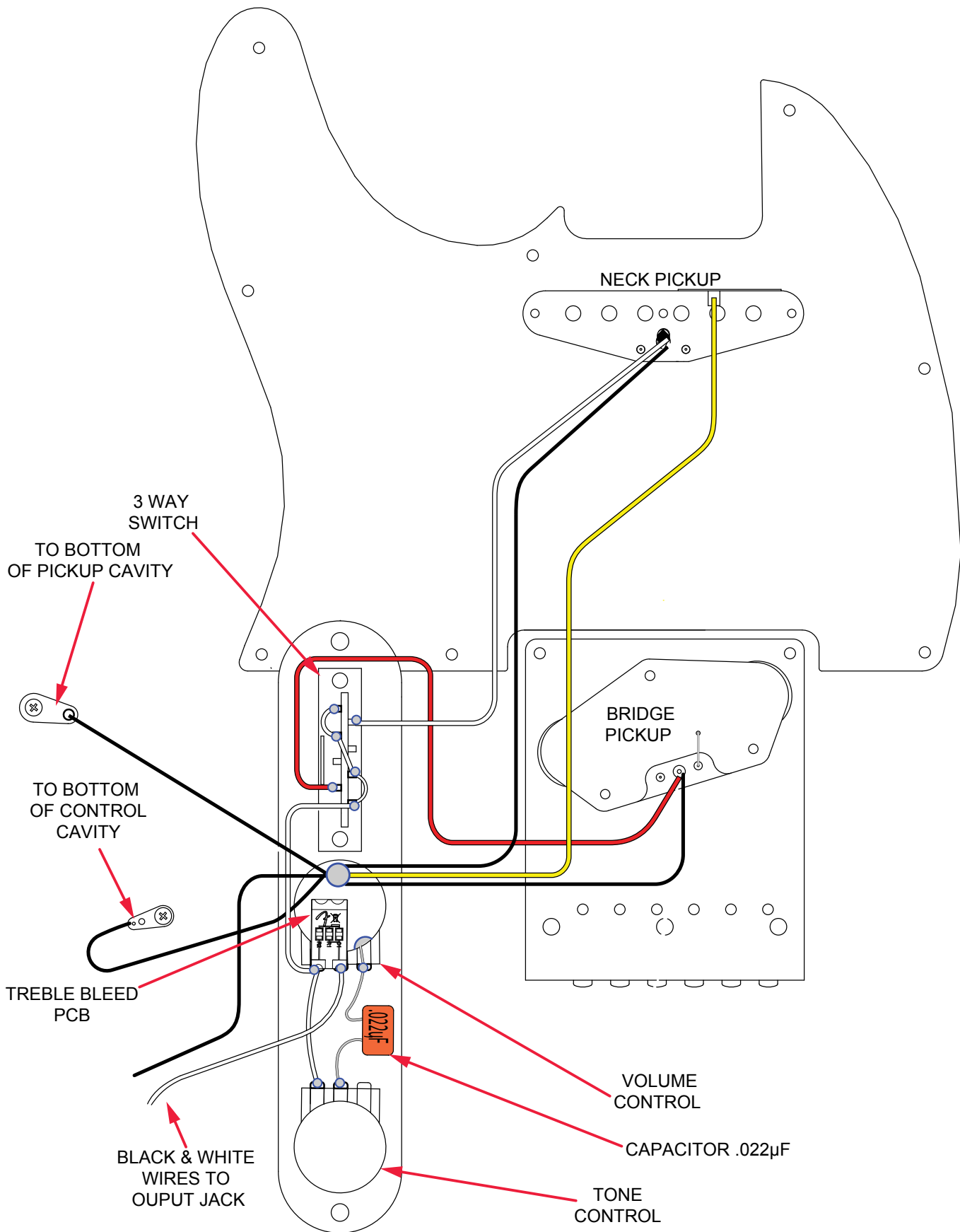

AMERICAN PRO TELECASTER® (011306XXX)

SWITCH AND CONTROL FUNCTION

3 WAY SWITCH POSITION			
			← 3 WAY SWITCH POSITION
			← NECK PICKUP
			← BRIDGE PICKUP
	PICKUP IS ON		INDICATES POSITION OF 3 WAY SWITCH
	PICKUP IS OFF		

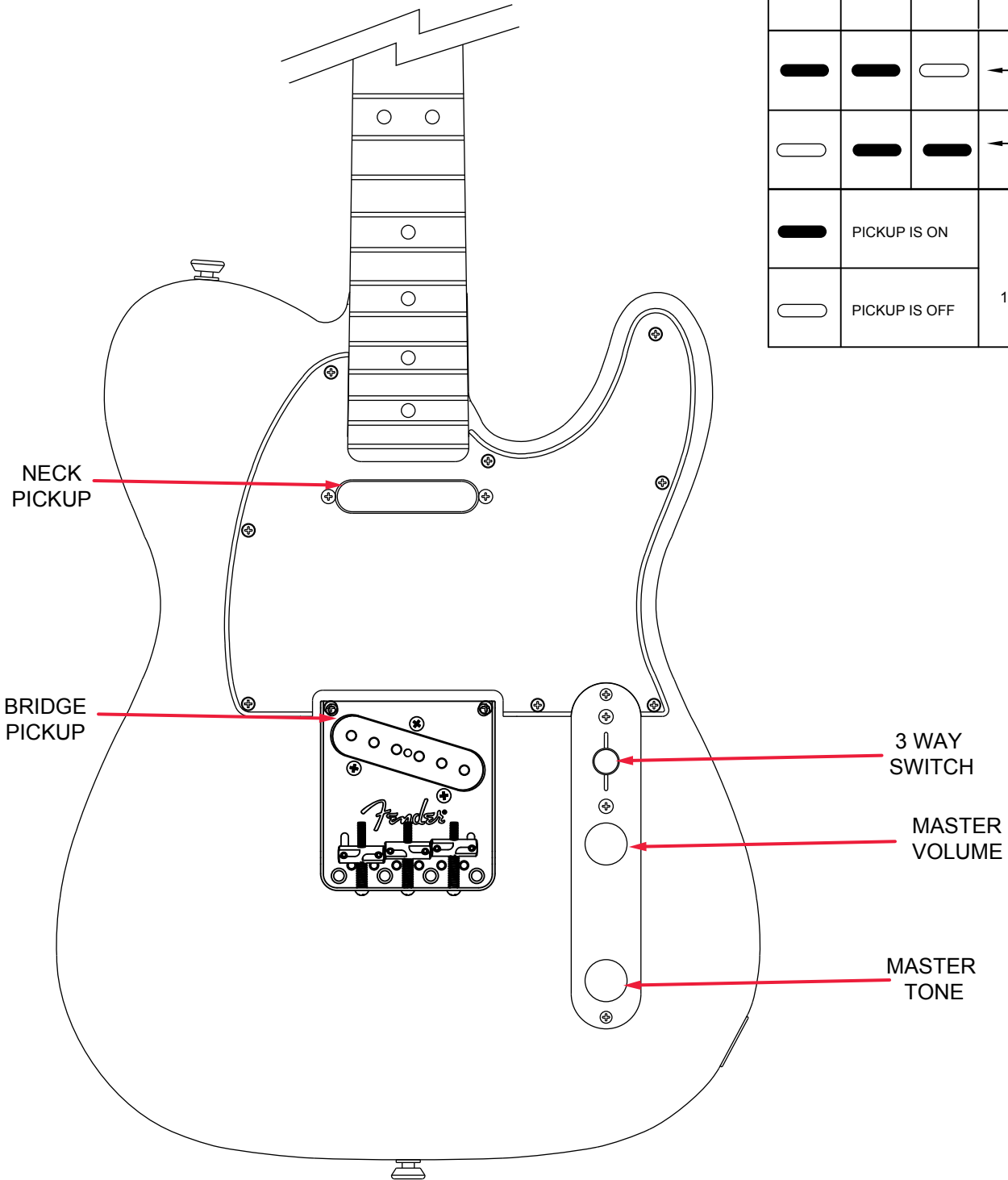

AMERICAN PRO TELECASTER® (011306XXX)

ADDITIONAL SPECIFICATION DETAIL

FRET SIZE: JUMBO NARROW
(FRET DIMENSIONS ARE BEFORE INSTALLATION)

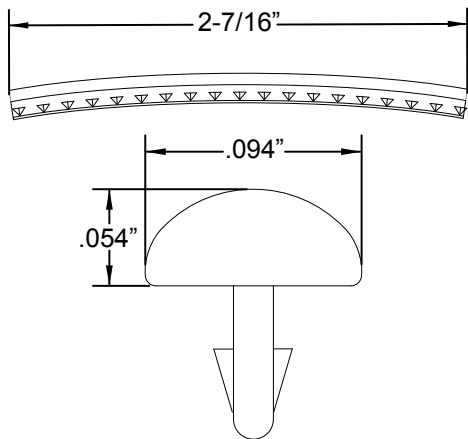

PLEASE NOTE: AS EACH NECK IS SANDED & FINISHED BY HAND, THICKNESS DIMENSIONS MAY VARY SLIGHTLY FROM THOSE SHOWN.

NECK PROFILE: MODERN DEEP "C"

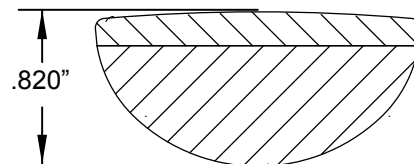

1ST FRET PROFILE

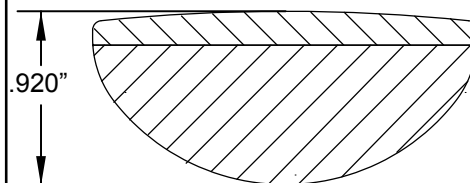

12TH FRET PROFILE

STAGGERED TUNING MACHINE SET W/HDWR P/N 0990820100
OUTER SHAFT DIAMETER .394"

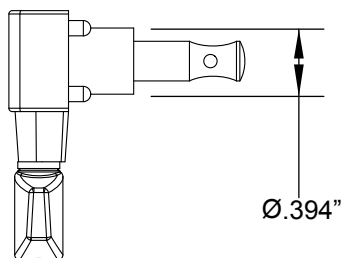

TUNING MACHINE THRU-HOLE
INNER DIAMETER .404"

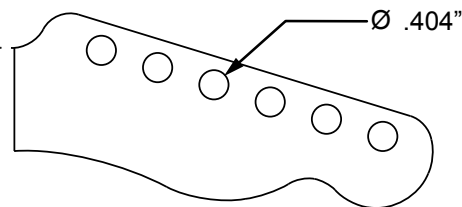

SADDLE HEIGHT ADJUSTMENT WRENCH:
1/16" HEX KEY P/N 0021109049

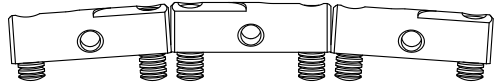
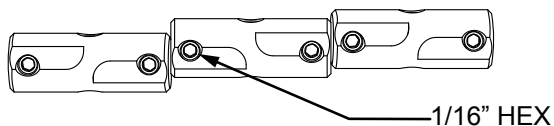

SADDLE HEIGHT SET SCREWS

TALL: P/N 7710428049 SHORT: P/N 7710422049

TRUSS ROD NUT P/N 0994943000
TRUSS ROD ADJUSTMENT WRENCH:
1/8" HEX KEY P/N 0023811049

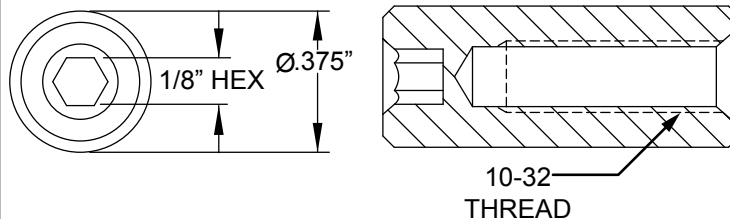

LOGO: AMERICAN PRO TELE
APPLIED UNDER THE FINISH



PICKUP SPECIFICATIONS

POSITION	MAGNETS	DC RESISTANCE	POLARITY
NECK	ALNICO 5 & 2	5.6 - 6.2KΩ	NORTH

