

# AMERICAN ORIGINAL 50'S PRECISION BASS® (0190102XXX)

## PARTS LAYOUT

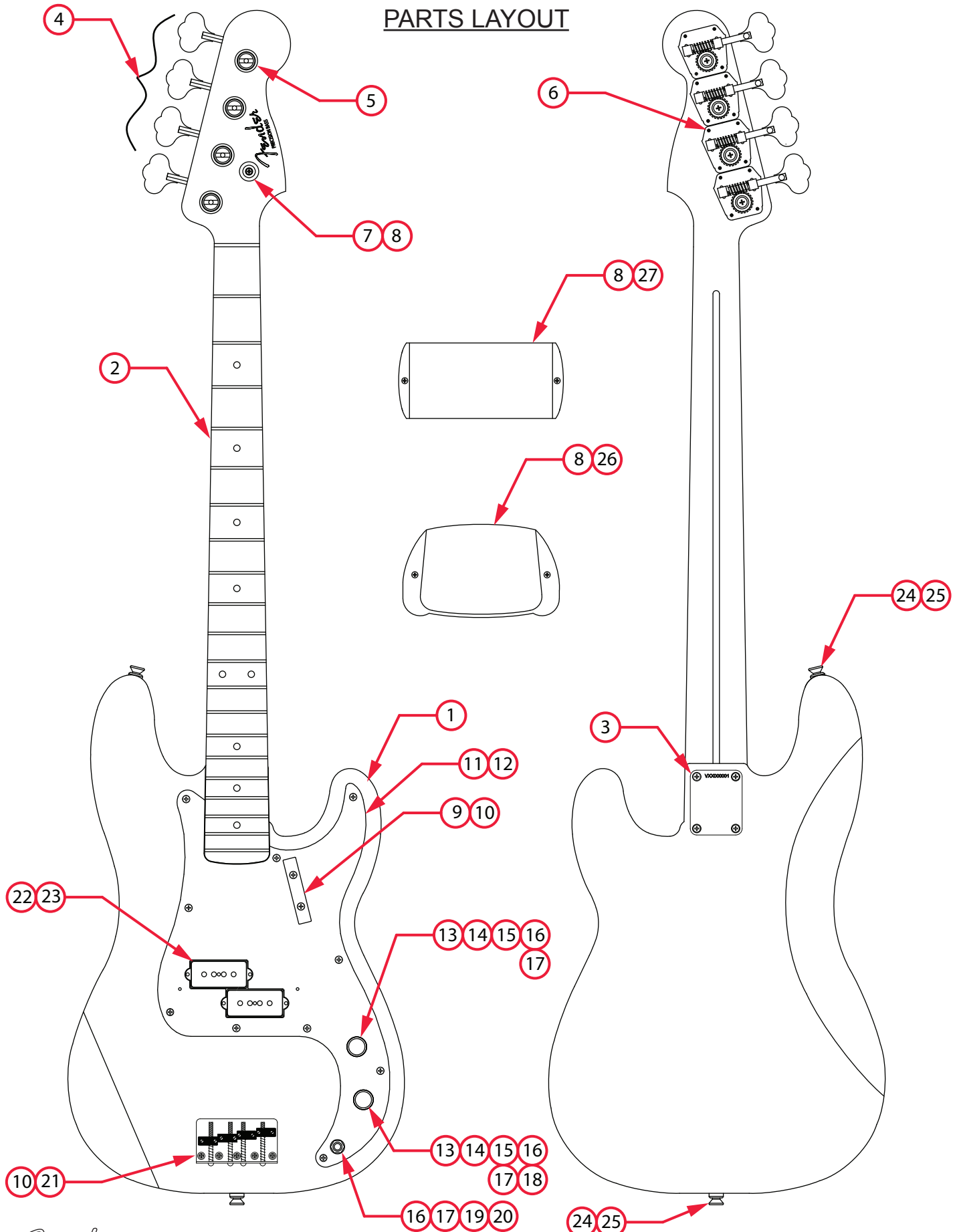

# AMERICAN ORIGINAL 50'S PRECISION BASS® (0190102XXX)

## PARTS LIST

REF#	DESCRIPTION	PART NUMBER
1	BODY AM ORIGINAL 50'S P-BASS WBL	7710946501
1	BODY AM ORIGINAL 50'S P-BASS 2TSB	7710943503
2	NECK ASSY AM ORIGINAL 50'S P-BASS MPL	7710944000
3	SCREW WOOD 8 X 2 OHP STL BRITE NI	0058060000
4	KEY SET VINT BASS	0078834000
5	BUSHING STRING POST VINT BASS	0019509049
6	SCREW SMAB 3 X 3/8 RHP NI	0011357049
7	STRING GUIDE VINT BASS 50'S	0095421000
8	SCREW SMA 5 X 5/8 OHP NI	0015602049
9	THUMB REST	0992036000
10	SCREW SMAB 5 X 1 OHP NI	0015610049
11	PICKGUARD 58 P-BASS GOLD ANODIZED	0095634000
12	SCREW SMAB 4 X 1/2 OHP NI	0015578049
13	KNOB CONTROL 58 TELE KNURLED CHROME	0094057000
14	CONTROL 250K 10%	0990831000
15	SET SCREW 8-32 X 3/16	0994922000
16	NUT HEX 3/8-32 X 3/32 TK NI	0016352049
17	WASHER LOCK INTL 3/8 X .687	0016436049
18	CAPACITOR CAP WAX PAPER .10µF 150V	0096453000
19	JACK PHONE OPEN CIRCUIT	0021956049
20	WASHER FLAT 3/8 X .614 NI	0031153049
21	BRIDGE ASSY AM VINT 58-PBASS	0095613000
21A	BRIDGE PLATE JAZZ BASS	0010538070
21B	BRIDGE SECTION 5/16-40 VINT BASS NI	0095420000
21C	SET SCREW 6-32 X 7/16 OVPT SL NI	0016105049
21D	SCREW M 6-32 X 1-1/2 RHP NI	0015842049
21E	SPRING COMPRESSION 1-1/16 #144	0018689049
22	PICKUP/SHIELD ASSY 58 P-BASS	0095683000
23	SCREW 4 X 1-1/4 WOOD RND PH NI	0027035049
24	STRAP BUTTON NI .156	0994915000
25	SCREW WOOD 6 X 1 OHP NI	0016188049
26	BRIDGE COVER CHROME P-BASS	0010108000
27	COVER STEEL PICKUP VINT UPG P-BASS CHROME	0096825000
*	CASE P-BASS TWEED NO C/S LOGO	0059255011

\*= NOT PICTURED IN DIAGRAM



# AMERICAN ORIGINAL 50'S PRECISION BASS® (0190102XXX)

## WIRING ASSEMBLY

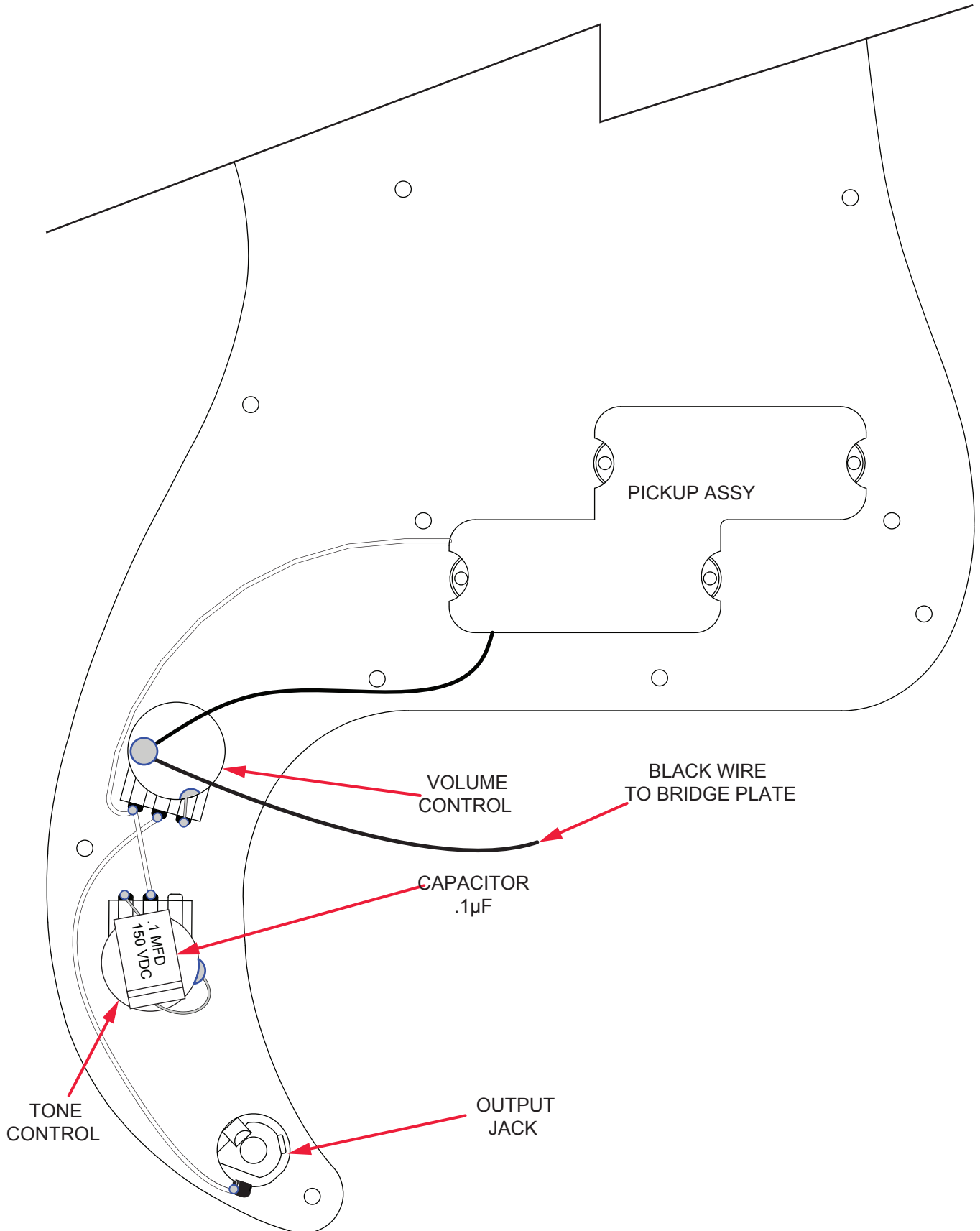

# AMERICAN ORIGINAL 50'S PRECISION BASS® (0190102XXX)

## SWITCH AND CONTROL FUNCTION

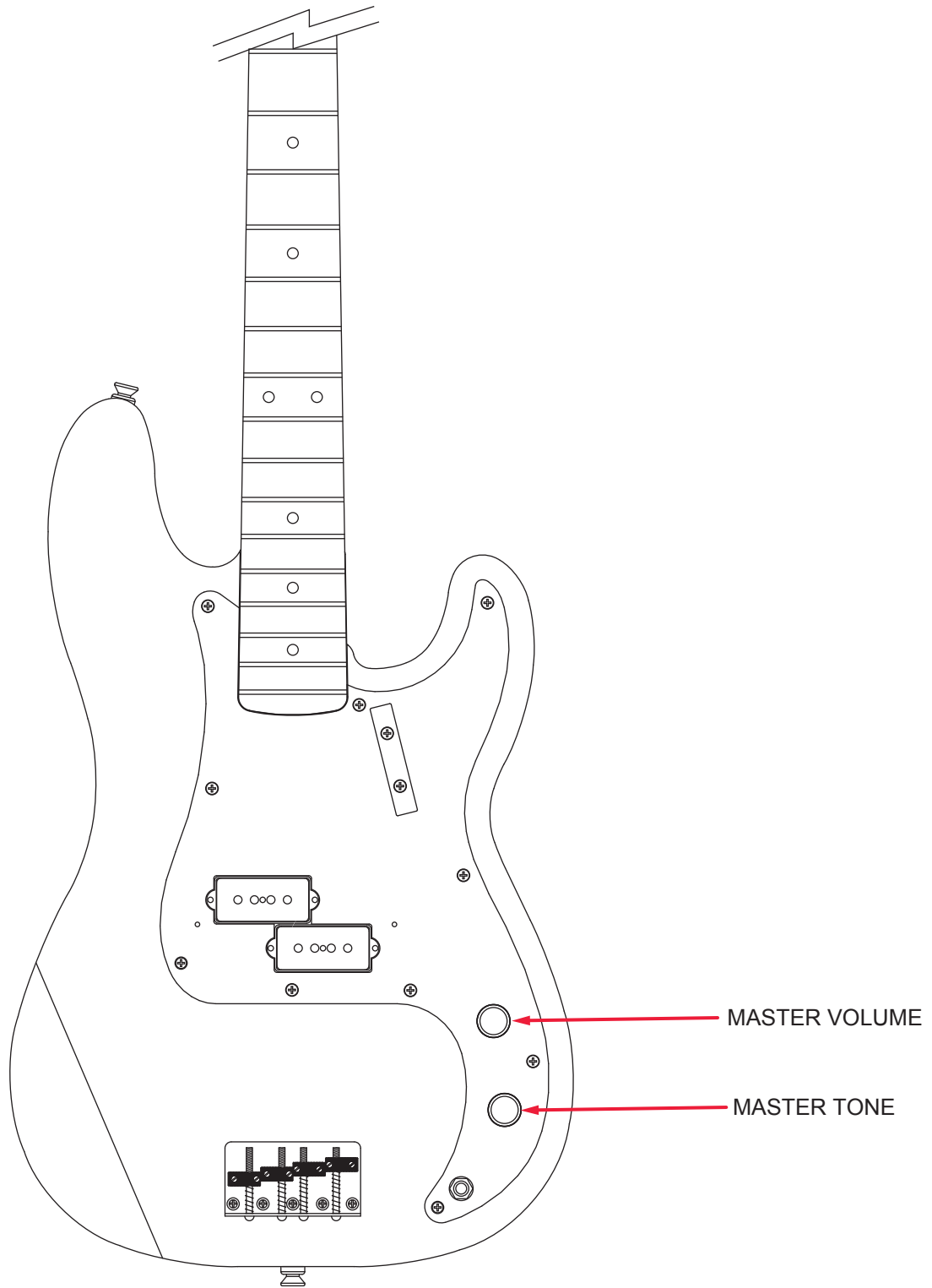

# AMERICAN ORIGINAL 50'S PRECISION BASS® (0190102XXX)

## ADDITIONAL SPECIFICATION DETAIL

**FRET SIZE: VINTAGE**  
(FRET DIMENSIONS ARE BEFORE INSTALLATION)

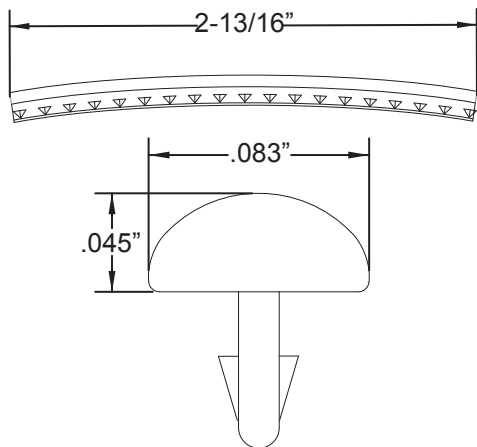

PLEASE NOTE: AS EACH NECK IS SANDED & FINISHED BY HAND, THICKNESS DIMENSIONS MAY VARY SLIGHTLY FROM THOSE SHOWN.

**NECK PROFILE: VINTAGE "C"**

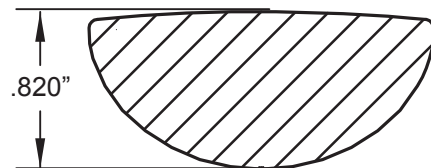

1ST FRET PROFILE

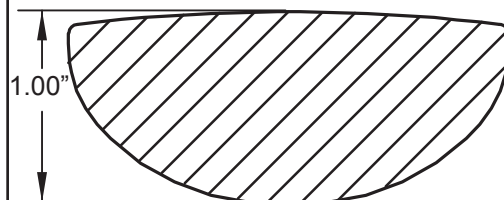

12TH FRET PROFILE

**STAGGERED TUNING MACHINES SET: P/N 0078834000**  
**OUTER SHAFT DIAMETER .552"**

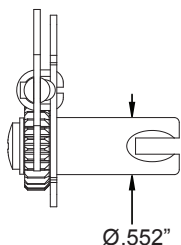

**TUNING MACHINE THRU-HOLE**  
**INNER DIAMETER .730"**

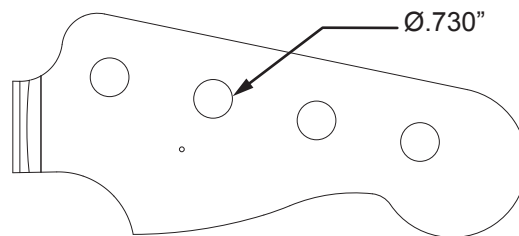

**SADDLE HEIGHT ADJUSTMENT SCREWS: P/N 0016105049**

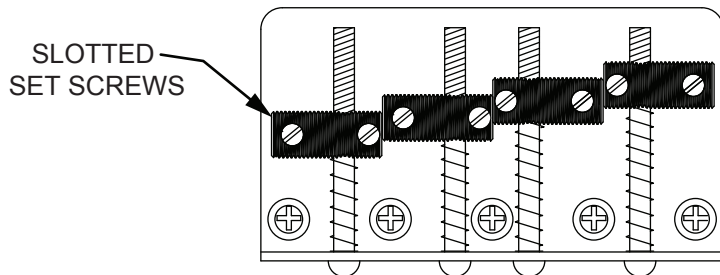

**TRUSS ROD ADJUSTMENT NUT:**  
**P/N 0994944000**



10-32  
THREAD

**LOGO: VINTAGE P-BASS**  
**APPLIED OVER THE FINISH**



### PICKUP SPECIFICATIONS

POSITION	MAGNETS	DC RESISTANCE	POLARITY
NECK	ALNICO 5 UNBEVELED	4.9 - 5.5KΩ	SOUTH
BRIDGE	ALNICO 5 UNBEVELED	4.9 - 5.5KΩ	NORTH