

AMERICAN ORIGINAL 50'S STRATOCASTER® (0110112XXX)

PARTS LAYOUT

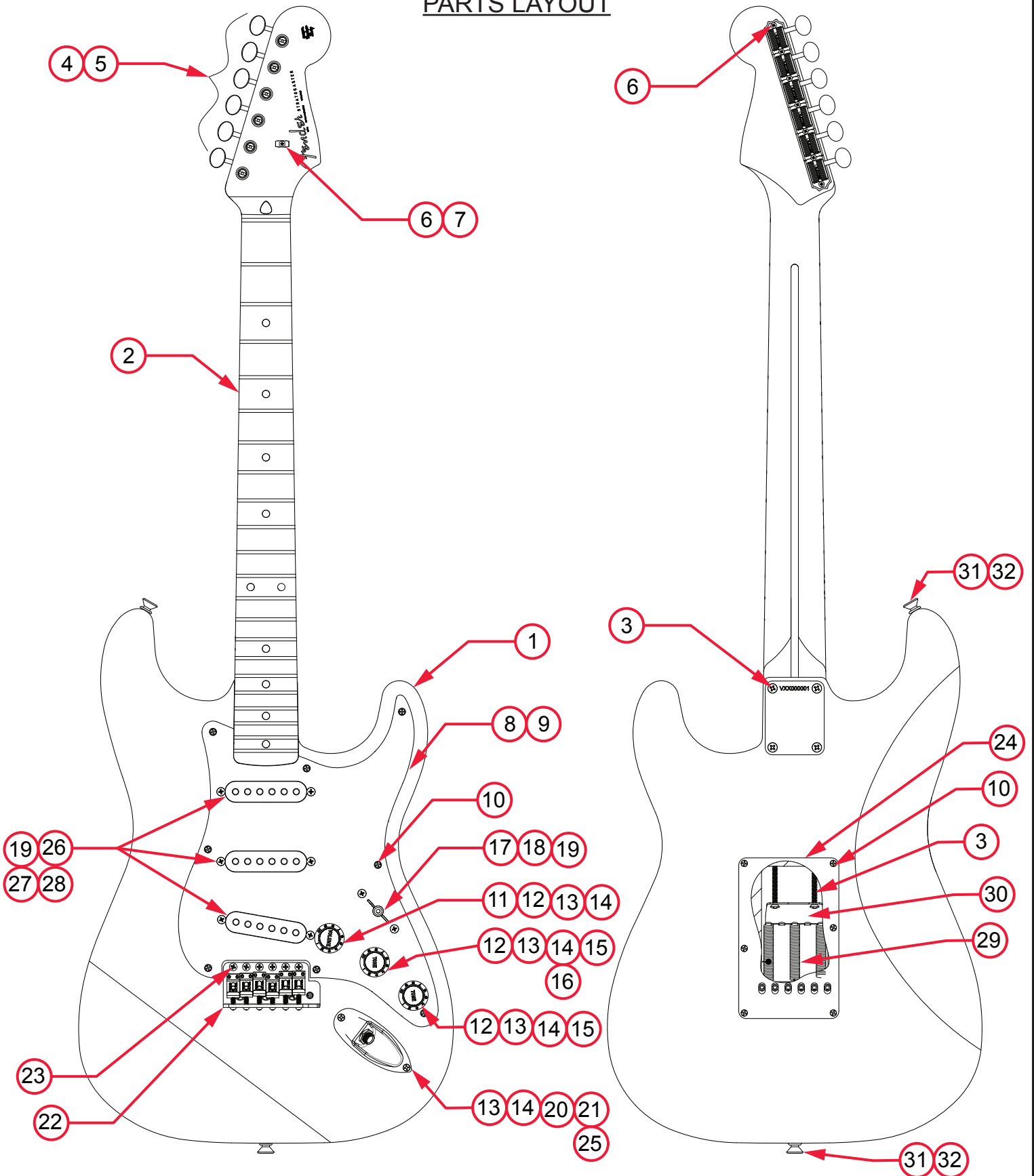

AMERICAN ORIGINAL 50'S STRATOCASTER® (0110112XXX)

PARTS LIST

REF#	DESCRIPTION	PART NUMBER
1	BODY AM ORIGINAL 50'S STRAT WBL	7711107501
1	BODY AM ORIGINAL 50'S STRAT 2TSB	7711104503
1	BODY AM ORIGINAL 50'S STRAT AZG	7711105578
2	NECK ASSY AM ORIGINAL 50'S STRAT MPL	7710898000
3	SCREW 8 X 2 OHP STL NI	0058060049
4	KEY GTR NI FENDER LOGO SET	0091059060
5	BUSHING STRING POST VINT	0994946000
6	SCREW SMAB 3 X 3/8 RHP NI	0011357049
7	STRING TREE VINTAGE NI	0992083000
8	PICKGUARD VINT STRAT EGGSHELL	0094245049
9	SHIELD ALUM VINTAGE STRAT	0019640049
10	SCREW SMAB 4 X 1/2 OHP NI	0015578049
11	KNOB STRAT VOL EGGSHELL WHT	0093600000
12	CONTROL 250K 10% TPR SPLIT	0990830000
13	NUT HEX 3/8-32 X 3/32 TK NI	0016352049
14	WASHER LOCK INTL 3/8 X .687	0016436049
15	KNOB STRAT TONE EGGSHELL WHT	0093601000
16	CAP WAX PAPER .10 MFD 150V	0096453049
17	SWITCH 5-WAY LEVER	0038929049
18	SWITCH TIP STRAT EGGSHELL WHT	0093597060
19	SCREW M 6-32 X 5/8 OHP NI	0015776049
20	FERRULE JACK CHROME	0991940100
21	JACK PHONE OPEN CIRCT 11	0021956000
22	BRIDGE ASSY AM VINT STRAT CHR RH	0094247049
22A	BRIDGE PLATE VINTAGE STRAT	0019470000
22B	BRIDGE BLOCK VINTAGE STRAT	0019473000
22C	BRIDGE SECTION ASSY AM VINTAGE NI TALL	0093568102
22D	BRIDGE SECTION ASSY AM VINTAGE NI SHORT	0093568101
22E	SCREW M 4-40 X 5/8 RHP NI	0015693049
22F	SPRING BRIDGE 7/16 9 COIL	0094278000
22G	SPRING BRIDGE #1932	0019281049
22H	SPRING BRIDGE 3/8 7 COIL	0094277000
22I	SCREW M 8-32 X 3/8 FHP NI	0019656049
23	SCREW WD RD PH 6 X 1-1/8 NI	0016170049
24	PLATE BACK VINT STRAT EGGSHELL	0094248049
25	SCREW SMA 5 X 5/8 OHP NI	0015602049

*= NOT PICTURED IN DIAGRAM



AMERICAN ORIGINAL 50'S STRATOCASTER® (0110112XXX)

REF#	DESCRIPTION	PART NUMBER
26	PICKUP ASSY 59 STRAT EGGSHELL	0094005050
27	COVER PICKUP AM VINT STRAT EGGSHELL	0094252051
28	TUBING LATEX CUT .300 X 1/8 X 1/4	0994916000
29	SPRING .150 OD 1/2" LONG .039"	0994931000
30	CLAW SPRING TENSION ZINC	0010272100
31	BUTTON STRAP NI .156	0994915000
32	SCREW WOOD 6 X 1 OHP NIV	0016188049
*	CASE STRAT/TELE TWEED	0047366011
*	ARM TREMOLO VINT STRAT PLATED	0992039000
*	KNOB TREMOLO ARM EGGSHELL	0094282049
*	WRENCH .050 HEX KEY SHORT ARM (SADDLE HEIGHT ADJUSTMENT)	0018531049

*= NOT PICTURED IN DIAGRAM



AMERICAN ORIGINAL 50'S STRATOCASTER® (0110112XXX)

WIRING ASSEMBLY

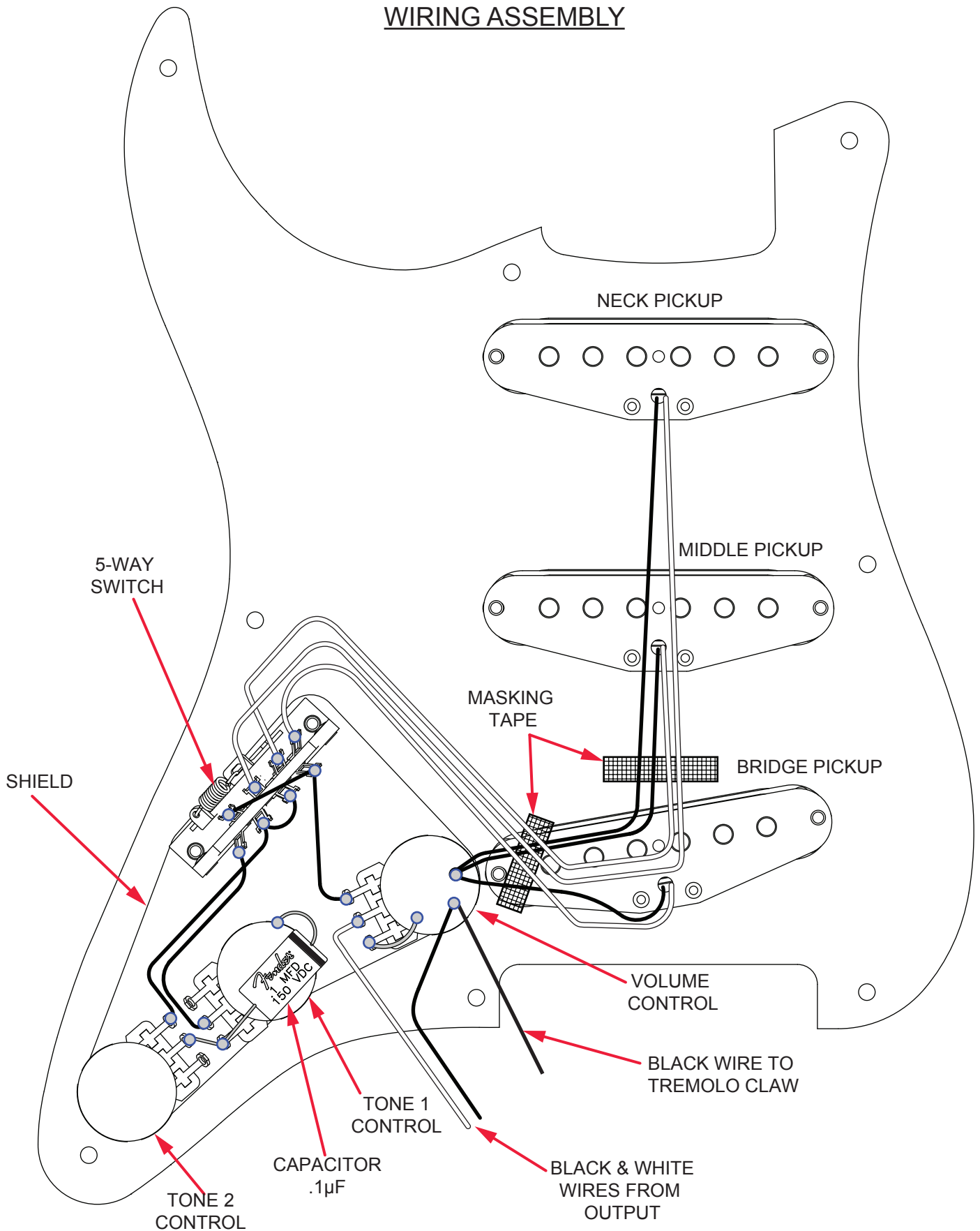

AMERICAN ORIGINAL 50'S STRATOCASTER® (0110112XXX)

SWITCH AND CONTROL FUNCTION

5 WAY SWITCH POSITION					
					SWITCH POSITION
T1	T1 & T2	T2	T2	T2	← TONE CONTROL
					← NECK PICKUP
					← MIDDLE PICKUP
					← BRIDGE PICKUP
PICKUP IS ON PICKUP IS OFF				INDICATES POSITION OF 5 WAY SWITCH	

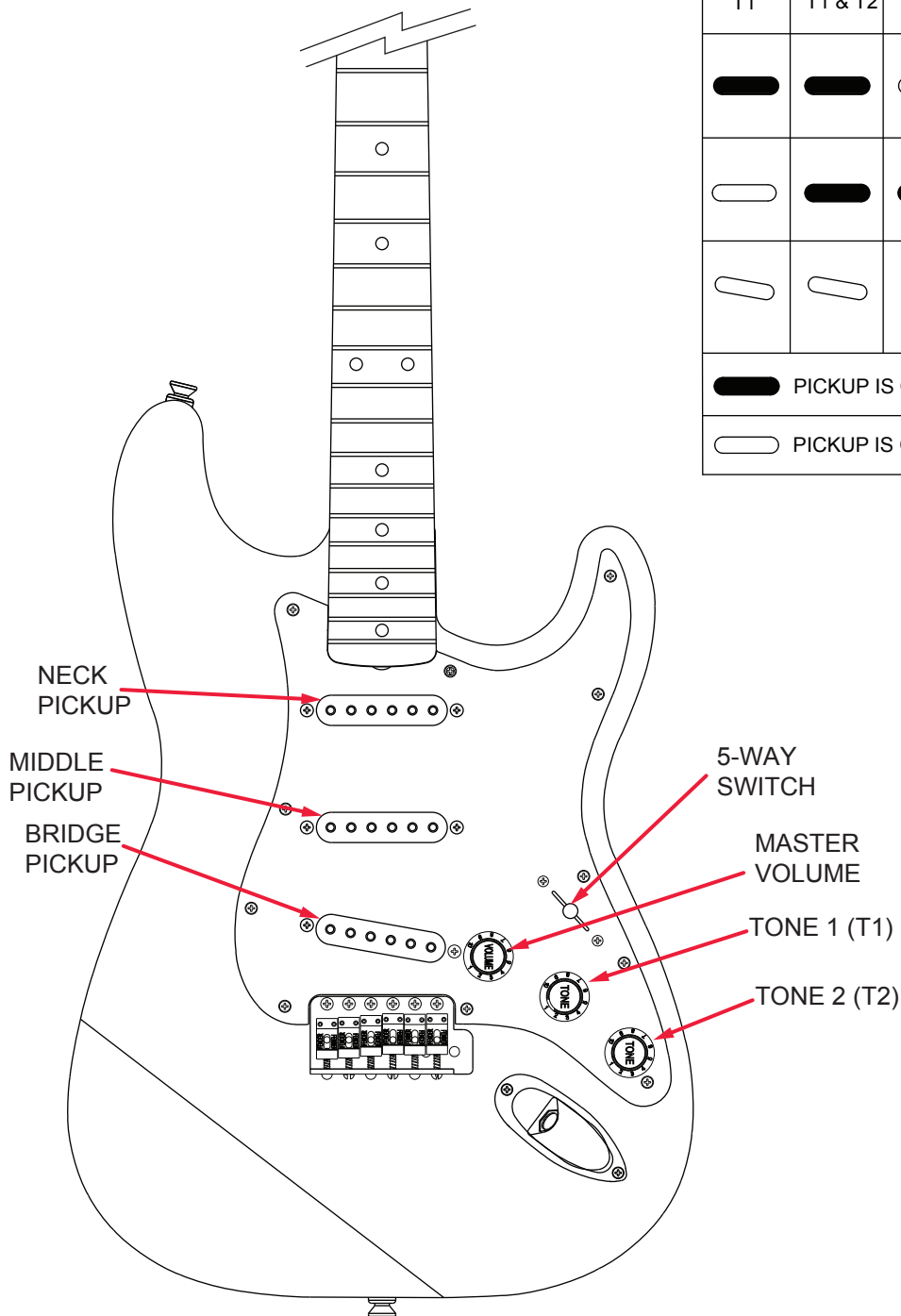

AMERICAN ORIGINAL 50'S STRATOCASTER® (0110112XXX)

ADDITIONAL SPECIFICATION DETAIL

FRET SIZE: VINTAGE
(FRET DIMENSIONS ARE BEFORE INSTALLATION)

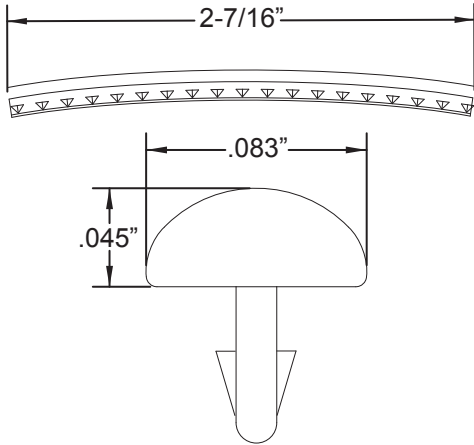

PLEASE NOTE: AS EACH NECK IS SANDED & FINISHED BY HAND, THICKNESS DIMENSIONS MAY VARY SLIGHTLY FROM THOSE SHOWN.

NECK PROFILE: SOFT "V"

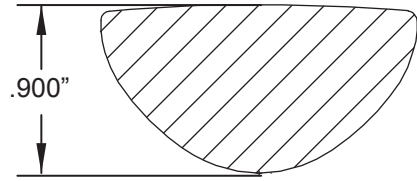

1ST FRET PROFILE

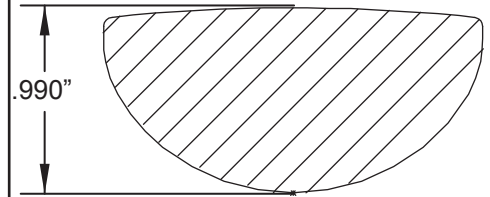

12TH FRET PROFILE

STAGGERED TUNING MACHINE SET W/HDWR P/N 0992074000

OUTER SHAFT DIAMETER .250"

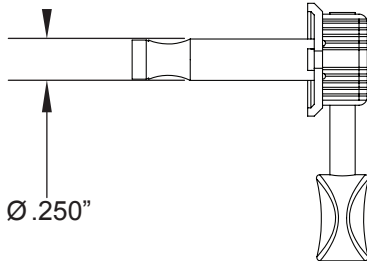

TUNING MACHINE THRU-HOLE

INNER DIAMETER .261"

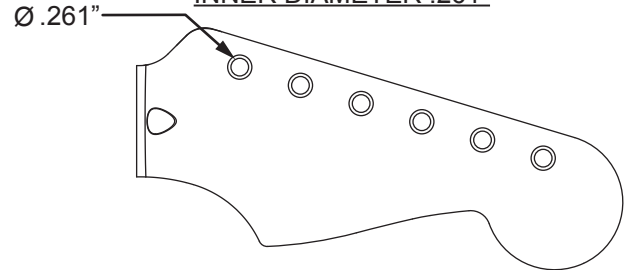

SADDLE HEIGHT ADJUSTMENT WRENCH:

.050" HEX KEY P/N 0018531049

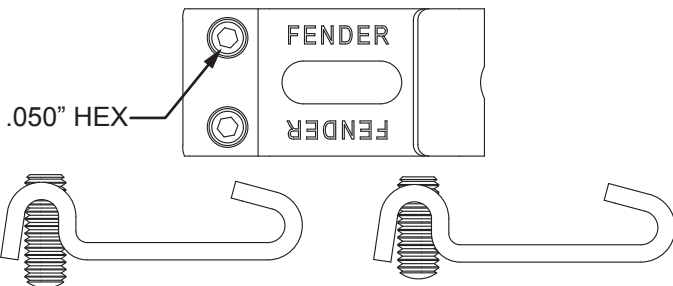

SADDLE HEIGHT ADJUSTMENT SCREWS:

TALL: P/N 0075384000 SHORT: P/N 0075536000

TRUSS ROD NUT P/N 0994944000

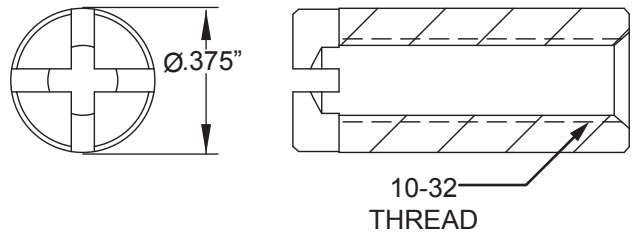

LOGO: VINTAGE STRATOCASTER

APPLIED OVER THE FINISH



PICKUP SPECIFICATIONS

POSITION	MAGNETS	DC RESISTANCE	POLARITY
NECK	ALNICO 5 UNBEVELED	5.2 - 6.4KΩ	NORTH
MIDDLE	ALNICO 5 UNBEVELED	5.2 - 6.4KΩ	NORTH
BRIDGE	ALNICO 5 UNBEVELED	5.2 - 6.4KΩ	NORTH