

# AMERICAN ORIGINAL 60'S JAZZMASTER (0110150XXX)

## PARTS LAYOUT

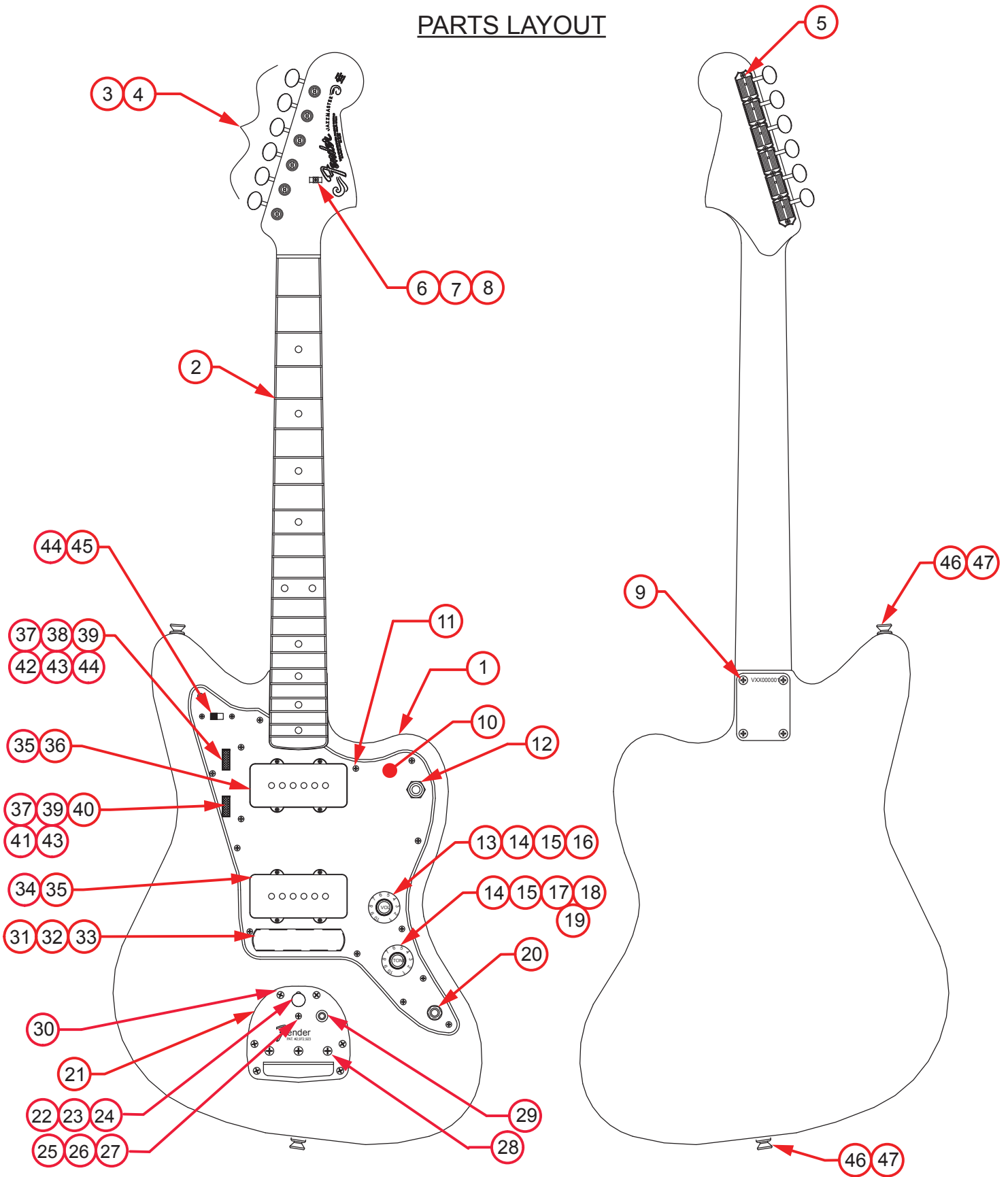

# AMERICAN ORIGINAL 60'S JAZZMASTER (0110150XXX)

## PARTS LIST

REF#	DESCRIPTION	PART NUMBER
1	BODY VINT 65 JAZZMASTER 3TSB	7711784500
1	BODY VINT 65 JAZZMASTER OWT	7711785505
1	BODY VINT 65 JAZZMASTER OCT	7711785508
2	NECK ASSY AM ORIGINAL 60'S JAZZMASTER RW	7710904000
3	KEY SET GTR VINT FENDER DLX NI	0091059060
4	BUSHING STRING POST VINT	0994946000
5	SCREW SMAB 3 X 3/8 RHP NI	0011357049
6	STRING TREE VINTAGE NI	0093569000
7	STRING TREE SPACER 65 STRAT NYLON	0093999000
8	SCREW SMA 3 X 5/8 RHP NI	0011358049
9	SCREW SMA 8 X 1-3/4 OHP NI	0015636049
10	PICKGUARD VINT JAZZMASTER BRN SHELL	0094459000
10	PICKGUARD VINT JAZZMASTER GOLD ANODIZED	7711563000
11	SCREW SMAB 4 X 1/2 OHP NI	0015578049
12	SWITCH 3 POS TOGGLE W/AGED WHITE KNOB & HDWR	0053694000
13	CONTROL SOLID SHAFT 1 MEG LINEAR	0095704000
14	NUT HEX 3/8-32 X 3/32 TK NI	0016352049
15	WASHER INT LOCK .035 X 3/8 NI	0056790000
16	KNOB 65 JAZZMASTER VOL WHITE	0094003000
17	CONTROL 1 MEG 10%	0019066000
18	KNOB 65 JAZZMASTER TONE WHITE	0094002000
19	CAPACITOR CERAMIC DISC .1µF 50V	0094393000
20	JACK PHONE OPEN CIRCUIT 11	0021956049
21	TREMOLO ASSY JAGUAR / JAZZMASTER	0054466000
21A	BASE PLATE TREMOLO JAGUAR / JAZZMASTER	0054467000
*21B	GUIDE PLATE TREMOLO JAGUAR / JAZZMASTER	0054470000
*21C	SCREW M 8-32 X 1/4 UHFP NI	0015891049
*21D	FLOATING TREMOLO PLATE TAIL PIECE	0054468000
*21E	TAILPIECE STIFFENER PLATE TREMOLO JAGUAR / JAZZMASTER	0054469000
22	CHROME LOCK BUTTON TREMOLO	0054474000
*23	WAVE WASHER #6 .170 ID X .385 OD	0054476000
*24	LOCK NUT TREMOLO / LOCK STOP	0054475000
25	SCREW M 8-32 X 1-1/4 PHP NI	0015966000
*26	TREMOLO ACTION SPRING .080 X 6 CO	0019307000
*27	SPRING PERCH TREMOLO	0024992000
28	SCREW M 8-32 X 1/4 THP NI	0015891049
29	TREMOLO ARM SLEEVE / INSERT	0054471000

\*= NOT PICTURED IN DIAGRAM



## AMERICAN ORIGINAL 60'S JAZZMASTER (0110150XXX)

REF#	DESCRIPTION	PART NUMBER
30	SCREW SMAB 5 X 1 OHP NI	0015610049
*31	BRIDGE ASSY ADJUSTABLE JAGUAR / JAZZMASTER	0054460000
31A	CHANNEL AND POST BRIDGE PLATE JAGUAR / JAZZMASTER	0054519000
31B	SCREW ST 4-40 X 1/2 OC CN PT	0056157049
31C	SCREW M 4-40 X 5/8 RHP NI	0015693049
31D	SPRING BRIDGE #1932	0019281049
31E	SPRING INTONATION ADJ 7 COIL	0056139000
31F	SPRING INTONATION ADJ 6 COIL NI	0056138000
31G	SADDLE BAR 1/4-24ADJ BRIDGE	0054463000
31H	SADDLE BAR 1/4-28 ADJ BRIDGE	0054464000
31I	SCREW SET 4-40 X 5/16 HEX SKT OP NI	0016089049
31J	SCREW ST 4-40 X 1/4	0040196049
32	COVER ADJUSTABLE BRDG JAGUAR/JAZZMASTER	0054465000
*33	THIMBLE BRIDGE POST JAGUAR/JAZZMASTER	0054447049
34	PICKUP ASSY 65 JAZZMASTER BRIDGE VINT WHT	0094012000
35	SCREW WOOD RND HD 3 X 1 NI	0016295049
36	PICKUP ASSY 65 JAZZMASTER NECK VINT WHT	0094013000
37	KNOB DISC PRESET CONTROL 1" X .25	0054455000
*38	CONTROL MINIPOT 1 MEG LINEAR W/NUT	0054457000
*39	WASHER LOCK INTERNAL TOOTH 1/4	0016451000
*40	CONTROL MINIPOT 50K LINEAR W/NUT	0054458000
*41	CAP CD X-TYPE .02µF 400VAC	0054459000
*42	BRACKET CONTROL MTG JAZZMASTER	0054454000
*43	WASHER LOCK INTERNAL TOOTH 1/4	0016451000
44	SCREW M 4-40 X 1/4 OHP NI	0015719049
45	SWITCH SLIDING BLACK KNOB	0017079000
46	STRAP BUTTON NI .156	0994915000
47	SCREW WOOD 6 X 1 OHP NI	0016188049
*	CASE JAG/JAZZMASTER BROWN	0054517011
*	TREMOLO ARM 62 JAGUAR / JAZZMASTER NO TIP	0054473000
*	TREMOLO KNOB VINTAGE AGED	0994933000
*	COVER ADJUSTABLE BRIDGE JAGUAR / JAZZMASTER	0054465000
*	WRENCH .050 HEX KEY SHORT ARM (SADDLE & BRIDGE HEIGHT ADJUSTMENT)	0018531049

\*= NOT PICTURED IN DIAGRAM



# AMERICAN ORIGINAL 60'S JAZZMASTER (0110150XXX)

## WIRING ASSEMBLY

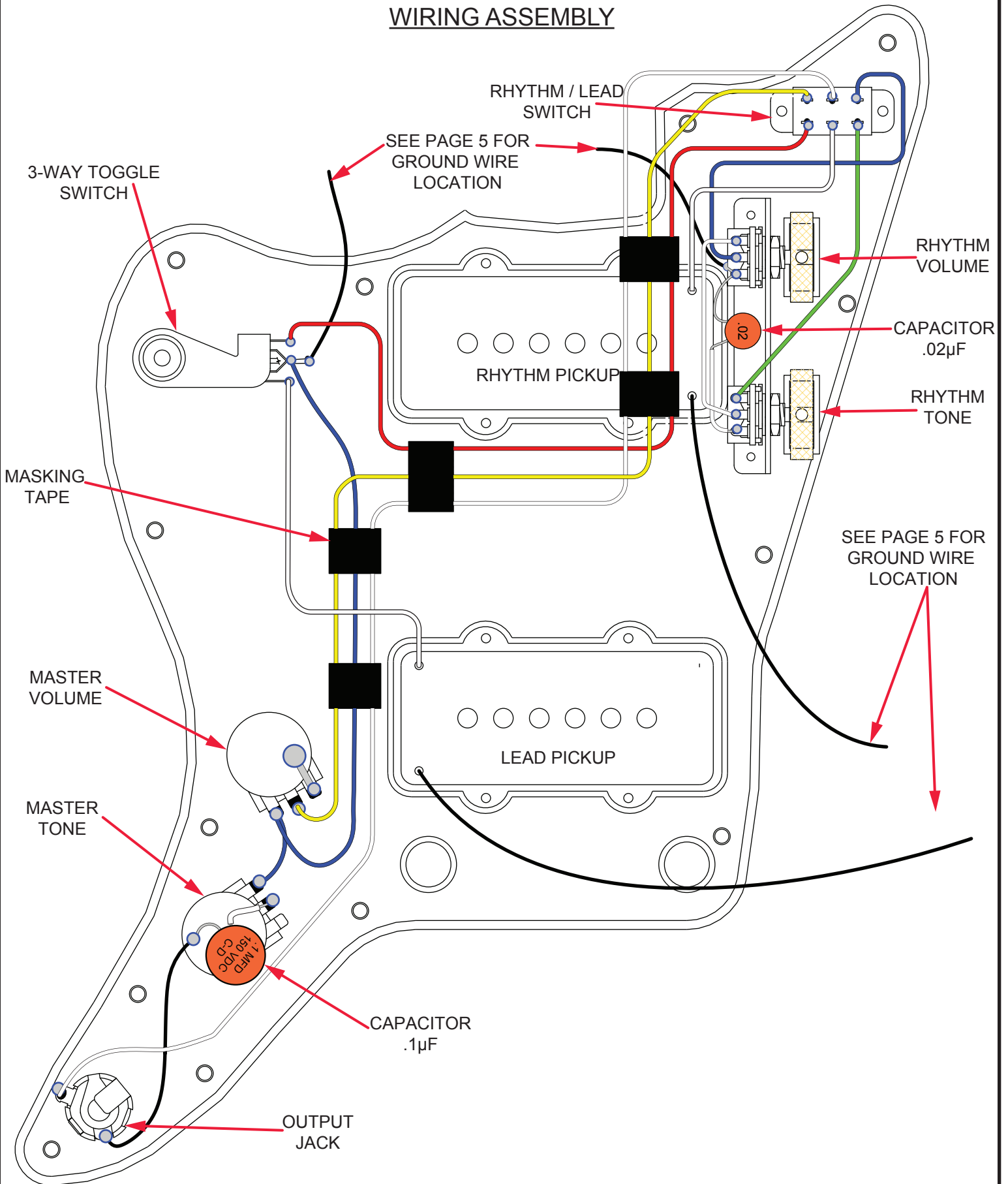

# AMERICAN ORIGINAL 60'S JAZZMASTER (0110150XXX)

## WIRING ASSEMBLY

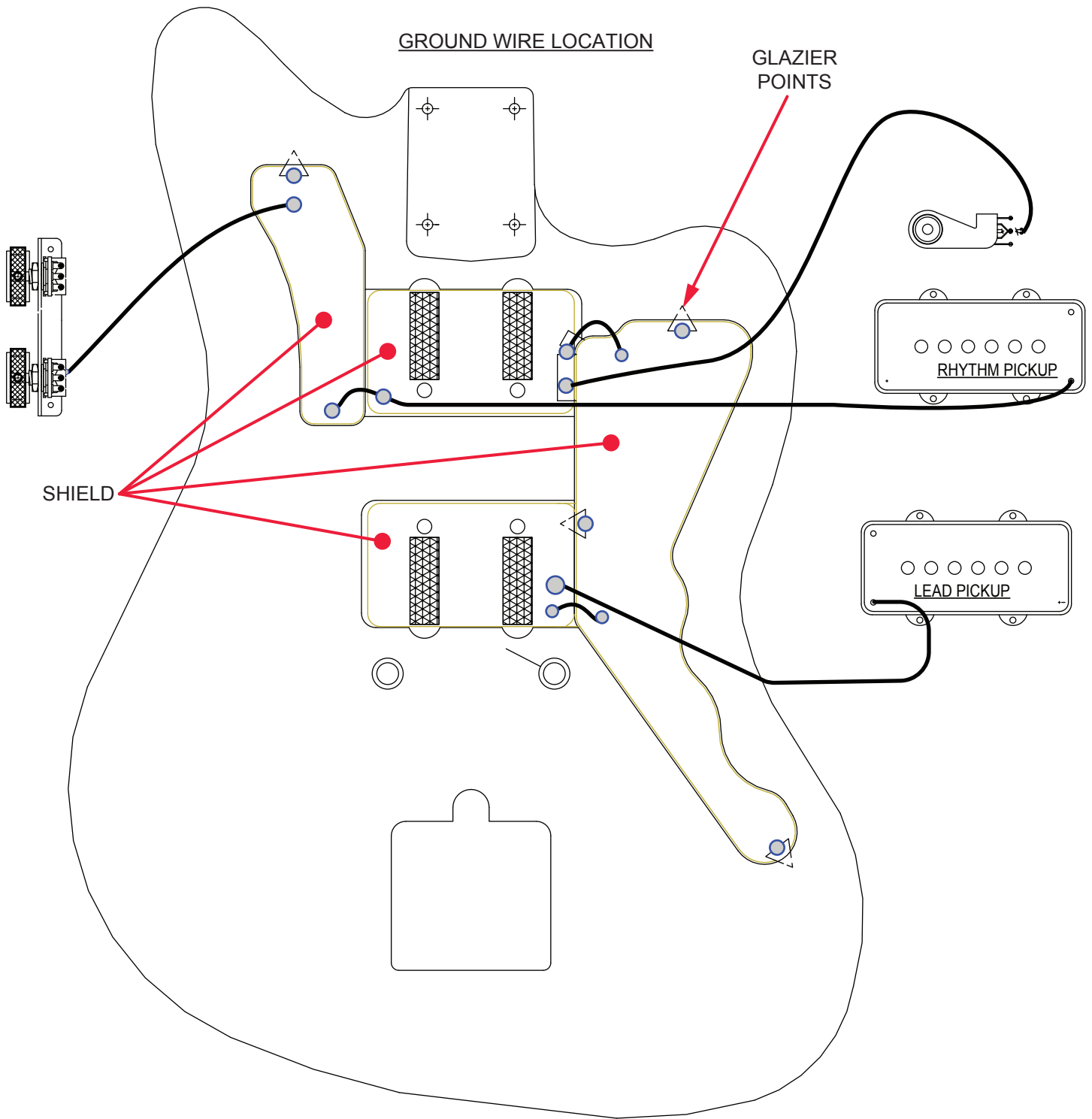

# AMERICAN ORIGINAL 60'S JAZZMASTER (0110150XXX)

## SWITCH AND CONTROL FUNCTION

3 WAY SWITCH POSITION			
NOTE: OPERATIONAL ONLY WHEN RHYTHM/LEAD SWITCH IS IN LEAD POSITION			
			← 3 WAY SWITCH POSITION
			← RHYTHM PICKUP
			← LEAD PICKUP
	PICKUP IS ON	INDICATES POSITION OF 3 WAY SWITCH	
	PICKUP IS OFF		

**NOTE:** ONLY RHYTHM PICKUP IS FUNCTIONAL WHEN RHYTHM/LEAD SWITCH IS IN RHYTHM POSITION (LEAD PICKUP IS OFF)

**RHYTHM/LEAD SWITCH**

RHYTHM

LEAD

**RHYTHM VOLUME**

**RHYTHM TONE**

THESE FUNCTIONS ARE FOR RHYTHM PICKUP ONLY, AND ONLY WHEN SWITCH IS IN RHYTHM POSITION

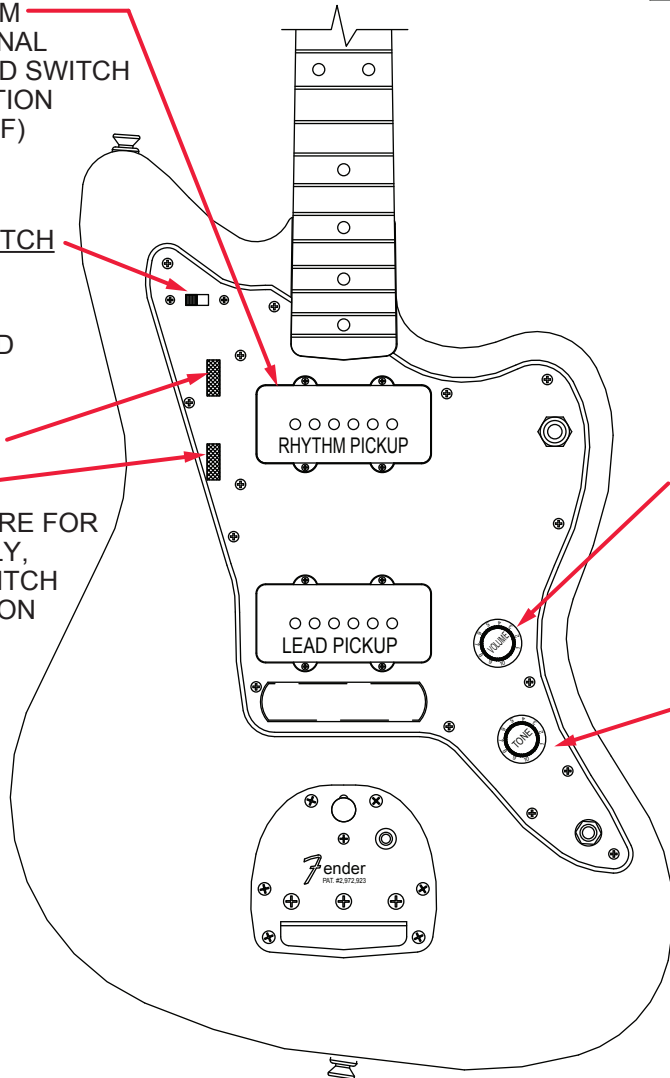

**MASTER VOLUME**

WHEN RHYTHM/LEAD SWITCH IS IN LEAD POSITION (NON-FUNCTIONAL IN RHYTHM POSITION)

**MASTER TONE**

WHEN RHYTHM/LEAD SWITCH IS IN LEAD POSITION (NON-FUNCTIONAL IN RHYTHM POSITION)

# AMERICAN ORIGINAL 60'S JAZZMASTER (0110150XXX)

## ADDITIONAL SPECIFICATION DETAIL

FRET SIZE: VINTAGE  
(FRET DIMENSIONS ARE BEFORE INSTALLATION)

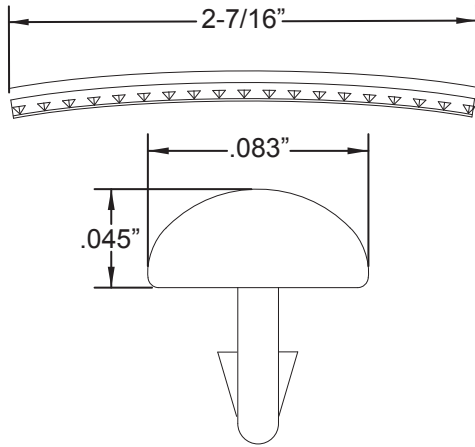

PLEASE NOTE: AS EACH NECK IS SANDED & FINISHED BY HAND, THICKNESS DIMENSIONS MAY VARY SLIGHTLY FROM THOSE SHOWN.

NECK PROFILE: MID 60'S "C"

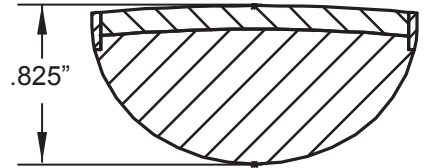

1ST FRET PROFILE

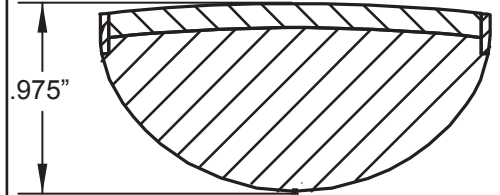

12TH FRET PROFILE

STAGGERED TUNING MACHINE SET W/HDWR P/N 0992074000  
OUTER SHAFT DIAMETER .250"

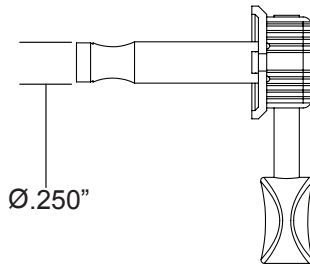

TUNING MACHINE THRU-HOLE  
INNER DIAMETER .261"

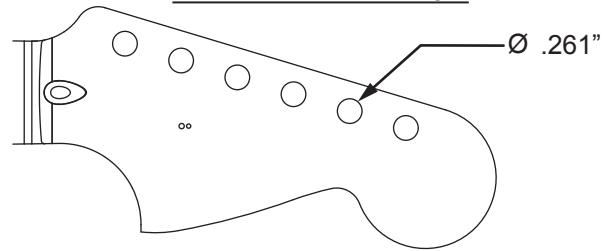

BRIDGE/SADDLE HEIGHT ADJUSTMENT WRENCH:  
.050" HEX KEY P/N 0018531049

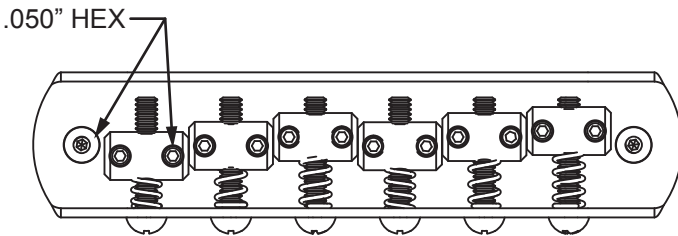

TRUSS ROD NUT P/N 0058171000

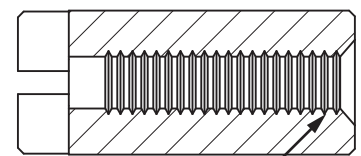
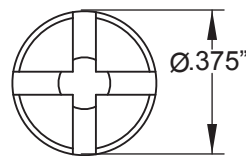

8-32  
THREAD

LOGO: VINTAGE 65 JAZZMASTER  
APPLIED OVER THE FINISH



PICKUP SPECIFICATIONS

POSITION	MAGNETS	DC RESISTANCE	POLARITY
NECK	ALNICO 5 UNBEVELED	6.1 - 7.5KΩ	NORTH
BRIDGE	ALNICO 5 UNBEVELED	6.1 - 7.5KΩ	SOUTH

