

AMERICAN ORIGINAL 70'S JAZZ BASS® (0190142XXX)

PARTS LAYOUT

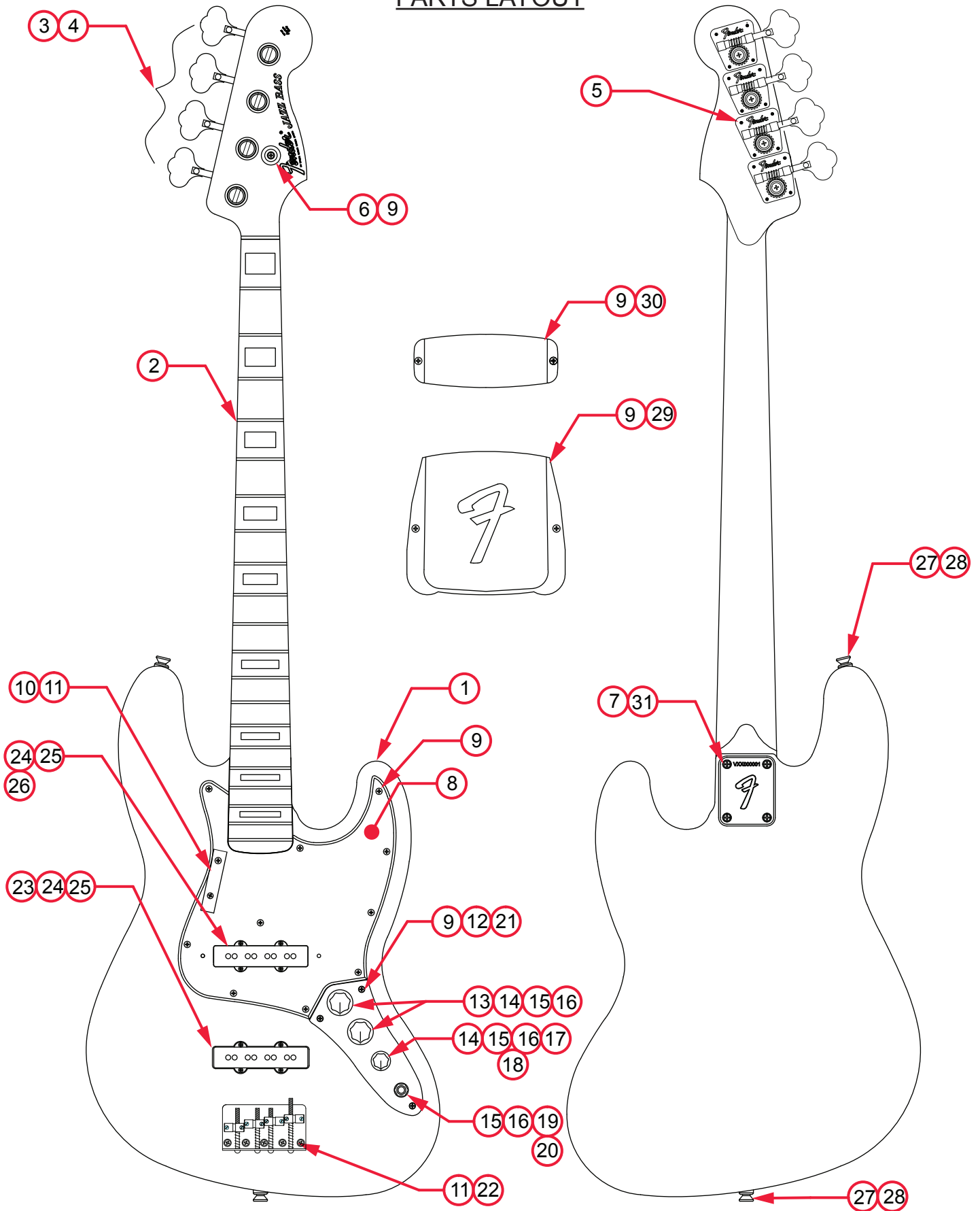

AMERICAN ORIGINAL 70'S JAZZ BASS® (0190142XXX)

PARTS LIST

REF#	DESCRIPTION	PART NUMBER
1	BODY AM ORIGINAL 70'S J-BASS 3TSB	7710959500
1	BODY AM ORIGINAL 70'S J-BASS BLK	7710959506
1	BODY AM ORIGINAL 70'S J-BASS NAT	7710959521
2	NECK AM ORIGINAL 70'S J-BASS MPL	7710960000
3	KEYS BASS VINTAGE 70'S SET W/BUSHING	0076568049
4	BUSHINGS BASS KEY CHROME SET	0076569049
5	SCREW SMAB 3 X 3/8 RHP NI	0011357049
6	STRING GUIDE DISC BASS	0994913000
7	SCREW SMA 8 X 1-3/4 OHP NI	0015636049
8	PICKGUARD 75 J-BASS W/B/W	0055232000
8	PICKGUARD 75 J-BASS B/W/B	0055252000
9	SCREW SMAB 4 X 1/2 OHP NI	0015578049
10	THUMB REST	0992036000
11	SCREW SMAB 5 X 1 OHP NI	0015610049
12	CONTROL PLATE VINT JAZZ BASS CHROME	0096216000
13	VINT J-BASS SKIRTED KNOBS (1 SMALL 2 LARGE)	0992085000
*14	CONTROL 250K 10%	0990831000
*15	NUT HEX 3/8-32 X 3/32 TK NI	0016352049
*16	WASHER LOCK INTL 3/8 X .687	0016436049
17	VINT J-BASS SKIRTED KNOBS (1 SMALL 2 LARGE)	0992085000
*18	CAPACITOR CERAMIC .05µF 50V	0094251000
19	JACK PHONE OPEN CIRCUIT 11	0021956049
20	WASHER FLAT 3/8 X .614 NI	0031153049
*21	CONTROL SHIELD BLANK	0010694020
22	BRIDGE ASSY AM VINT 74 J-BASS	0096160000
22A	BRIDGE PLATE JAZZ BASS	0010538070
22B	BRIDGE SECTION SINGLE GROOVE	0055258000
22C	SET SCREW 6-32 X 7/16 OVPT SL NI	0016105049
22D	SCREW M 6-32 X 1-1/2 RHP NI	0015842049
22E	SPRING COMPRESSION 1-1/16 #144	0018689049
22F	SCREW M 6-32 X 1-7/8 RHP NI	0043356000
23	PICKUP ASSY 75 J-BASS BRIDGE	0055231000
24	SHIELD PICKUP 62 J-BASS	0019662000
25	PICKUP ASSY 75 J-BASS NECK	0055230000
26	SCREW WD 4 X 1-1/4 RHP NI	0027035049

*= NOT PICTURED IN DIAGRAM



AMERICAN ORIGINAL 70'S JAZZ BASS® (0190142XXX)

WIRING ASSEMBLY

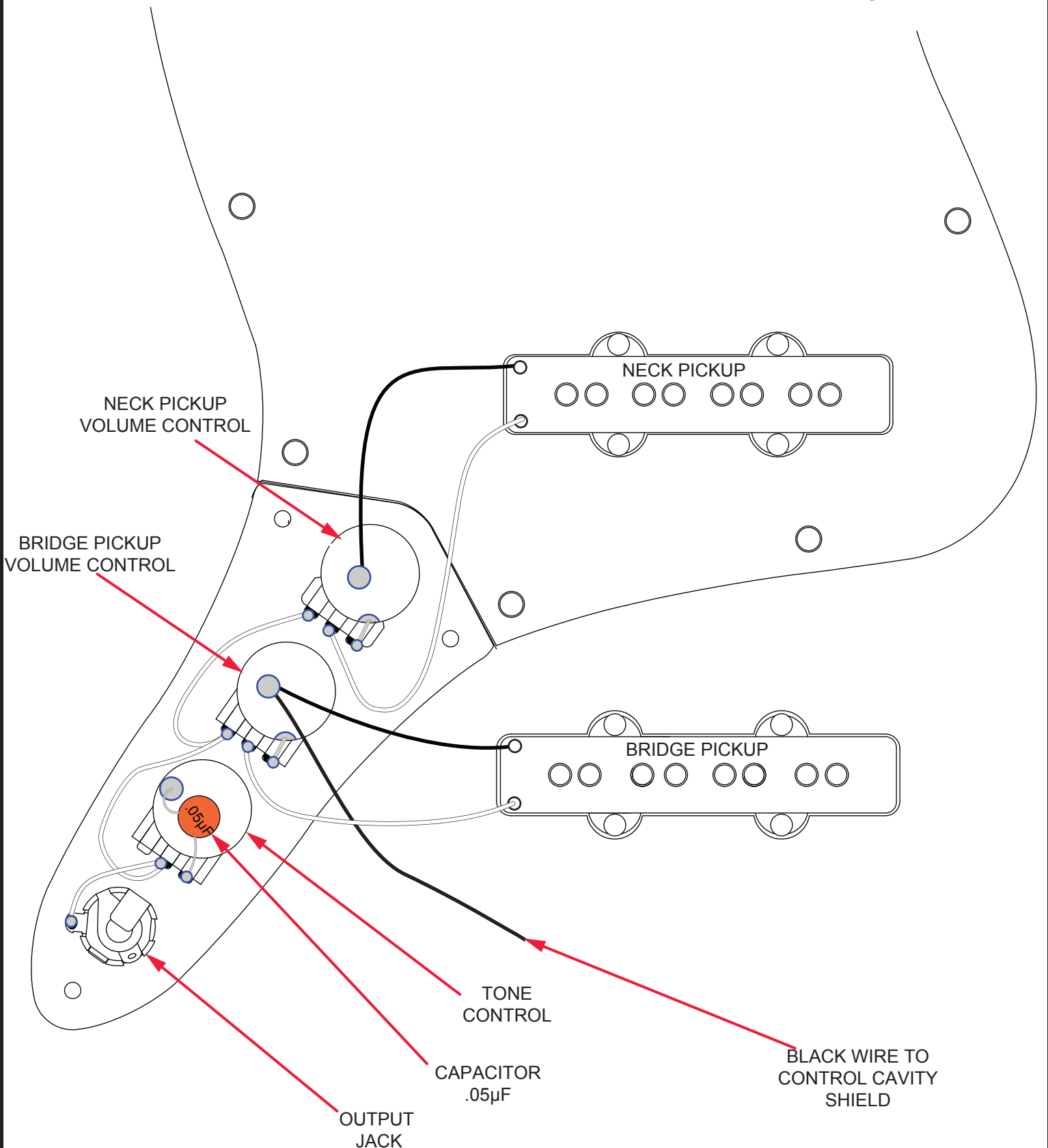

AMERICAN ORIGINAL 70'S JAZZ BASS® (0190142XXX)

GROUNDING LOCATIONS

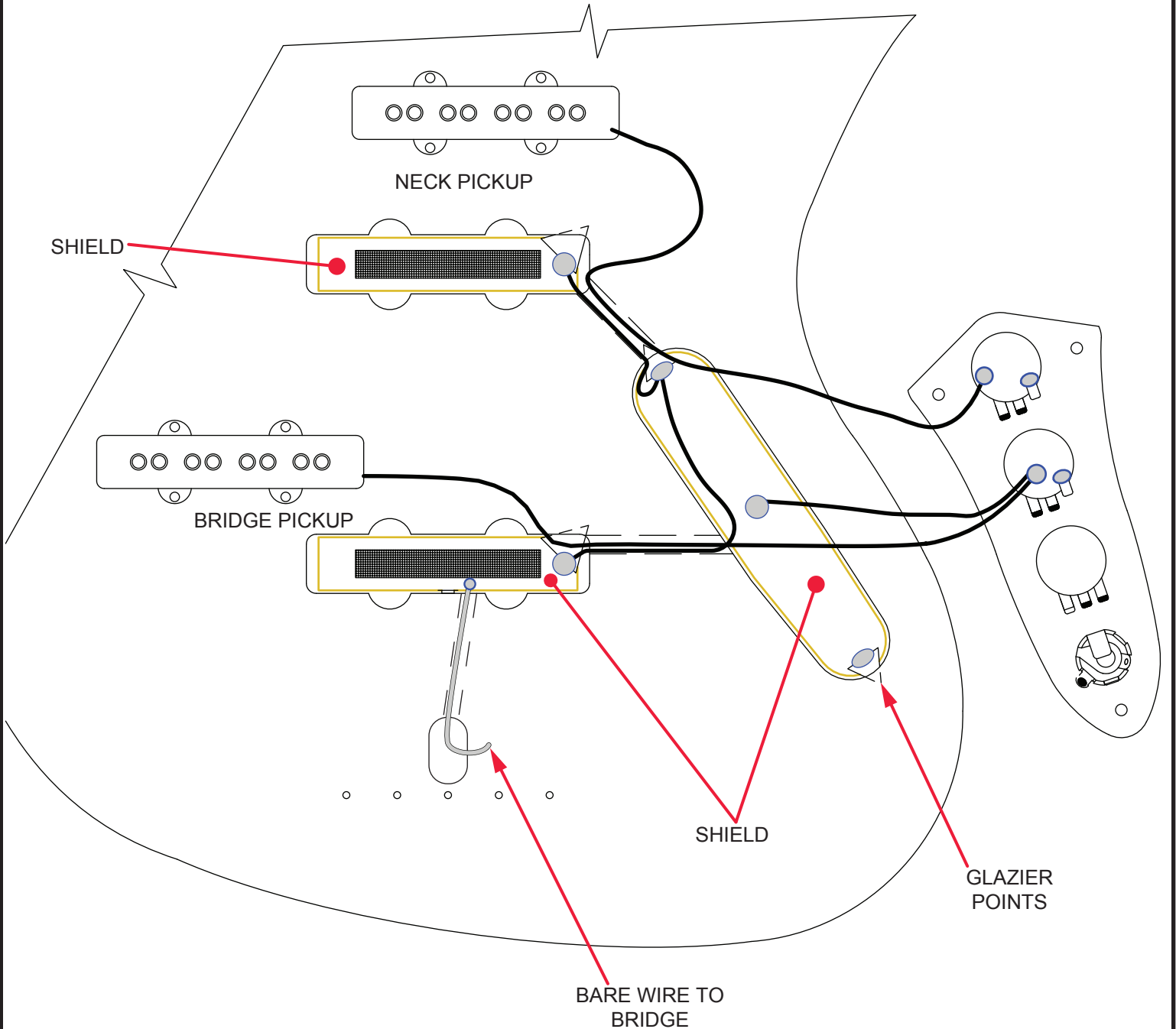

AMERICAN ORIGINAL 70'S JAZZ BASS® (0190142XXX)

SWITCH AND CONTROL FUNCTION

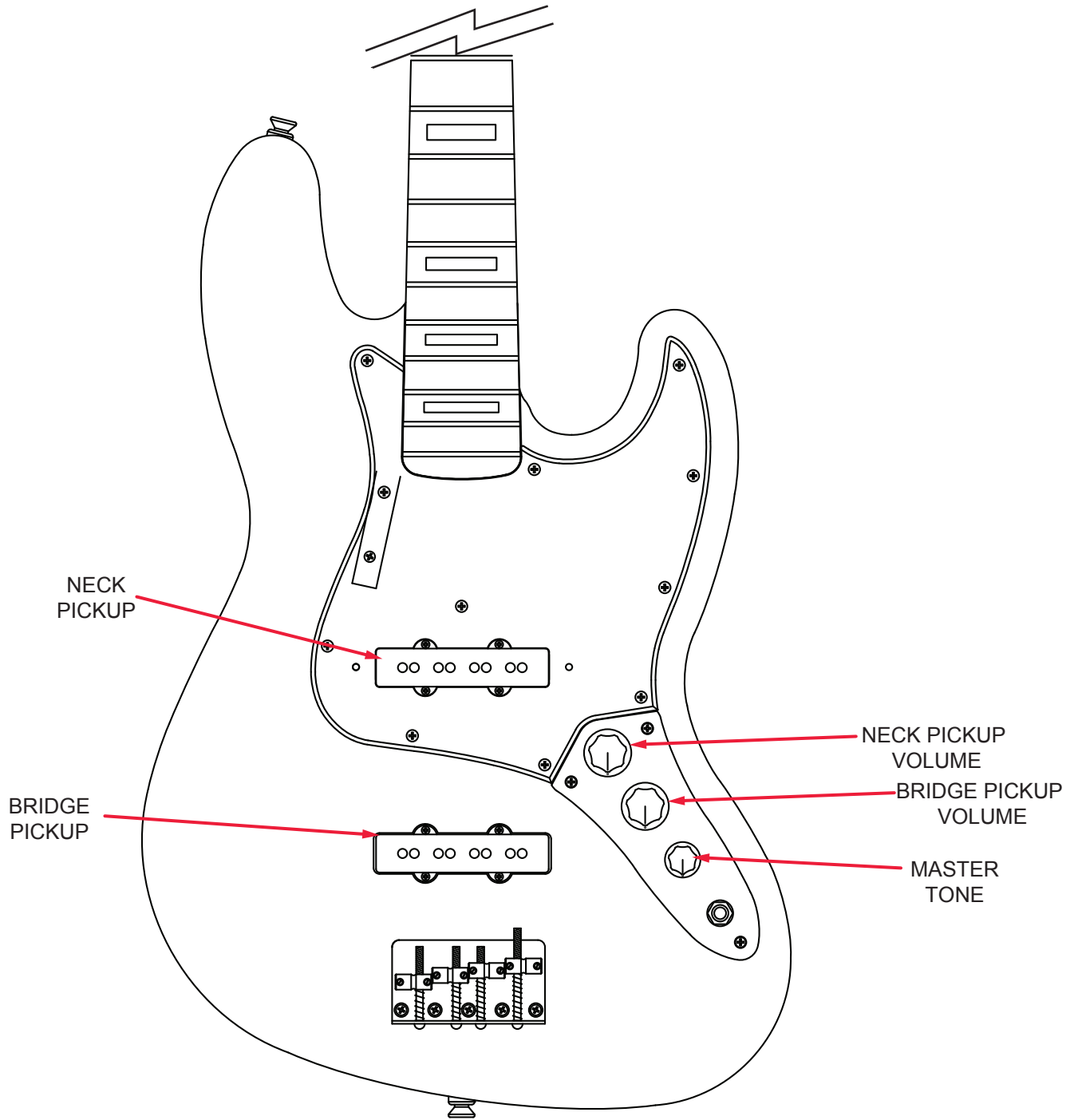

AMERICAN ORIGINAL 70'S JAZZ BASS® (0190142XXX)

ADDITIONAL SPECIFICATION DETAIL

FRET SIZE: VINTAGE
(FRET DIMENSIONS ARE BEFORE INSTALLATION)

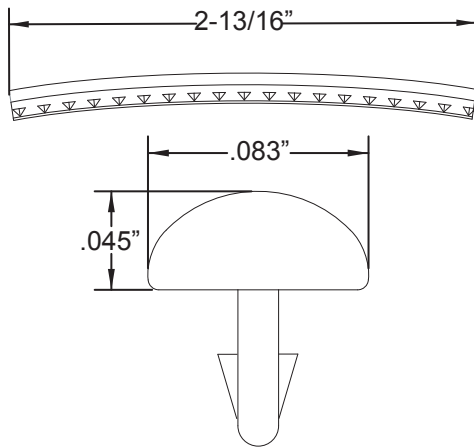

PLEASE NOTE: AS EACH NECK IS SANDED & FINISHED BY HAND, THICKNESS DIMENSIONS MAY VARY SLIGHTLY FROM THOSE SHOWN.

NECK PROFILE: "U" SHAPE

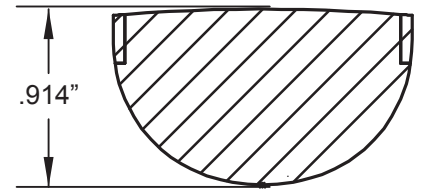

1ST FRET PROFILE

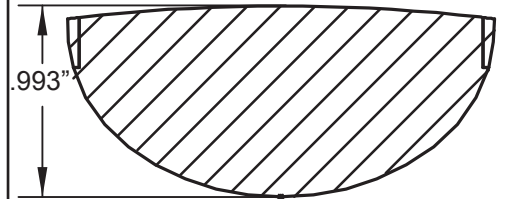

12TH FRET PROFILE

STAGGERED TUNING MACHINES SET: P/N 0076568049
OUTER SHAFT DIAMETER .551"

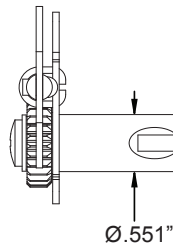

TUNING MACHINE THRU-HOLE
INNER DIAMETER .675"

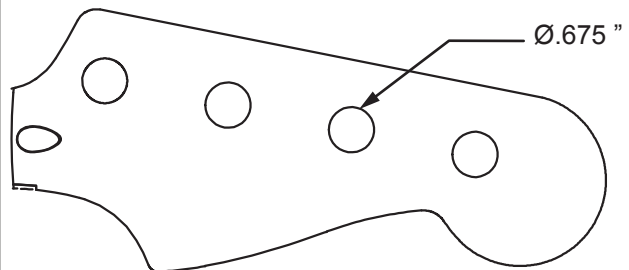

SADDLE HEIGHT ADJUSTMENT SCREWS: P/N 0016105049

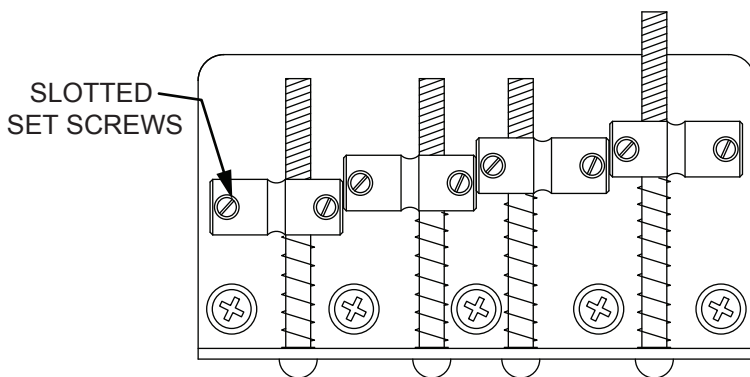

TRUSS ROD ADJUSTMENT NUT:
P/N 0994944000

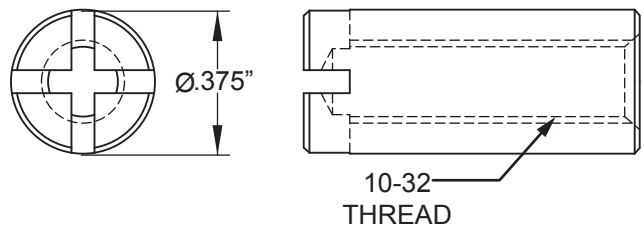

LOGO: VINTAGE 74 J-BASS
APPLIED OVER THE FINISH



PICKUP SPECIFICATIONS

POSITION	MAGNETS	DC RESISTANCE	POLARITY
NECK	ALNICO 5 UNBEVELED	7.4 - 7.8KΩ	SOUTH
BRIDGE	ALNICO 5 UNBEVELED	7.8 - 8.2KΩ	NORTH