

MUSTANG™ *By* **FENDER®**

GUITAR AMPLIFIERS



ADVANCED OWNER'S MANUAL

Fender®
www.fender.com

Advanced Manual

Introduction

This manual is your step-by-step guide to the advanced features found on your **Mustang™ III/IV/V** amplifier. Turn to page 8 for the **Mustang I/II** advanced manual. For information on using Fender® FUSE™, Ableton® Live or Amplitube®, please see the separate manuals for each product available at www.fender.com/support.

Navigation

There are just a few basics of Mustang navigation that you should know before you explore any further...

Selecting Presets

Turn the DATA WHEEL to select one of 100 presets.

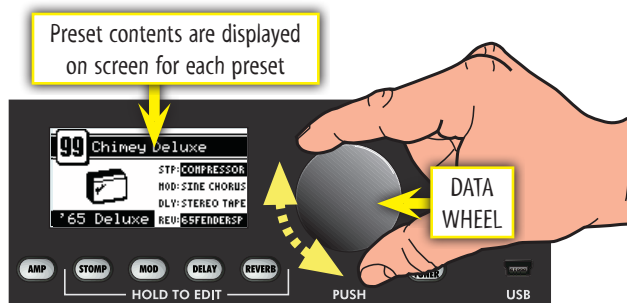

You will find some presets you like and others that you want to change...

Each preset stores the settings for:

- **Amplifier type** — 12 selections
- **Effects** — 4 categories, 37 selections total
- **Knob levels** — GAIN through REVERB (not MASTER)



You can select and edit presets from your computer using Fender® FUSE™ software, available free at www.fender.com/support

Master Volume

The MASTER volume knob is always "active." That means the position of the MASTER knob always shows the true master volume setting, unlike the **programmable** knobs.

(Always turn the MASTER volume knob first to adjust the overall volume output of your Mustang amplifier.)

Programmable Knobs

Because the setting of every knob (except MASTER) is part of each preset, the "programmable" knobs are **not active** and

the knob positions will NOT show their actual settings when a preset is first selected.

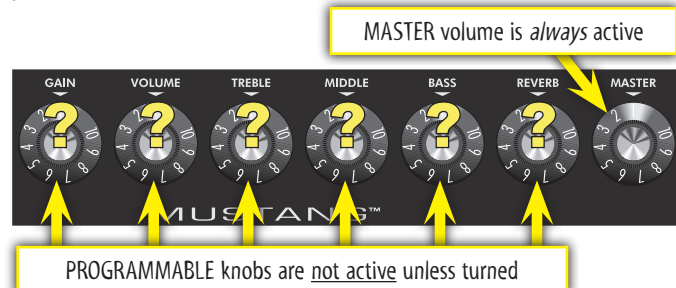

How do I activate a programmable knob? The moment you turn any programmable knob it instantly becomes **active** and it will remain active until you select a different preset, at which time all the programmable knobs become inactive again.



Press the DATA WHEEL to see what the preset settings are for all the programmable knobs **before** you turn them. Press EXIT to return to Play mode.

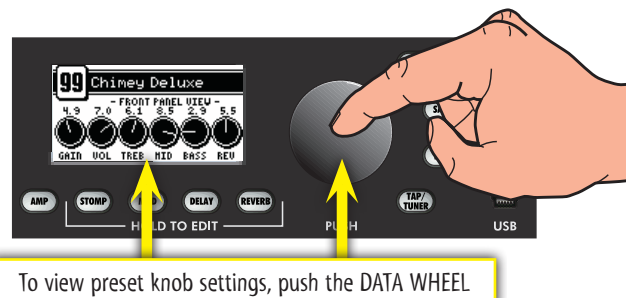

Press the DATA WHEEL a second time to see where your effects are located in the Guitar Signal Processing Path. Press EXIT to return to Play mode.

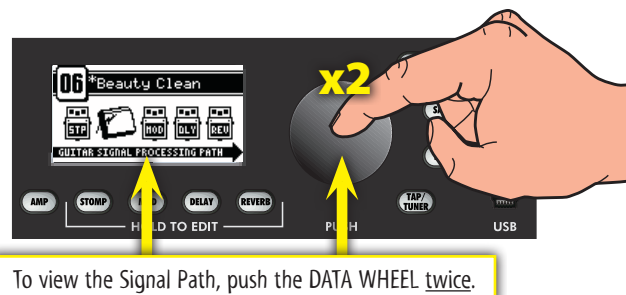

You can change the order of effects in the Signal Path using Fender® FUSE™ software.

Amplifier Menus

Select amplifier models and adjust amplifier settings using the Amp menus.

Amplifier Models

To select Amplifier Models:

1. Press the AMP button.
2. Turn the DATA WHEEL to select one of 12 amplifier models:

AMP MODELS
'57 Deluxe
'59 Bassman
'57 Champ
'65 Deluxe Reverb
'65 Princeton
'65 Twin Reverb
Super-Sonic (Burn)
British '60s
British '70s
British '80s
American '90s
Metal 2000

3. Press EXIT to return to Play mode.

Amplifier Settings

To adjust Amplifier Settings:

1. Press the AMP button.
2. Press the DATA WHEEL one or more times until the setting that you want to adjust is highlighted, then turn the DATA WHEEL to adjust the setting.
3. Press the AMP button a second time to access "Page 2" with more amplifier settings. The settings that appear on "Page 2" depend on the amp model that is currently selected.

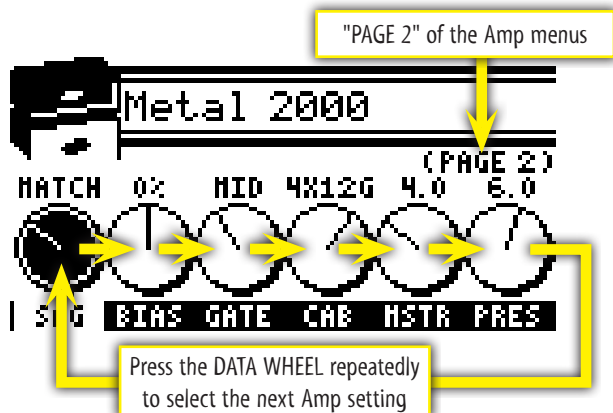

You can de-select the highlighted amp setting and return to Amp Model selection mode, as a shortcut, by pressing and holding the AMP button.

4. Press EXIT to return to Play mode.

Effect Menus

Bypassing Effects

You can turn on-off effects that have been selected for the current preset by pressing the corresponding effect button.

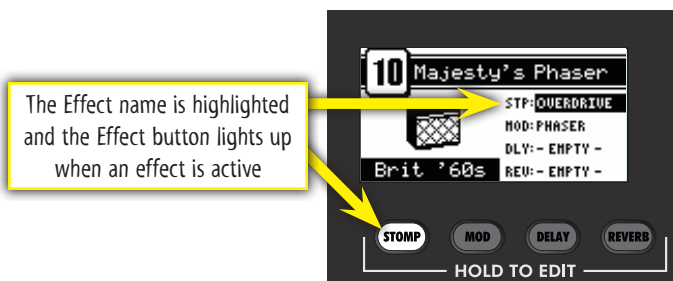

Effects can also be bypassed (turned on-off) from the footswitch included with your Mustang amplifier.

Effects that are shown on screen as "-EMPTY-" can not be activated until an effect has been selected in that slot.

Selecting Effects

- **STOMP** — Stompbox effects
- **MOD** — Modulation effects
- **DELAY** — Delay effects
- **REVERB** — Reverb effects

To select Effects:

1. Press and hold one of the four effects buttons.
2. Turn the DATA WHEEL to select one of the following effects:

STOMPBOX
Overdrive
Fixed Wah
Touch Wah
Fuzz
Fuzz Touch Wah
Simple Compressor
Compressor

MODULATION
Sine Chorus
Triangle Chorus
Sine Flanger
Triangle Flanger
Vibratone
Vintage Tremolo
Sine Tremolo
Ring Modulator
Step Filter
Phaser
Pitch Shifter

Effects tables continued from previous page...

DELAY	REVERB
Mono Delay	Small Hall
Mono Echo Filter	Large Hall
Stereo Echo Filter	Small Room
Multitap Delay	Large Room
Ping Pong Delay	Small Plate
Ducking Delay	Large Plate
Reverse Delay	Ambient
Tape Delay	Arena
Stereo Tape Delay	Fender '63 Spring
	Fender '65 Spring

3. Press EXIT to return to Play mode.

 You can switch to a different effect category at any time, even while you are in the effect selection menus, by pressing and holding a different Effects button.

Effect Settings

Use the Effects Settings menus to adjust a dazzling array of effect settings.

To adjust Effect Settings:

1. Press and hold any Effect button (STOMP, MOD, DELAY, REVERB).
2. Turn the DATA WHEEL to select the effect you want to work with.
3. Press the DATA WHEEL one or more times until the setting that you want to adjust is highlighted, then turn the DATA WHEEL to adjust the setting.

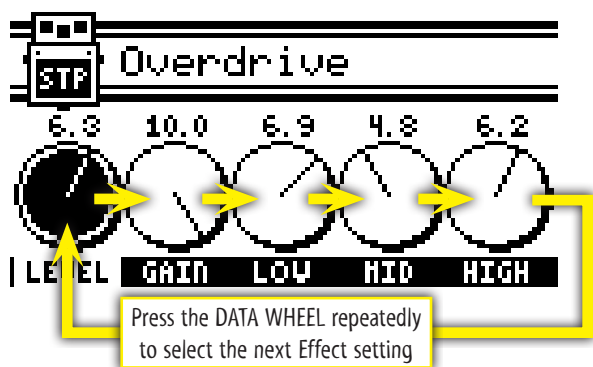

4. Press EXIT to return to Play mode.

 You can bypass an effect at any time, even while you are in the effect settings menus, by pressing the Effect buttons or corresponding footswitch buttons.

Tap Button

The TAP button can be used to "tap in" delay time and modulation rate settings, by rhythmically pressing the TAP button.

When you select a delay effect, the TAP button will blink in time with the delay time setting. When you select a modulation effect, the TAP button will blink in time with the modulation rate setting (note that modulation rates can have up to 12 second intervals and the TAP button will flash infrequently).

When *both* delay and modulation effects are selected simultaneously, the TAP button will blink in time with the delay effect and will only control the delay time setting.

 You can use the Effects menus or Fender FUSE to set delay time and modulation rates more precisely.

To set the TAP interval of effects:

1. Select a Delay or Modulation effect that causes the TAP button to blink, using the Effects menus (see Selecting Effects, page 3).
2. Press the TAP button rhythmically (twice minimum) in time with the desired interval. If you press the TAP button only once, the interval will be set to the maximum.

 If you open the Effect settings menu (see Effect Settings, above), you can watch the actual TAP values you are setting while you are tapping them in!

Saving Presets

Your Mustang™ amplifier gives you the powerful ability to save every setting on the amplifier as part of a preset. When you select a preset, the level of each knob, every effect setting, and the amp model selection, are instantly recalled to your pre-programmed settings.

 The SAVE button will light up **red** when you turn any programmable knob or edit any other setting on the amp. This indicates that you have temporarily modified the preset. You can undo your modifications by turning the DATA WHEEL to a different preset and then back again.

 The EXIT button will not cancel changes to the current preset. Only by selecting a different preset using the DATA WHEEL, Footswitch, or Fender FUSE, will your temporary changes be erased.

To save a preset:

1. To save a preset you should first modify an existing preset, for example, by turning any of the programmable knobs, such as GAIN.

2. Press the SAVE button. The SAVE and EXIT buttons should be illuminated. You can press EXIT at this point to cancel the save process.
3. Turn the DATA WHEEL select a preset destination to overwrite.
4. Press the DATA WHEEL if you want to edit the name of your new preset. Use the buttons to perform the functions listed along the bottom of the screen; turn the DATA WHEEL to select characters.

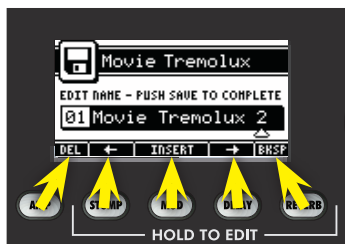

5. Press the SAVE button a second time to confirm the save.

 *Memory Lock must be OFF to save presets (see Utility Menus, page 6)*

Guitar Tuner

Your Mustang™ amplifier has a built-in Tuner mode that turns the screen into a guitar tuner.

To use the Tuner:

1. Press and hold the TAP button. The TAP and EXIT buttons will illuminate.
2. Strike any single string on your guitar and watch the screen. The the note of the string being tuned is displayed along with a fine tuning needle

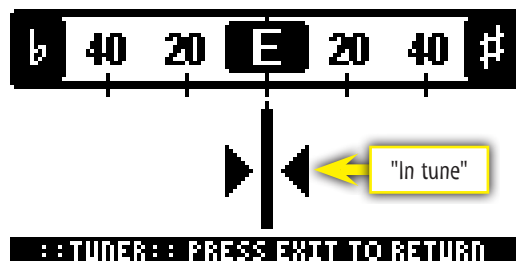

3. Turn the tuning peg on your guitar until the fine tuning needle indicates the string is in tune, as shown above.
4. Standard guitar tuning is as follows:

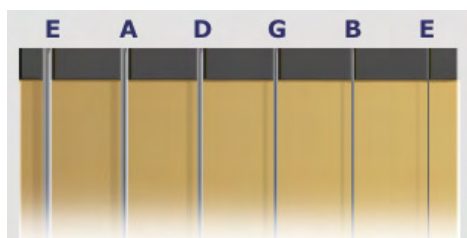

5. Press EXIT or TAP to exit from the Tuner.

Footswitches

Four-Button Footswitch (0080996000)

Connect a 4-button footswitch to your Mustang amplifier (included with the Mustang IV & V, optional equipment for the Mustang III) to enable remote multi-function foot control. The footswitch display and LEDs show you some of the same information as the amplifier screen, so you can, for example, tune your guitar and select presets by watching the footswitch without ever looking at the screen onboard the Mustang!

- Select Quick Access presets (QA1/QA2/QA3)
- Select presets (up/down/bank)
- Bypass effects
- Activate the Tuner



The footswitch has three modes that are identified by the three LEDs labeled **MODE 1**, **MODE 2** and **MODE 3**. The footswitch also has a Tuner mode which is indicated when all of the mode LEDs are off.

To switch between modes, press the MODE button. To activate Tuner mode, press and hold the MODE button.

Mode 1—In Mode 1 the footswitch is used to select one of three Quick Access presets, using the buttons labeled: **QA1 / QA2 / QA3** (in line with the **MODE 1** LED). When you select a Quick Access preset, the number of the preset will appear in the display of the footswitch.

 *You can any assign any preset to be a Quick Access preset in the Utility menus. (see Utility Menus, page 6).*

Mode 2—In Mode 2 the footswitch is used to select presets down/up, or in banks of 10, using the buttons labeled: **DOWN / UP / BANK** (in line with the **MODE 2** LED). When you select a preset, the number of the preset will appear in the display of the footswitch.

Mode 3—In Mode 3 the footswitch is used to bypass the Stompbox, Modulation or Delay effects, using the buttons labeled: **STOMP / MOD / DELAY** (in line with the **MODE 3** LED). The footswitch button LEDs indicate the effects that are active, just like the buttons on the amplifier.



You can also have a footswitch button assigned to bypass the Reverb effect by adding on the 2-button Mustang footswitch (see Six-Button Footswitching options, below).

Tuner Mode—Press and hold the MODE button to activate the Tuner. The screen and the footswitch both will display the same tuner information so that you can look in either place to tune your guitar. The footswitch will display the nearest note; the button LEDs will indicate sharp and flat and "in tune" is indicated when the green LED below the footswitch display lights up.

Press any footswitch button to exit Tuner mode.

Two-Button Footswitch (0080997000)

Connect a 2-button footswitch to your Mustang amplifier (included with the Mustang III, optional equipment for the Mustang IV & V) to enable remote multi-function foot control. Use the Utility menus to assign one of the following functions to the 2-button footswitch:

- Select presets (up/down)
- Select Quick Access presets (QA1/QA2)
- Bypass effects (various combinations)
- Set TAP interval



Six-Button Footswitching options

Plug both a 4-button and a 2-button footswitch into your Mustang amplifier to expand your remote control options. By assigning different functions to each footswitch you can create more than a dozen different foot control combinations.



For example, you could assign Quick Access presets to the 4-button footswitch and Up/Down presets to the 2-button footswitch. Or you could bypass effects with the 4-button footswitch and select presets with the 2-button footswitch. The choice is up to you.

Utility Menus



Press the UTIL button to activate the Utility menus. Press the UTIL button repeatedly to step through each of the seven menus.

Quick Access #1 / #2 / #3 — Use the first three Utility menus to choose Quick Access presets. You can then access those presets quickly from the footswitches (see Footswitches, above).

Two-Button Footswitch Mode — Use this menu to assign functions to the two-button footswitch.

Memory Lock — Use the Memory Lock menu to prevent accidental preset modifications. You will still be able to make *temporary* changes to presets with Memory Lock ON, but you won't be able to save those changes until Memory Lock is switched OFF.

LCD Contrast — Use this menu to adjust the contrast of the Mustang display.

About This Amp — This menu displays the Firmware version currently running on the amplifier. Use this information to determine if an update is available for your amplifier.

Speaker Outputs

Mustang V, only

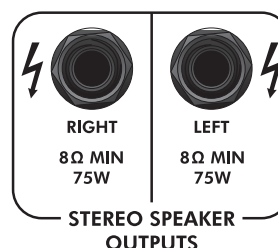

The Mustang V head amplifier provides stereo speaker outputs that must both be connected to a stereo speaker cabinet such as the Mustang V 412, with four 12" Celestion® G12P Rocket 50 speakers (recommended), or two 8Ω speaker cabinets capable of handling 75W each.

Aux / Phones Jacks

Auxiliary Input



You can use the Auxiliary jack to input audio into your Mustang amplifier for accompaniment. Connect the headphone output on your CD player or MP3 player to the AUX jack using a mini-stereo cable. Use the volume control

on your player, together with the MASTER volume knob, to adjust the auxiliary volume level.

Phones Jack

 Plug in your headphones, ear buds, or powered PHONES speakers to enjoy the Mustang's stereo features. This jack may also be used as a stereo recording output. The amp's speaker is muted when the PHONES jack is used.

Effects Loop

Connect external effects devices to your Mustang amplifier using the effects loop jacks.

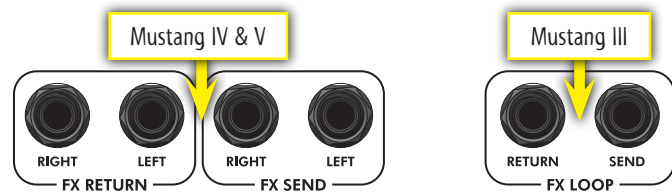

The Mustang IV & V amplifiers can accept stereo or mono effects devices. Note that a mono-in, mono-out effect unit will use one send and one return, and only effect one side of the stereo image. The Mustang III amplifier only accepts mono effects devices.

Connect the FX SEND jack(s) to the input(s) on your external effects device and connect the FX RETURN jack(s) to the output(s) on your effects device.

USB Port

 Use the USB port to connect the Mustang™ amplifier to your computer and take your music to the next level:

- Use Fender® FUSE™ software to control your Mustang from your computer and access bonus amp features not available from the Mustang alone.

 Please see the Fender FUSE manual at www.fender.com/support for details.

- Record and edit Mustang audio using Ableton® Live Lite 8 Fender® Edition software.

 Please see the Ableton® Live Lite 8 Fender edition at www.fender.com/support for details.

- Stream live audio and play with people around the world using Fender® BAND JAM, powered by eJamming® AUDiiO.

 For a 30-day trial subscription, log on to: www.fender.com/ejamming

Factory Restore & Firmware Update

Factory Restore

You can restore your Mustang amplifier to the original factory settings if desired. All user presets will be erased!

To restore the Mustang amplifier to factory settings:

1. Turn the amplifier OFF.
2. Press and hold the EXIT button while turning the amplifier ON. Continue holding the EXIT button until it is no longer illuminated.



The FACTORY RESTORE function will erase all user modified presets. It will also restore any effect selections that have been modified using Fender FUSE software.

Firmware Update

From time to time, Fender may make available firmware updates for your Mustang amplifier to improve operation or to add new features. To update the firmware on your amplifier you will need to connect it through the USB port to a computer with Fender FUSE software and an internet connection.



Please see the Fender FUSE manual at www.fender.com/support for details.

FAQ

There are several great places you can go to learn more about your Mustang and music in general:

- www.fender.com/support
- Join a Fender Community forum where you can ask questions and read threads. There's even a forum just for the Mustang: www.fender.com/community/forums
- Log on to the Fender Knowledge Base to download and read "Frequently Asked Questions" (FAQ): www.fender.com/support/faqs.php
- Find music theory learning materials and sheet music at Hal Leonard Publications: www.halleonard.com

Advanced Manual

Introduction

This manual is your step-by-step guide to all the advanced features found on your **Mustang™ I/II** amplifier. For information on using Fender® FUSE™, Ableton® Live or Amplitube®, please see the separate manuals for each product available at www.fender.com/support.

Navigation

There are just a few basics of Mustang navigation that you should know before you explore any further...

Selecting Presets

The most powerful feature of your Mustang amplifier is its ability to store every amplifier setting and effect selection as a preset that you can instantly recall using the PRESET knob, or remotely from your computer or footswitch.

Use the PRESET knob to select one of 24 presets. Presets are stored in three banks, colored **AMBER**, **GREEN** and **RED**.

Turn the PRESET knob to scroll through each bank of presets in the following order:

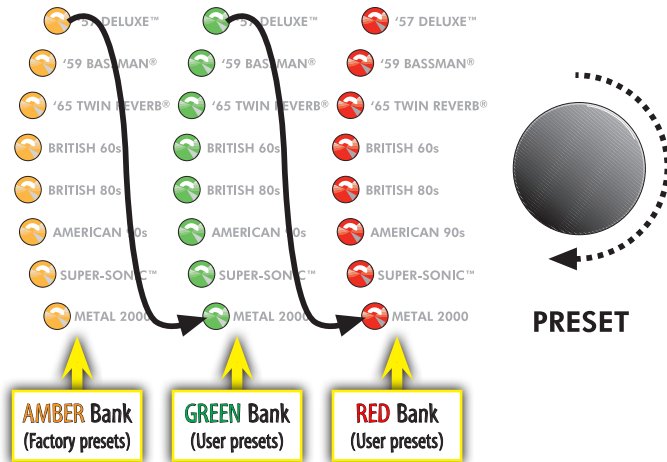

Each preset is based on one of the eight amplifier types labeled next to each of the preset LEDs. That gives you a total of three presets for each amplifier type.

🎵 The **RED** and **GREEN** banks are for creating your own presets. The **AMBER** bank of presets can only be modified using Fender FUSE software available free at www.fender.com/support.

Each preset includes the settings of all the **programmable** knobs on the Mustang, which includes every knob except the MASTER volume and PRESET knobs.

Programmable Knobs

Because the setting of every knob on the Mustang amplifier (except MASTER) is part of each preset, all programmable knobs are normally **inactive** and knob positions will NOT show their actual settings when a preset is first selected.



Programmable knob positions are **inactive** unless turned

How do I activate a programmable knob? The moment you turn any programmable knob it instantly becomes **active** and it will remain active until you select a different preset, at which time it becomes inactive again.



Rotate knobs to **activate** their positions

You may hear a big change in volume or tone when you first turn a programmable knob if there happened to be a large difference between the knob's starting position and the stored preset setting. For example, if the VOLUME knob is pointing to "8" but the stored preset VOLUME setting is "2," the volume level will jump from "2" to "8" when you start turning the VOLUME knob because the VOLUME knob is now instantly active at "8."

🎵 The only way to know what the preset setting of a knob is **before** you turn it, is by using Fender FUSE software and connecting the Mustang to your computer.

Effects

There are two effect selection knobs on the Mustang:

- **MOD** — selects Modulation type effects
- **DLY/REV** — selects Delay and Reverb type effects

🎵 You can also select effects from a STOMPBOX category using Fender FUSE software.

The MOD and DLY/REV knobs share the same three selection indicator LEDs. The knob turned *last* has control of these LEDs:

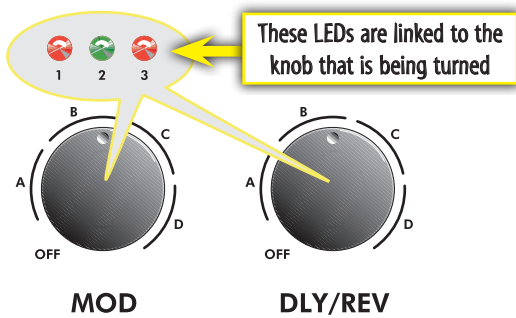

These LEDs are numbered 1, 2, 3 and correspond to the three positions within each of the selection ranges A, B, C, D on each knob. Use the LEDs to determine exactly which position the knob is pointing to, for example, A1 is shown below:

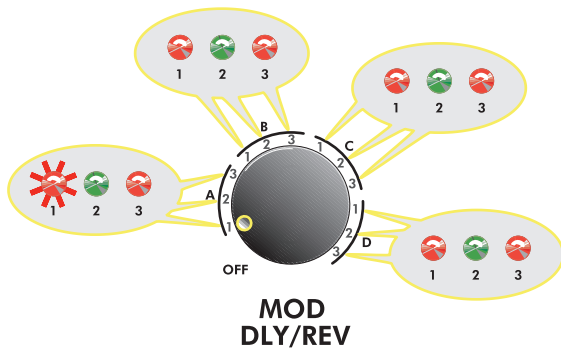

Effect Selections

The tables below list the effect selections for each knob.

	MODULATION EFFECTS
A1	Chorus
A2	Chorus Deep
A3	Flanger
B1	Bias/Sine Tremolo
B2	Optical/Vintage Tremolo
B3	Optical/Vintage Tremolo Fast
C1	Vibratone Slow
C2	Vibratone Fast
C3	Octaver
D1	Phaser Slow Deep
D2	Phaser Medium
D3	Step Filter

	DELAY EFFECTS	REVERB EFFECTS
A1	Tape Delay 150ms / 1 Repeat	
A2	Stereo Tape Delay 300ms / 3 Repeats	
A3	Mono Delay 700ms / 4 Repeats	
B1		Small Room Reverb
B2		Plate Reverb
B3		Large Hall Reverb

C1		Fender '65 Spring Reverb
C2		Fender '63 Spring Reverb
C3	Tape Delay	Room
D1	Tape Delay	Large Hall
D2	Ducking Delay	Small Hall
D3	Echo Filter	

You can completely change the effects list on your Mustang™ amplifier using Fender® FUSE™ software available at www.fender.com/support.

Effects Level

You can adjust the effects level by holding down the EXIT button while rotating either the MOD or DLY/REV knob, depending on which effect type you want to adjust.

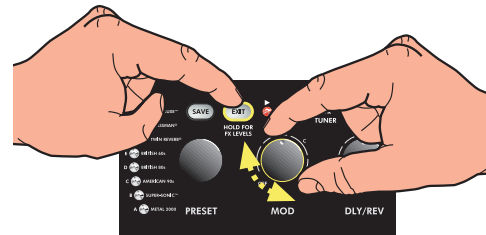

Tap Button

The TAP button can be used to "tap in" delay time and modulation rate settings:

• **Delay time** — TAP button blinks **green**:



• **Modulation rate** — TAP button blinks **red**:



When you select a delay effect, the TAP button will blink **green** in time with the delay time setting. When you select a modulation effect, the TAP button will blink **red** in time with the modulation rate setting.

When both delay and modulation effects are selected simultaneously, the TAP button will blink **green** and only control the delay time setting.

You can use TAP to set both delay time and modulation rate by tapping in the modulation rate first, with NO delay effect selected, then adding a delay effect and tapping in the delay time last.

To set the TAP interval of effects:

1. Select an effect that causes the TAP button to blink, using the DLY/REV or MOD knob.
2. Press the TAP button rhythmically (twice minimum) in time with the desired interval.

Tuner Button

Your Mustang™ amplifier has a built-in Tuner mode that turns the control panel LEDs into a chromatic guitar tuner.

To use the tuner:

1. Press and hold the TAP button for 2 seconds. The TAP and EXIT buttons will illuminate.
2. Strike any single string on your guitar and watch the panel LEDs. The Preset LEDs are used to indicate the note of the string being tuned (the top LED "#" indicates if the note is sharp).

3 LEDs indicate fine tuning. **GREEN** means "in tune"



Letters next to LEDs indicate the note being tuned

3. Turn the tuning peg on your guitar until the fine tuning LEDs above the MOD knob indicate the string is in tune, as shown above.
4. Standard guitar tuning is as follows:

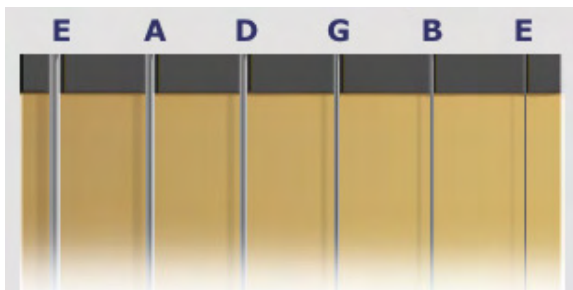

5. Press EXIT or TAP to exit from the Tuner.

Save Button

SAVE Your Mustang amplifier gives you the powerful ability to save every setting on the amplifier as part of a preset. When you select a preset, the level of each knob, including effect selections, is instantly recalled to your pre-programmed settings!

The SAVE button will light up **red** when you turn any programmable knob on the amplifier. This indicates that you

have temporarily modified the preset. You can reset your modifications simply by selecting a different preset and then back again.



The EXIT button will not cancel changes to the current preset. Only by selecting a different preset using the PRESET knob will your temporary changes be erased.

To save a preset:

1. To save a preset you must first modify an existing preset by turning any of the programmable knobs, such as GAIN or MOD. (once the SAVE button is illuminated, you can proceed to step 2).
2. Press the SAVE button. The SAVE and EXIT buttons should be flashing rapidly. You can press EXIT at this point to cancel the save process.
3. Turn the PRESET knob to select a preset to overwrite. You can only overwrite the **red** and **green** banks of the amplifier type that you started from (if you started by modifying the **amber** bank, you must select either the **red** or **green** bank to overwrite).



*You can modify the **AMBER** bank of presets by using your computer and Fender® FUSE™ software available at www.fender.com/support.*

Aux / Phones Jacks

Auxiliary Input

You can use the Auxiliary jack to input audio into your Mustang amplifier for accompaniment. Connect the headphone output on your CD player or MP3 player to the AUX jack using a mini-stereo cable. Use the volume control on your player, together with the MASTER volume knob, to adjust the auxiliary volume level.

Phones Jack

Plug in your headphones, ear buds, or powered speakers to enjoy the Mustang's stereo features. This jack may also be used as a stereo recording output. The amp's internal speaker is muted when the PHONES jack is used.

Footswitch



Connect a (optional) 1-button footswitch (P/N 0994049000) into the FTSW jack to enable remote selection of your two favorite presets. The LED (next to the FTSW jack) will turn **red** or **green** to indicate which footswitch preset is active.

To program the footswitch:

1. Select a preset that you want to assign to the footswitch. The preset must not be modified (the SAVE button must NOT be illuminated to proceed to step 2).
2. Press the SAVE button. The SAVE and EXIT buttons should be flashing rapidly. You can press EXIT at this point to cancel the footswitch assignment process.
3. Press the footswitch button to select either the **red** or **green** LED next to the FTSW jack to associate with the chosen preset.
4. Press the SAVE button to confirm the footswitch assignment. Now when you press the footswitch, the chosen preset will be activated with the assigned **red** or **green** footswitch indicator.

USB Port

Use the USB port to connect the Mustang™ amplifier to your computer and take your music to the next level:

- Use Fender® FUSE™ software to control your Mustang from your computer and access bonus amp features not available from the Mustang alone.

 Please see the Fender FUSE manual at www.fender.com/support for details.

- Record and edit Mustang audio using Ableton® Live Lite 8 Fender® Edition software.

 Please see the Ableton® Live Lite 8 Fender edition at www.fender.com/support for details.

- Stream live audio and play with people around the world using Fender® BAND JAM, powered by eJamming® AUDiiO.

 For a 30-day trial subscription, log on to: www.fender.com/ejamming

Factory Restore & Firmware Update

Factory Restore

You can restore your Mustang amplifier to the original factory settings if desired. All user presets will be erased!

To restore the Mustang amplifier to factory settings:

1. Turn the amplifier OFF.
2. Press and hold the EXIT button while turning the amplifier ON. Continue holding the EXIT button until it is no longer illuminated.



*The FACTORY RESTORE function will erase all user modified presets. It will also restore the **AMBER** bank of presets and any effect selections that have been modified using Fender FUSE software.*

Firmware Update

From time to time, Fender may make available firmware updates for your Mustang amplifier to improve operation or to add new features. To update the firmware on your amplifier you will need to connect it through the USB port to a computer with Fender FUSE software and an internet connection.



Please see the Fender FUSE manual at www.fender.com/support for details.

FAQ

There are several great places you can go to learn more about the Mustang and music in general:

- www.fender.com/support
- Join a Fender Community forum where you can ask questions and read threads. There's even a forum just for the Mustang: www.fender.com/community/forums
- Log on to the Fender Knowledge Base to download and read "Frequently Asked Questions" (FAQ): www.fender.com/support/faqs.php
- Find music theory learning materials and sheet music at Hal Leonard Publications: www.halleonard.com

部件名称 (Part Name)	有毒有害物质或元素 (Hazardous Substances' Name)					
	铅 (PB)	汞 (Hg)	镉 (Cd)	六价铬 (Cr ⁶⁺)	多溴联苯 (PBB)	多溴二苯醚 (PBDE)
部分电子元件	X	O	O	O	O	O
部分机械加工金属部件	X	O	O	O	O	O
部分其他附属部件	X	O	O	O	O	O
O: 表示该有毒有害物质在该部件所有均质材料中的含量均在 SJ/T 11363-2006 规定的现量要求以下 X: 表示该有毒有害物质至少在该部件的某一均质材料中的含量超出 SJ/T 11363-2006 规定的现量要求						

This product is covered by one or more of the following patents:
US Pat. 6,222,110

AMPLIFICADOR DE AUDIO

IMPORTADO POR: Instrumentos Musicales Fender S.A. de C.V., Calle Huerta # 132, Col. Carlos Pacheco, C.P. 228890, Ensenada, Baja California, Mexico.
RFC: IMF870506R5A Hecho en China. Servicio de Cliente: 001-8665045875

A PRODUCT OF:

FENDER MUSICAL INSTRUMENTS CORPORATION
CORONA, CALIFORNIA, USA

Fender®, Mustang™ and Fender® FUSE™ are trademarks of FMIC.

Other trademarks are property of their respective owners.

Copyright © 2010 FMIC. All rights reserved.

P/N 824CGP006 (ENGLISH) REV A