

AMERICAN PERFORMER PRECISION BASS® (019860XXXX)

PARTS LAYOUT

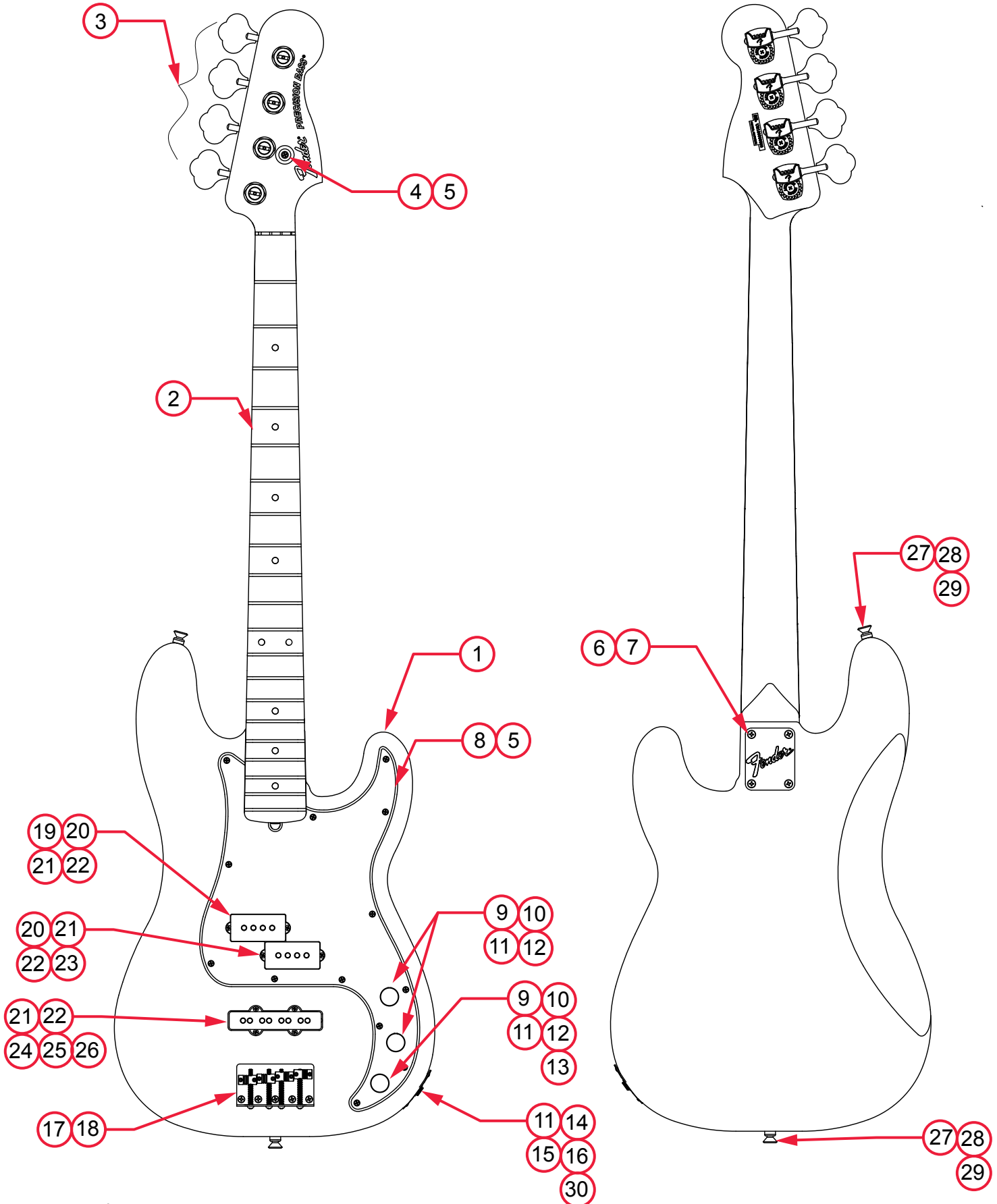

AMERICAN PERFORMER PRECISION BASS® (019860XXXX)

PARTS LIST

| REF# | DESCRIPTION | PART NUMBER |
|-------------|---|--------------------|
| 1 | BODY AM PERFORMER P-BASS GLOSS 3TS | 7713581500 |
| 1 | BODY AM PERFORMER P-BASS GLOSS AWT | 7713581580 |
| 1 | BODY AM PERFORMER P-BASS GLOSS PNY | 7713581584 |
| 1 | BODY AM PERFORMER P-BASS SATIN LPB | 7714131502 |
| 2 | NECK ASSY AM PERFORMER P-BASS RW | 7713193000 |
| 2 | NECK ASSY AM PERFORMER P-BASS MPL | 7713213000 |
| 3 | KEY BASS DLX NEW MOD TAPER LONG SET | 0992006000 |
| 4 | STRING GUIDE BASS BARREL NI | 0013235000 |
| 5 | SCREW SMAB 4 X 1/2 OHP NI | 0015578049 |
| 6 | PLATE NECK STD SERIES LOGO NO TILT | 0048691000 |
| 7 | SCREW SMA 8 X 1-3/4 OHP NI | 0015636049 |
| 8 | PICKGUARD AM PERFORMER P-BASS B/W/B | 7713952000 |
| 9 | KNOBS CONTROL ALUM CHROME W/SET SCREW (2) | 0095799049 |
| 10 | CONTROL 250K 10% AUDIO METAL | 0990831000 |
| 11 | HEX NUT 3/8-32 X 3/32 TK NI | 0016352049 |
| 12 | WASHER LOCK INTL 3/8 X .687 | 0016436049 |
| 13 | PCB ASSY GREASE BUCKET TONE CIRCUIT | 7713546000 |
| 14 | JACK PHONE OPEN CIRCUIT | 0021956049 |
| 15 | WASHER FLAT 3/8 X .614 NI | 0031153049 |
| 16 | WASHER LOCKING INTL 3/8 X .500 X .020 NI | 0022384049 |
| 17 | BRIDGE ASSY HIGH MASS VINTAGE | 0075124000 |
| 17A | BRIDGE PLATE JAZZ BASS | 0010538070 |
| 17B | BRIDGE SADDLE AM SRS BASS 1-2 BARREL NI | 0075127000 |
| 17C | BRIDGE SADDLE AM SRS BASS 3-4 BARREL NI | 0075135000 |
| 17D | SCREW M 6-32 X 1-1/2 RHP NI | 0015842049 |
| 17E | SPRING COMPRESSION 1-1/16 #144 | 0018689049 |
| 17F | SPRING COMPRESSION 1-3/8 x 0.15 NI | 0099135000 |
| 17G | SCREW SET 6-32 X 7/16 HEX SKT BLX NYLOK | 0075354000 |
| 18 | SCREW SMAB 5 X 1 OHP NI | 0015610049 |
| 19 | PICKUP ASSY AM PERFORMER P-BASS NECK | 7713635000 |
| 20 | PICKUP COVERS PRECISION BASS BLACK | 0992037000 |
| 21 | SCREW 4 X 1-1/4 WOOD RHP NI | 0027035049 |
| 22 | WEATHERSTRIP 9/16 X 1/2 OPCL NEOPRENE | 0018556049 |
| 23 | PICKUP ASSY AM PERFORMER P-BASS BRIDGE | 7713634000 |
| 24 | SHIELD PICKUP NECK J-BASS 62 6-1/2 WIRE | 0061289000 |
| 25 | PICKUP ASSY AM PERFORMER J-BASS BRIDGE | 7713562000 |

*= NOT PICTURED IN DIAGRAM



AMERICAN PERFORMER PRECISION BASS® (019860XXXX)

| REF# | DESCRIPTION | PART NUMBER |
|-------------|---|--------------------|
| 26 | PICKUP COVER JAZZ BASS BLACK SET | 0992038000 |
| 27 | BUTTON STRAP NICKEL | 0994915000 |
| 28 | WOOD SCREW 6 X 1 OHP NI | 0016188049 |
| 29 | FELT WASHER BLACK | 0994929000 |
| 29 | FELT WASHER WHITE | 0994930000 |
| 30 | FERRULE JACK RECESS FOOTBALL CHROME | 0050100049 |
| * | DELUXE GIG BAG BASS GUITAR | 0991522000 |
| * | WRENCH HEX KEY 1/16 (SADDLE HEIGHT ADJUSTMENT) | 0021109049 |
| * | WRENCH HEX KEY 3/16 5.5" (TRUSS ROD ADJUSTMENT) | 7710885000 |
| | | |
| | | |
| | | |
| | | |
| | | |
| | | |
| | | |
| | | |
| | | |
| | | |
| | | |
| | | |
| | | |
| | | |
| | | |
| | | |
| | | |
| | | |
| | | |
| | | |

* = NOT PICTURED IN DIAGRAM



AMERICAN PERFORMER PRECISION BASS® (019860XXXX)

WIRING ASSEMBLY

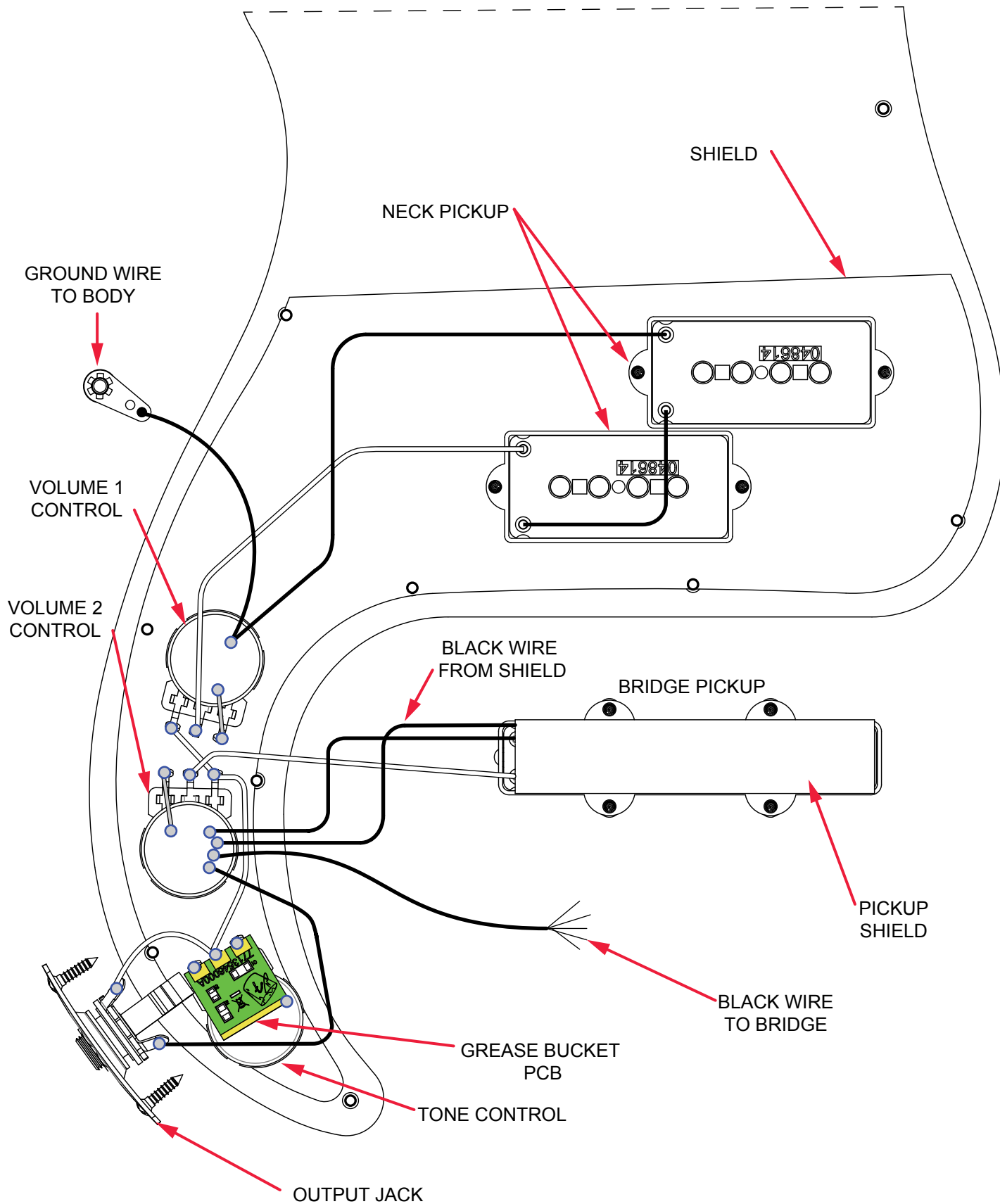

AMERICAN PERFORMER PRECISION BASS® (019860XXXX)

SWITCH AND CONTROL FUNCTION

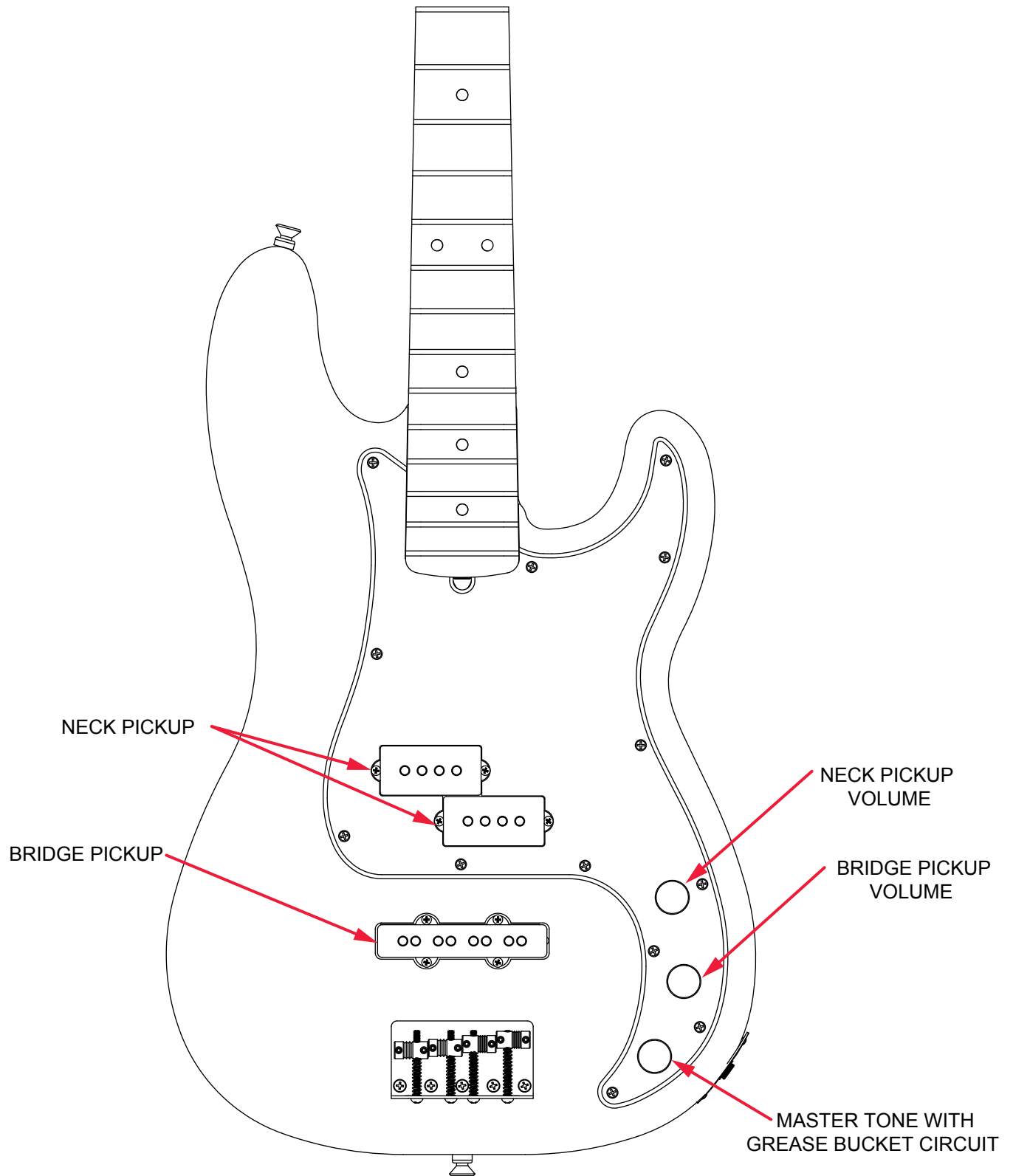

AMERICAN PERFORMER PRECISION BASS® (019860XXXX)

ADDITIONAL SPECIFICATION DETAIL

FRET SIZE: MEDIUM JUMBO
(FRET DIMENSIONS ARE BEFORE INSTALLATION)

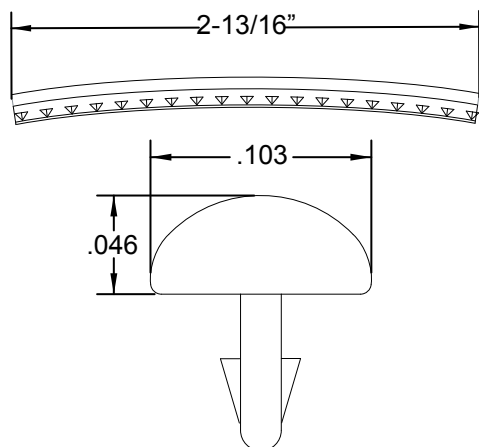

PLEASE NOTE: AS EACH NECK IS SANDED & FINISHED BY HAND, THICKNESS DIMENSIONS MAY VARY SLIGHTLY FROM THOSE SHOWN.

NECK PROFILE: MODERN "C"

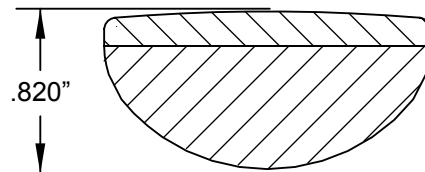

1ST FRET PROFILE

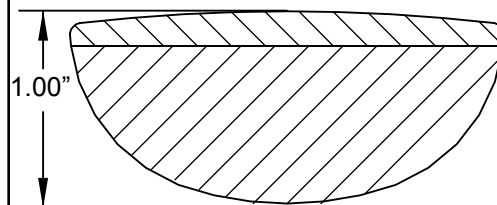

12TH FRET PROFILE

KEY BASS DLX NEW MOD TAPER LONG SET:

P/N 0992006000

OUTER SHAFT DIAMETER .533"

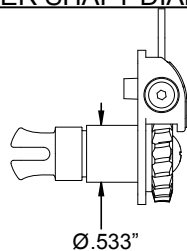

TUNING MACHINE THRU-HOLE

INNER DIAMETER .687"

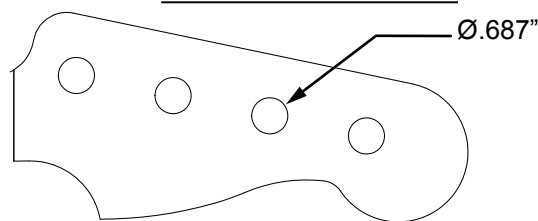

SADDLE HEIGHT ADJUSTMENT WRENCH:

1/16" HEX KEY P/N 0021109049

SADDLE HEIGHT ADJUSTMENT SCREWS: P/N 0075354000

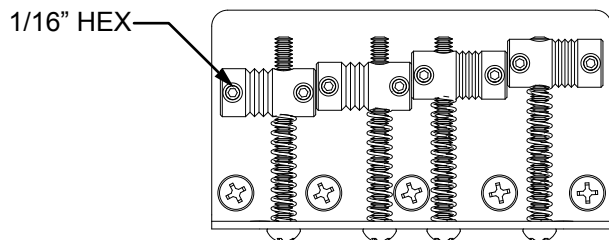

TRUSS ROD ADJUSTMENT NUT:

P/N 0048688049

TRUSS ROD ADJUSTMENT WRENCH:

3/16" HEX KEY P/N 7710885000

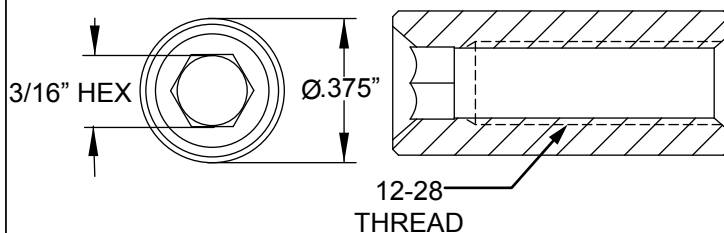

LOGO: AM PERFORMER P-BASS DECAL
APPLIED UNDER THE FINISH



PICKUP SPECIFICATIONS

| POSITION | MAGNETS | DC RESISTANCE | POLARITY |
|----------|-----------------------|---------------|----------------|
| NECK | ALNICO 5 UNBEVELED | 5.8 - 6.4KΩ | SOUTH NORTH |
| | | 5.7 - 6.3KΩ | |
| BRIDGE | ALNICO 5 UNBEVELED | 7.2 - 7.8KΩ | SOUTH |