

AMERICAN ULTRA JAZZ BASS® V (019903XXXX)

PARTS LAYOUT

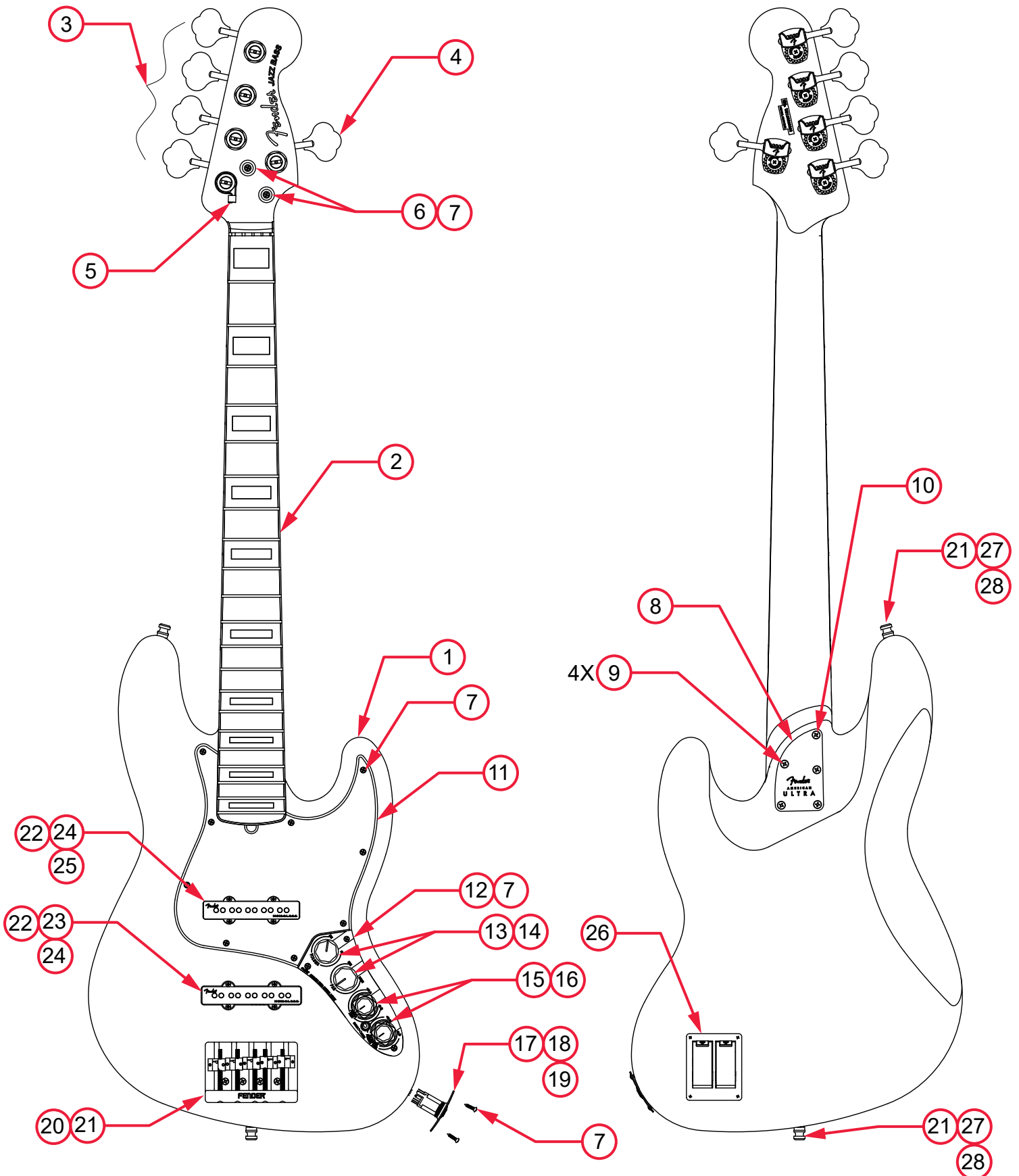

AMERICAN ULTRA JAZZ BASS® V (019903XXXX)

PARTS LIST

REF#	DESCRIPTION	PART NUMBER
1	BODY AM ULTRA J-BASS V ULTRBST	7715609512
1	BODY AM ULTRA J-BASS V MBST	7715609532
1	BODY AM ULTRA J-BASS V AGN	7715610534
1	BODY AM ULTRA J-BASS V PRB	7715610573
1	BODY AM ULTRA J-BASS V ARP	7715608581
2	NECK ASSY ULTRA J-BASS V RW	7715615000
2	NECK ASSY ULTRA J-BASS V MPL	7715614000
3	KEY BASS DLX NEW MOD TAPER SHORT CHROME	7710695000
4	KEY BASS DLX NEW MOD TAPER SHORT CHROME LH	7710696000
5	STRING GUIDE AM DLX BASS "B" STRING CHROME	0078972049
6	STRING GUIDE JAZZ BASS V CHROME	0079013000
7	SCREW SMAB 4 X 1/2 OHP NI	0015578049
8	NECK PLATE AM ULTRA BASS CHROME	7715478000
9	SCREW SMA 8 X 1-3/4 OHP NI	0015636049
10	SCREW SMA 8X 1-1/2 OHP NI	7716272000
11	PICKGUARD AM DLX J-BASS V MG/BLK/MG	7716271000
11	PICKGUARD AM DLX J-BASS V BROWN SHELL	0099878000
11	PICKGUARD AM DLX J-BASS V AGED WHITE PEARL	7716270000
12	CONTROL PLATE AM DLX J-BASS CHR	0078864000
13	PCB ASSY AM ULTRA J-BASS W/HDWR	7716595000
14	KNOBS (2) LARGE SKIRTED BLACK	0019455049
15	KNOB UPPER CONSCENTRIC BLACK	0049411049
16	KNOB LOWER CONSCENTRIC BLACK	0049412049
17	JACK 6.3 OUTPUT	0073618000
18	FERRULE JACK RECESS FOOTBALL CHROME	0050100000
19	WIRE HARNESS OUTPUT 4-PIN 24GA 9.5"	7708984000
20	BRIDGE ASSY FENDER HIGH MASS BASS V NARROW	0099296000
21	SCREW SMAB 5 X 1 OHP NI	0015610049
22	SCREW 4 X 1-1/2 WOOD RD PH NI	0078420000
23	PICKUP ASSY AM ULTRA J-BASS V BRIDGE	7715613000
24	WEATHERSTRIPPING 9/16 X 1/2 OP CL NEOP	0018556049
25	PICKUP ASSY AM ULTRA J-BASS V NECK	7715642000

*= NOT PICTURED IN DIAGRAM



AMERICAN ULTRA JAZZ BASS® V (019903XXXX)

WIRING ASSEMBLY

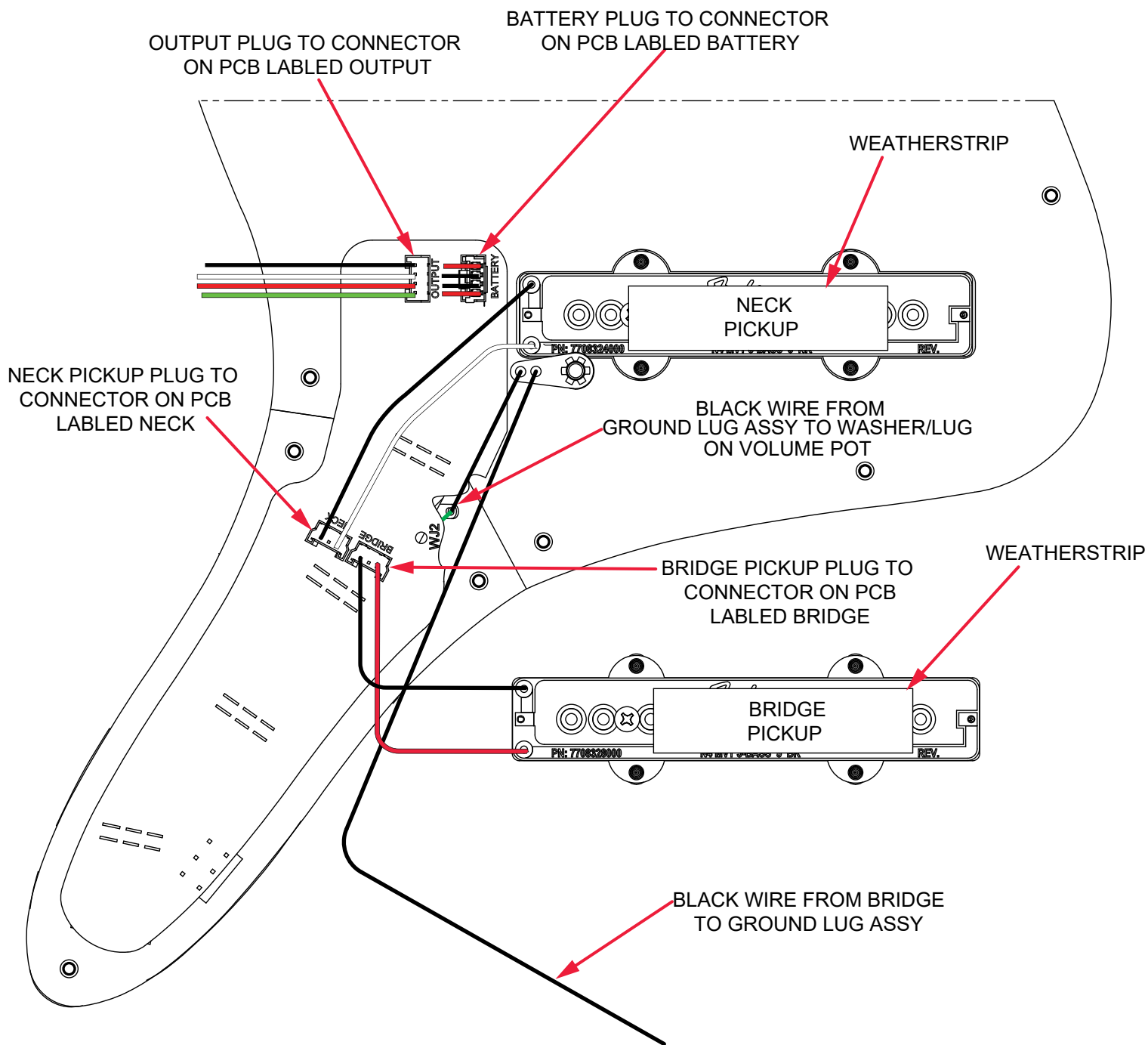

AMERICAN ULTRA JAZZ BASS® V (019903XXXX)

SWITCH AND CONTROL FUNCTION

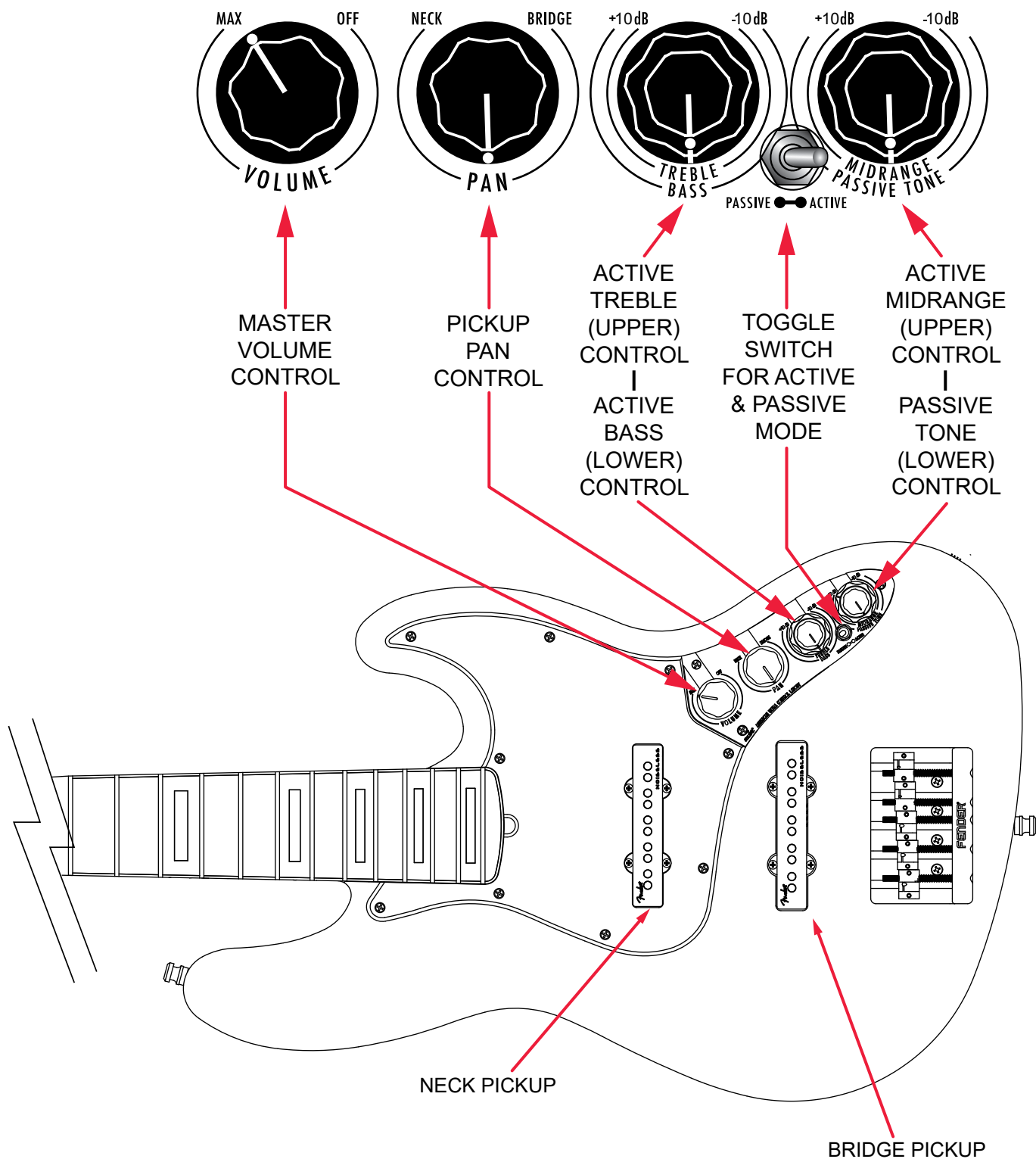

AMERICAN ULTRA JAZZ BASS® V (019903XXXX)

ADDITIONAL SPECIFICATION DETAIL

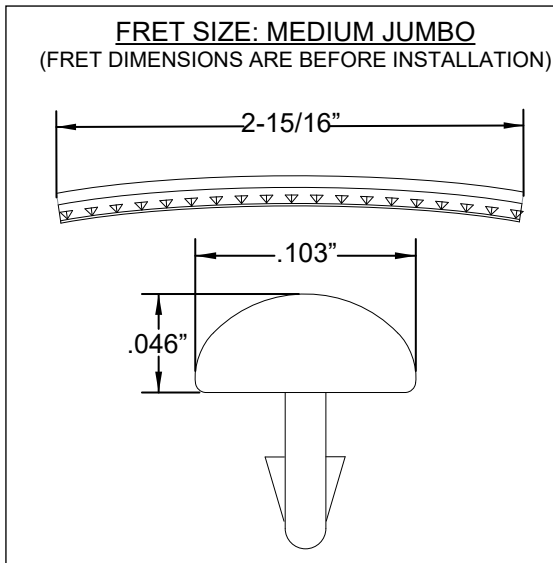

PLEASE NOTE: AS EACH NECK IS SANDED & FINISHED BY HAND, THICKNESS DIMENSIONS MAY VARY SLIGHTLY FROM THOSE SHOWN.

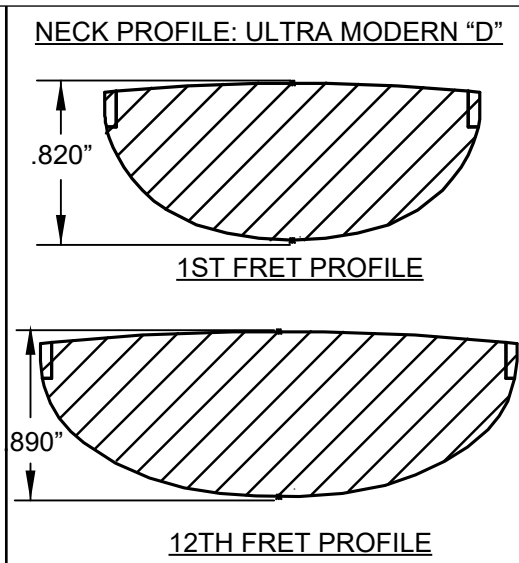

TUNING MACHINE DLX MOD TAPER SHORT: P/N 7710695000
TUNING MACHINE DLX MOD TAPER SHORT LH: P/N 7710696000
OUTER SHAFT DIAMETER .533"

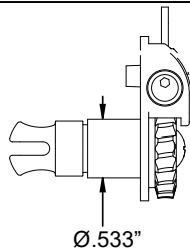

TUNING MACHINE THRU-HOLE
INNER DIAMETER .687"

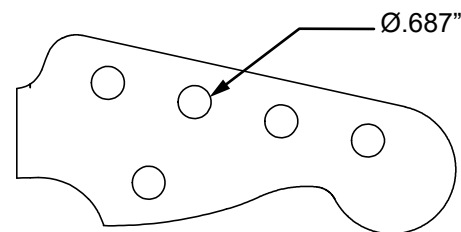

SADDLE HEIGHT ADJUSTMENT WRENCH:
.050" HEX KEY P/N 0018531049

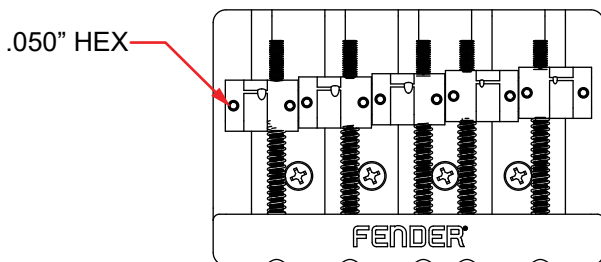

TRUSS ROD NUT: P/N 0048688049
TRUSS ROD ADJUSTMENT WRENCH:
3/16" HEX KEY P/N 7710885000

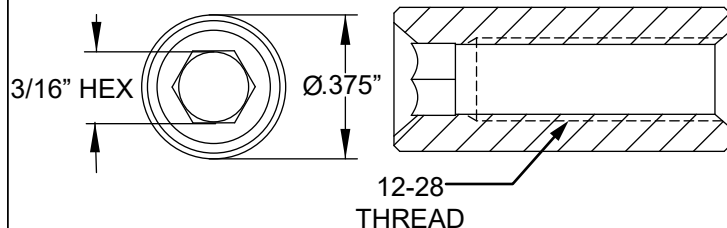

LOGO: AM ULTRA J-BASS V DECAL
APPLIED UNDER THE FINISH



PICKUP SPECIFICATIONS

POSITION	MAGNETS	DC RESISTANCE	POLARITY
NECK	ALNICO 5 UNBEVELED	15.81 - 16.41KΩ	NORTH
BRIDGE	ALNICO 5 UNBEVELED	16.54 - 17.14KΩ	NORTH